

EPOK - Exchange Program Okayama –

Institute of Global Human Resource Development

Okayama University

Japan

EPOK

COURSE CATALOG

2021-2022



Japan.
Committed
to SDGs



OKAYAMA
UNIVERSITY

**SUSTAINABLE
DEVELOPMENT
GOALS**

Okayama University supports the Sustainable Development Goals

Revised 2021 Fall

Table of Contents

1. Academic Calendar
2. General Information
 - Registration, Credits, Grading System
3. Overview of the Academic Affairs system
4. 1st Quarter
 - Timetable of Courses
 - Course Syllabi
5. 2nd Quarter
 - Timetable of Courses
 - Course Syllabi
6. 3rd Quarter
 - Timetable of Courses
 - Course Syllabi
7. 4th Quarter
 - Timetable of Courses
 - Course Syllabi
8. About Japanese Language course
 - Information: Refer to Japanese language Course
9. Registration Forms
10. Campus Maps

NB The courses marked “□” are officially open to undergraduate students at Okayama whose command of English is sufficient.

**For further information please contact:
Institute of Global Human Resource Development
EPOK Academic Advisor:**

Junko OBAYASHI (Associate Professor)
j_obayashi@okayama-u.ac.jp

EPOK Program, Administrative office:

International Student Division
epok-inbound1@adm.okayama-u.ac.jp

2021-2022 EPOK Academic Calendar

Date below are subject to change
*Some courses/events will be provided online

| D | Sun | Mon | Tue | Wed | Thu | Fri | Sat | Remarks | D | Sun | Mon | Tue | Wed | Thu | Fri | Sat | Remarks | |
|----------|-----|-----|-----|-----|-----|-----|----------------------------------|--|-------|-----|-----|-----|-----|-----|----------------------------------|-----|--|-------------------------------|
| April | | | | | 1 | 2 | 3 | By Mar.24 ★JLC* Placement Test (online) 1st ★EPOK Guidance(Online) ★Opening Ceremony by 3rd ★Submit Course Reg.Memo by 7th ·Course Registration(online) 9th ·1st Term Classes Start After ★Arrival Orientation arrival · Health Check-up online ★Campus Life Orien. 29th ·National Holiday 30th ·Thursday classes instead of Friday | Oct | | | | | | | 1 | 2 | 1st · Q3 Classes Start |
| | 4 | 5 | 6 | 7 | 8 | 9 | 10 | | | 3 | 4 | 5 | 6 | 7 | 8 | 9 | | |
| | 11 | 12 | 13 | 14 | 15 | 16 | 17 | | | 10 | 11 | 12 | 13 | 14 | 15 | 16 | | |
| | 18 | 19 | 20 | 21 | 22 | 23 | 24 | | | 17 | 18 | 19 | 20 | 21 | 22 | 23 | | |
| | 25 | 26 | 27 | 28 | 29 | 30 | | | | 24 | 25 | 26 | 27 | 28 | 29 | 30 | | |
| May | | | | | | | 1 | 11th ·National Holiday | Nov | | 1 | 2 | 3 | 4 | 5 | 6 | 1st Wednesday classes instead of Monday 3rd ·National Holiday 5th-7th ·University Festival 23rd ·National Holiday | |
| | 2 | 3 | 4 | 5 | 6 | 7 | 8 | | | 7 | 8 | 9 | 10 | 11 | 12 | 13 | | |
| | 9 | 10 | 11 | 12 | 13 | 14 | 15 | | | 14 | 15 | 16 | 17 | 18 | 19 | 20 | | |
| | 16 | 17 | 18 | 19 | 20 | 21 | 22 | | | 21 | 22 | 23 | 24 | 25 | 26 | 27 | | |
| | 23 | 24 | 25 | 26 | 27 | 28 | 29 | | | 28 | 29 | 30 | | | | | | |
| Jun | | | 1 | 2 | 3 | 4 | 5 | 10th ·Catch-up Day 11th ·2nd Term Classes Start | Dec | | | | 1 | 2 | 3 | 4 | 1st ·Catch-up Day 2nd ·Q4 Classes Start | |
| | 6 | 7 | 8 | 9 | 10 | 11 | 12 | | | 5 | 6 | 7 | 8 | 9 | 10 | 11 | | |
| | 13 | 14 | 15 | 16 | 17 | 18 | 19 | | | 12 | 13 | 14 | 15 | 16 | 17 | 18 | | |
| | 20 | 21 | 22 | 23 | 24 | 25 | 26 | | | 19 | 20 | 21 | 22 | 23 | 24 | 25 | | |
| | 27 | 28 | 29 | 30 | | | | | | 26 | 27 | 28 | 29 | 30 | 31 | | | |
| July | | | | | 1 | 2 | 3 | 19th · Thursday classes instead of Monday 22nd-23rd ·National Holiday | Jan | | | | | | | 1 | 10th ·National Holiday 13th Monday Classes instead of Thursday 14th · No Classes (Entrance Exam) | |
| | 4 | 5 | 6 | 7 | 8 | 9 | 10 | | | 2 | 3 | 4 | 5 | 6 | 7 | 8 | | |
| | 11 | 12 | 13 | 14 | 15 | 16 | 17 | | | 9 | 10 | 11 | 12 | 13 | 14 | 15 | | |
| | 18 | 19 | 20 | 21 | 22 | 23 | 24 | | | 16 | 17 | 18 | 19 | 20 | 21 | 22 | | |
| | 25 | 26 | 27 | 28 | 29 | 30 | 31 | | | 23 | 24 | 25 | 26 | 27 | 28 | 29 | | |
| Aug | 1 | 2 | 3 | 4 | 5 | 6 | 7 | 10th ·Monday Exam instead of Tuesday 8th-9th ·National Holiday TBA ·EPOK Closing Ceremony 11th ·Catch-up Day Aug.12th-Aug.16: Office Closes | Feb | | | 1 | 2 | 3 | 4 | 5 | 9th ·Catch-up Day 11th ·National Holiday 23rd ·National Holiday | |
| | 8 | 9 | 10 | 11 | 12 | 13 | 14 | | | 6 | 7 | 8 | 9 | 10 | 11 | 12 | | |
| | 15 | 16 | 17 | 18 | 19 | 20 | 21 | | | 13 | 14 | 15 | 16 | 17 | 18 | 19 | | |
| | 22 | 23 | 24 | 25 | 26 | 27 | 28 | | | 20 | 21 | 22 | 23 | 24 | 25 | 26 | | |
| | 29 | 30 | 31 | | | | | | | 27 | 28 | | | | | | | |
| Sept | | | | 1 | 2 | 3 | 4 | TBA ★EPOK Guidance(Online) TBA ·Submit Course Reg. memo TBA ★JLC* Placement Test (online) TBA ★Opening Ceremony TBA ·Course Registration(online) After ★Arrival Orientation arrival · Health Check-up online ★Campus Life Orien. 23rd ·National Holiday | March | | | 1 | 2 | 3 | 4 | 5 | | |
| | 5 | 6 | 7 | 8 | 9 | 10 | 11 | | | 6 | 7 | 8 | 9 | 10 | 11 | 12 | | |
| | 12 | 13 | 14 | 15 | 16 | 17 | 18 | | | 13 | 14 | 15 | 16 | 17 | 18 | 19 | | |
| | 19 | 20 | 21 | 22 | 23 | 24 | 25 | | | 20 | 21 | 22 | 23 | 24 | 25 | 26 | | |
| | 26 | 27 | 28 | 29 | 30 | | | | | 27 | 28 | 29 | 30 | 31 | | | | |
| 1st Term | 8 | 8 | 8 | 8 | 8 | 8 | Number of Weeks (Including Exam) | 3rd Term | 8 | 8 | 8 | 8 | 8 | 8 | Number of Weeks (Including Exam) | | | |
| 2nd Term | 8 | 8 | 8 | 8 | 8 | 8 | | 4th Term | 8 | 8 | 8 | 8 | 8 | 8 | | | | |

*JLC : Japanese Language Course **Course Reg. Interview for 2021.4-students, on different date ★For New Coming Students
1st Term 9th April-10th June Holiday/No Classes
2nd Term 11th June-11th August Class of other day of the week to be held
3rd Term 1st October-1st December Catch-up Day for classes cancelled officially by the university
4th Term 2nd December-14th February ※Spring Semester : 1st & 2nd Quarter, Fall Semester : 3rd & 4th Quarter
 Examination period

General Information

● Registration *The registration details to be informed at the EPOK Course Guidance.

1. Minimum coursework required: 10 hours per week (5 credits)
2. The courses listed in the EPOK course catalogue are offered in English.
To check the Syllabi of the courses, visit the link below
<https://kyomu.adm.okayama-u.ac.jp/Portal/Public/Syllabus/SearchMain.aspx>
3. EPOK students can take the courses listed in the EPOK course catalogue.
 - As indicated in the list, some courses have prerequisite and require an approval from the instructor for enrollment. If interested in taking them, you need to contact the instructor via email well in advance before the semester begins. Remember to copy the email to your EPOK academic mentor.
 - Some faculty courses which are not listed on the EPOK course catalogue may be available to EPOK students (under certain conditions including Japanese language proficiency). Read the syllabus well especially the “Open to Other Faculties” section and requisites. If you wish to take the applicable course, contact the EPOK academic mentor well in advance to see if you are eligible and permitted to register in the course.

(See to the Overview of the Academic Affairs system on the page 6)**
4. Submit EPOK Registration Memo by deadline to EPOK academic mentor for an approval before registering online Academic Affairs System**
5. To drop classes, report to the EPOK academic mentor with the Course Drop Report before making a change by yourself online Academic Affairs System *
*After the period, you are not allowed to change your classes.
6. You need to refer to the Japanese Course Catalogue regarding the Japanese Language Course.(See to About Japanese Language Course on the page 53)
7. At the end of your exchange period, “The certificate of Attendance (EPOK)” will be issued. In addition to “The Certificate of Attendance”, “EPOK Certificate of Study Japan” can be obtained if you pursue to fulfill its requirement.
(See to the coursework requirement for EPOK Certificate on the page 5)*
8. If you require special consideration in classes, please provide the relevant medical certification in advance to the EPOK academic mentor for the respective class for discussion.

- **Credits**

1. EPOK regular classes: Once a week (100 min) for 8 weeks = 1 credit
2. Japanese Language Courses are calculated as follows:

| Cre | Week | Frequency | Course |
|-----|------|----------------|---|
| 4 | 8 | 4 times a week | Japanese 1 Japanese 2 Japanese 3 Japanese 4 Japanese 5 Japanese 6 Japanese 7** **courses to be combined |
| 2 | 8 | twice a week | Reading and Writing 1 Reading and Writing 2 |
| 1 | 8 | once a week | others |

For further information, please see 2021-2022 Japanese Course Catalogue.

- **Grading System**

| Grade Classification | Mark (%) | Pass/Fail |
|----------------------|------------|-----------|
| A+ | 90 – 100 % | Pass |
| A | 80 – 89 % | Pass |
| B | 70 – 79 % | Pass |
| C | 60 – 69 % | Pass |
| F | 0 – 59 % | Fail |

● EPOK Certificate (of Study Japan)

In order to obtain EPOK certificate of Study Japan, students must complete the program under the certificate requisite as following:

- Students must earn 15 or more credits per 1&2 Term or 3&4 Term including: EPOK compulsory
 - “EPOK Research Project” courses (I and II) < 2 credit>
 - Minimum 2 credit of the following EPOK elective courses: <2 credit or more>
 - Minimum 4 credit of Japanese language course: < 4 credit or more >
 - Additional 7 credit should be taken either from EPOK elective or Japanese language or others.

- A full-year student who pursues a certificate must fulfil the requirement in both semesters (including minimum 15 each semester) except for the EPOK project of total 2-credit.

<6-month (1 semester) course>

| Course Subject/Category | | Credit Required |
|----------------------------------|--|-----------------------|
| Japanese Language | | 4 Credit minimum |
| EPOK Elective | EPOK Recommended Courses (including Study of Japan) | } 2 Credit minimum |
| | Others | |
| EPOK Research Project (I and II) | | 2 |
| Required Total Credit | | 15 |

“EPOK Recommended Courses” include the courses offered by Institute of Global Human Resource Development, Global Discovery Program, Language Education (Japanese, English), and General Education courses, listed on the EPOK Course Catalogue.

“Others” includes the courses in General Education and Faculties, which are not listed in the catalogue.

<1year (2 semester) course>

*Must fulfill the requirement both in Spring and Fall semesters.

| Course Subject/Category | | Credit Required |
|----------------------------------|--|-----------------------|
| Japanese Language | | 8 Credit minimum |
| EPOK Elective | EPOK Recommended Courses (including Study of Japan) | } 4 Credit minimum |
| | Others | |
| EPOK Research Project (I and II) | | 2 |
| Required Total Credit | | 30 |

* For 1-year student: the 2 credit of EPOK Research Project (I and II) can be pursued either in Spring or Fall.

Overview of the Academic Affairs System

Overview of the Academic Affairs System



The Academic Affairs System is designed to support various procedures that are vital to your campus life (i.e. academic affairs) such as registering courses, viewing academic performance, and issuing certificates. An Okadai ID is required to use the system. (The Center for Information Technology and Management will assign each student with an ID at the time of admission.)

- * An Okadai ID is required to access various information services on campus. Please memorize your ID and password and do not share them with anyone else.
- * Automatic certificate issuing machines are installed at the following locations:
Tsushima Campus: the Building for General Education, Peach Union.
Shikata Campus: on the 1st floor of the Administration building.

Academic Affairs System

- Course schedule
- Syllabus
- Register courses (This page can only be accessed during the registration period.)
- Check the number of credits earned
- Student information
- Receive results of regular medical checkups
- Register/delete information about your extracurricular activity groups

Relevant systems

- Moodle (Learning Management System)
- Lot registration

Supported browsers

- Microsoft Edge
- Mozilla Firefox
- Google Chrome
- Safari
- Internet Explorer 11.0

Access Hours

Available 24 hours.

(Except for the year-end and New Year holidays and maintenance days)

Certificate issuing machines

- Certificates that can be printed: student discount certificate, enrollment certificate, expected graduation certificate, academic performance certificate, medical checkup certificate, etc.

Use of PCs, etc. on campus

Students can use PCs, printers, and other equipment for educational purposes in the Computer Room (when the room is not being used for classes, etc.). Students can also access the campus network via wireless LAN access points (which are provided at various locations on campus) using devices such as laptops.

For more details, refer to the webpage below:

Website of the Center for Information Technology and Management, Okayama University
Using the Computer Rooms (for students):

http://www.okayama-u.ac.jp/user/citm/limiting/eng/about/using_students.html

How to Use the Academic Affairs System



1. Log in to a school computer

EPOKs Can skip this part. This is only for those using on campus PC
Please go to next Page, How to access the Academic Affairs System

- 1 Turn on the PC. After a while, the desktop screen will appear. The “PCセットアップ (PC setup)” window pops up automatically.

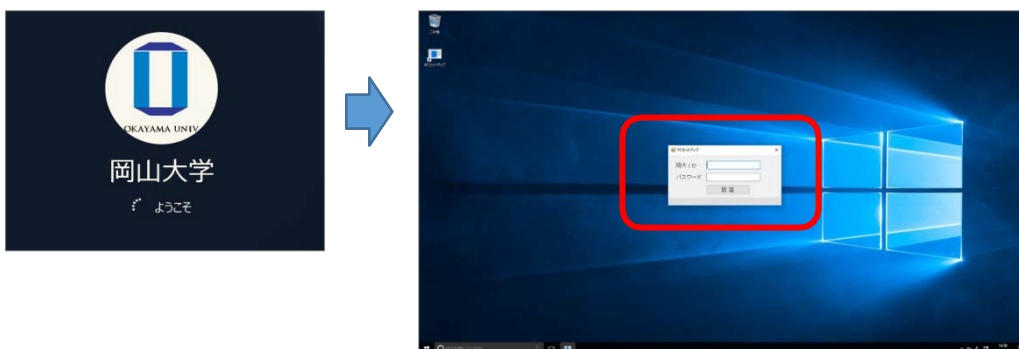

- 2 Enter your Okadai ID and password (indicated in the “パスワード通知書 [Notification of Your Password]”) in the boxes of the popup window, and click the 認証 (Confirm) button.

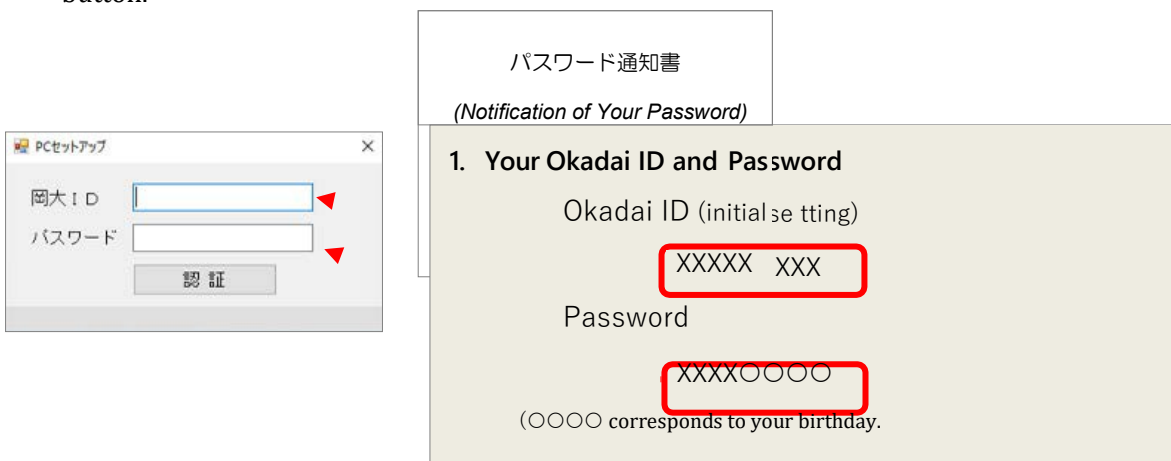

* A default password (assigned by the university) will be provided in the “パスワード通知書 (Notification of Your Password)” for initial setup. However, you must change the password as soon as possible, as the default password will only work for a limited time.

To change the password, follow the steps below.

- How to change the Okadai ID / password
http://www.okayama-u.ac.jp/user/citm/limiting/eng/service/man_stu_eng.pdf
- Integrated authentication system
<http://www.okayama-u.ac.jp/user/citm/limiting/eng/service/ias-student.html>
- For inquiries about the Okadai ID and password, contact:
User information desk for the Center for Information Technology and Management
Phone: +81-86-251-7232 or -7236

2. How to access the Academic Affairs System

Portal site

U R L : <https://kyomu.adm.okayama-u.ac.jp/portal/>

※ Note that the above link is the same for students, instructors, and administration staff.



How to access the Academic Affairs System from the university's homepage

- 1 Open the web browser and access the Okayama University official website. Click on "Current students", which is displayed on the top menu.

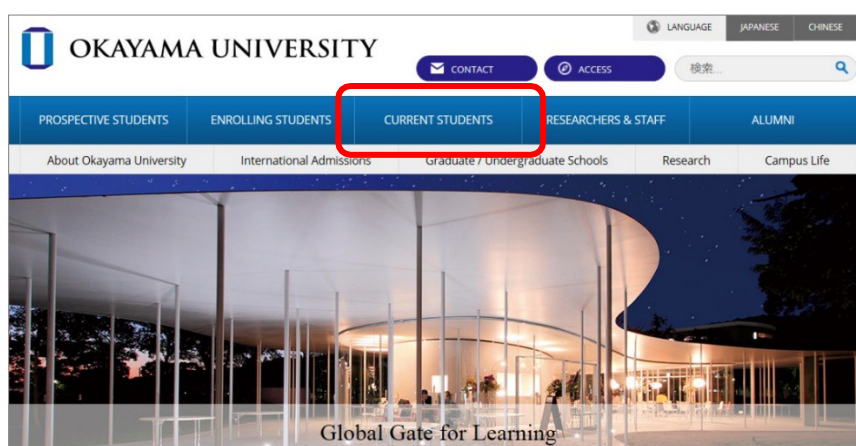

Okayama University official website: https://www.okayama-u.ac.jp/index_e.html

- 2 From the menu on the right-hand side of the screen, click on "Academic Affairs System".

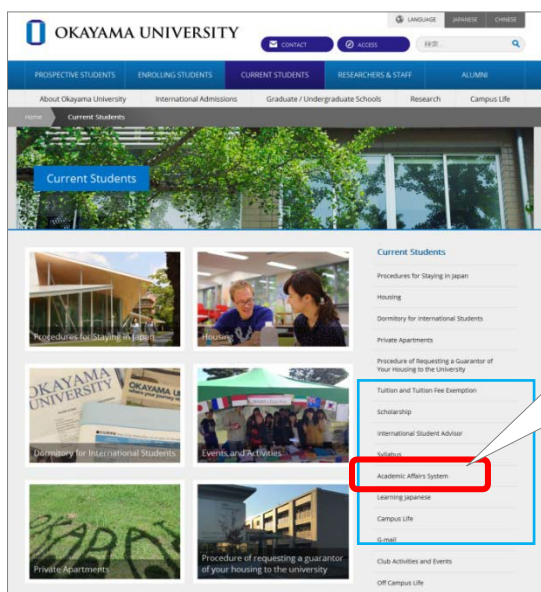

Close-up

Tuition and Tuition Fee Exemption

Scholarship

International Student Advisor

Syllabus

Academic Affairs System

Learning Japanese

Campus Life

G-mail

- 3 An integrated authentication system is used to log in to the Academic Affairs System.
To access the system, click on “学務情報システム”when viewing the Japanese version, or refer to the English version and click on “Academic Affairs System”.

システムの切替について (2020.7.1)

2020/9/3 13:00更新

学生のみなさんへ

[Click here for English Version](#)

現在の学務システムから、抽選・シラバス機能を統合した新しい「学務情報システム」へ、システムの切替を実施します。

運用開始：2020年7月1日 12:00～

[学務情報システム](#)

上のボタンをクリックして、ログインしてください。
<https://kyomu.adm.okayama-u.ac.jp/portal/>

Change to the new system on July 1st.

Last Update:2020/9/3

[Click here for Japanese Version](#)

To Current Students

We will move to a new Academic Affairs system that is convenient for students and faculty.

Start date: July 1, 2020

[Academic Affairs system](#)

URL: <https://kyomu.adm.okayama-u.ac.jp/portal/>

Due to system changing, various registration and application procedures will be significantly changed. Details will be posted below, so please check carefully.

- 4 Enter your Okadai ID and password and click the [Login](#) button.

The screenshot shows the login page for the Academic Affairs System. At the top left is the Okayama University logo and name. Below it is the title "統合認証システムログイン". There are two input fields: "岡大ID" (Okadai ID) and "パスワード" (Password). A "Login" button is located at the bottom left. A red box highlights the "Login" button, and another red box highlights the two input fields. At the bottom, there are two lines of Japanese text: "※共用パソコンの利用後はログアウトのためブラウザを完全に終了させてください。" and "※パスワードが不明の場合はこちらをご覧ください。"

Enter your Okadai ID and password in the “岡大ID (Okadai ID)” and “パスワード (Password)” boxes.

- ※ When accessing the Academic Affairs System off-campus, you are recommended to use a two-step authentication process with a one-time password. For more information, please refer to the following link from the Center for Information Technology and Management:

<http://www.okayama-u.ac.jp/user/citm/limiting/eng/service/ias-student.html>

- 5 After logging in, you should be able to view your personal homepage.

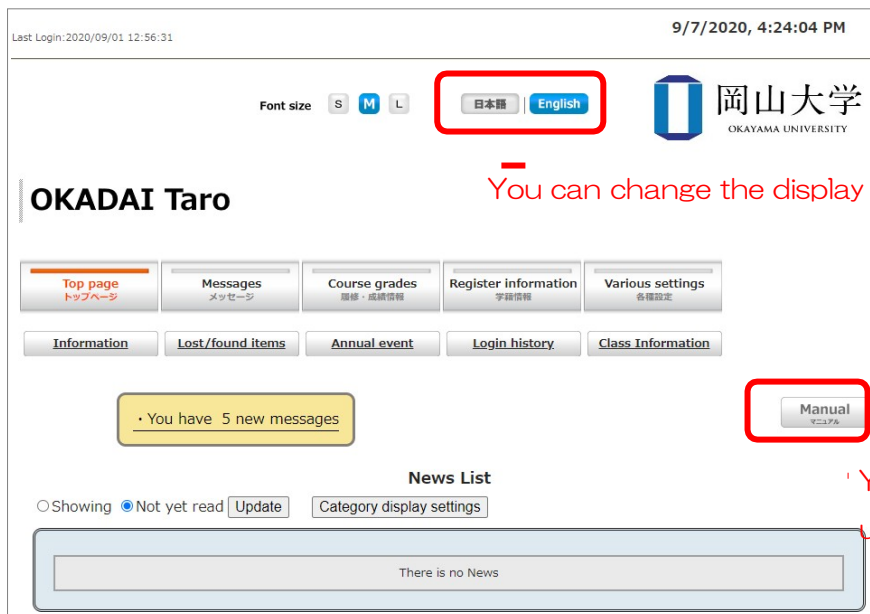

- * Your log-in information will be stored until all the tabs on your browser have been closed.
- * When using a public PC that is accessible to multiple users, be sure to close all browsers at the end of your session.

Register for Courses Online

Register for the courses of your choice using the online registration system:

The registration process is divided into two periods; namely the Course Registration Period, where you can add and drop courses, and the Course Modification Period, where you can only drop courses. Details regarding the duration of each period will be announced separately by each department and may differ slightly. Additionally, there may be some courses that students are not able to register for online by themselves, so please pay close attention to the notices displayed on the Academic Affairs System.

1. Course Registration Screen

- 1 From the top menu, select "Course Grades" >> "Course Registration".





2 The course registration screen will appear.

From the pull-down menu, select the relevant term to display

Term currently being displayed

Courses with a fixed day and time are displayed here

Courses without a fixed day and time are displayed here

| | Mon | Tue | Wed | Thu | Fri | Sat |
|-----------------|-----|-----|-----|-----|-----|-----|
| 1 | Add | Add | Add | Add | Add | Add |
| 2 | Add | Add | Add | Add | Add | Add |
| Intensive, etc. | Add | Add | Add | Add | Add | Add |
| Intensive, etc. | Add | Add | Add | Add | Add | Add |
| Intensive, etc. | Add | Add | Add | Add | Add | Add |

Top page > Course grades > Course registration

2. How to register for courses

There are 3 ways to register for courses.
It does not matter which method you choose.

- ① Register using the course schedule (click the “add” button on the timetable display page)
- ② Register using the Class Schedule Search
- ③ Register by directly entering the course code (4 digits for the year + 6 digits for the lecture number)

3rd Term

① Enter a class schedule format [Enter a list format](#) Page for printing

② Class schedule search Direct input of code ③

Select “list format” to display the information in table form.

3rd Term

[Enter a class schedule format](#) Enter a list format Page for printing

Class schedule search Direct input of code

| Request subjects | | | | | | | | |
|-----------------------------|---------------------|--|------------|--------------|---------|--------------------|--------|------|
| Faculty name | Class schedule code | Subject title | Staff name | Period | Credits | Compulsory subject | Delete | Note |
| 1 General Education courses | 2020911447 | Scientific investigation of human beings | Staff name | Mon.1, Mon.2 | 1 | | Delete | |

① Register using the course schedule

- 1 After confirming the day and time of the desired course, click the “add” button in the corresponding time period.

3rd Term

Enter a class schedule format [Enter a list format](#)

Click 'Add' to display the schedule

[Move to the intensive course](#)

| | Mon | Tue | We |
|---|-----|-----|----|
| 1 | Add | Add | |
| 2 | | | |

2 A new window will open displaying all of the courses offered for that time period (this includes all courses that you are able to register for according to the scope of your curriculum).

※ Even if a certain course is not counted towards graduation requirement, it might be displayed.

Click the “add” button for the course you wish to register.

You can click on these tabs to change the display

| ① General Education ② Own department own course ③ Teaching curator ④ Other Department of other courses | | | | | | | | | | |
|--|---------------------------|---------------------|--|-----------------|------------------------------------|-------------------|----------------|----------|-------------|-------|
| Mon 1 · 2Period | | | | | | | | | | |
| | Faculty name | Class schedule code | Subject title | Instructor name | | Number of credits | Select Section | Capacity | Registrants | Notes |
| 1 | General Education courses | 2020911447 | Scientific Investigation of human beings | Staff name | <input type="button" value="Add"/> | 1 | | 50 | | |
| 2 | General Education courses | 2020911459 | English Communication: Healthy & Sustainable Societies 1 | Staff name | <input type="button" value="Add"/> | 1 | | 50 | | |
| 3 | General Education courses | 2020911739 | Physics for General Education (Mechanics) 1 | Staff name | <input type="button" value="Add"/> | 1 | | 50 | | |
| 4 | General Education courses | 2020912227 | Introduction to Information Processing 3 | Staff name | <input type="button" value="Add"/> | 1 | | 50 | | |

Click on the name of a course to see its syllabus.

| | | |
|---|--------------------------------|--|
| ① | General education | General education subjects in the curriculum |
| ② | Courses from own department | Specialized education subjects in the curriculum |
| ③ | Teaching | Applicable to the education department’s teaching course |
| ④ | Courses from other departments | Courses that fall outside the curriculum but are open for registration |

3 Once registration has been confirmed by the Academic Affairs Department, the course will be displayed in the timetable as follows:

3rd Term ▼

Enter a class schedule format [Enter a list format](#)

Click 'Add' to display the schedule

[↓ Move to the intensive course](#)

| | Mon | Tue | We |
|--|---|-----|----|
| | 2020911447 1 credit 3rd Term [Life] Scientific investigation of human beings Staff name <input type="button" value="Delete"/> | | |

- 4 If an error occurs, it will be displayed as follows, so please check the syllabus to confirm registration requirements. If you cannot understand the cause of an error, please send an inquiry to the Academic Affairs Department of your faculty.

| | | | |
|--|------------------------------|---------------------|--------------------------------------|
| General Education | Own department own course | Teaching curator | Other Department of other courses |
| Class schedule code : 2020911447 Subject title : Scientific investigation of human beings DOUBLE:すでに登録済です | | | |

Types of errors (example)

| Error message | Reason/ Appropriate response |
|---|---|
| You have reached the maximum credits for this term. | If you exceed the credit cap (this varies according to Faculty), the registered course/timetable must be deleted. |
| You have already registered for this course. | The course number has already been registered. |
| Duplicate course registration. | You have already earned credits for this course and it cannot be taken again. The course must be deleted. |
| You do not meet the prerequisites for this course. | You cannot take the course because registration is restricted to students from certain faculties/departments. Please check the syllabus, etc. |
| You do not meet the prerequisites for this course. | You have not taken the necessary courses/earned the necessary credits to take the course. Please check the syllabus, etc. |
| Error not related to the curriculum | Please contact the Academic Affairs Department of your faculty. |
| Outside of Course Registration Period | It is not currently the registration period for this course/term. |

② Register using the Class Schedule Search

After clicking on “Class Schedule Search”, a new window will open displaying the advanced search box shown below. You can search for a class using any of the following fields: Faculty, Department, Day of week, Period, Subject title, and Instructor.

Find class schedule. Enter your search criteria and press the Search button.

| | |
|---------------|---|
| Faculty | <input type="text" value="Faculty of Letters[01]"/> |
| Department | <input type="text"/> |
| Day of week | <input type="text" value="Mon."/> |
| Period | <input type="text"/> |
| Subject title | <input type="text"/> |
| Instructor | <input type="text"/> |

③ Register by directly entering the course code

After clicking on “*direct input of code*”, a new window will open, as shown below. In the space provided, enter the relevant course code. (Please note that you should look up the course code in advance.)

Course code: 4 digits for the year + 6 digits for the lecture number

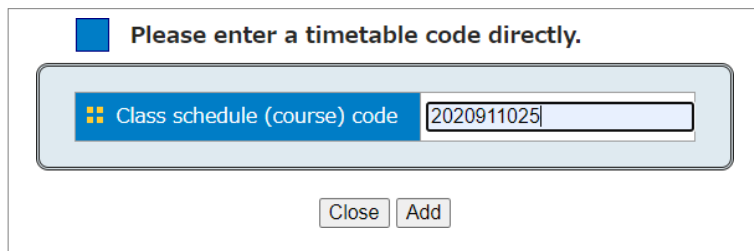

Please enter a timetable code directly.

Class schedule (course) code

Close Add

3. How to drop a course

In order to drop a course, click the “*delete*” button displayed on the timetable. In principal, students should be able to drop any course during the Course Registration Period and Course Modification Period; however, there may be some courses that students are not able to drop by themselves. For example, courses registered by instructors or administration staff.

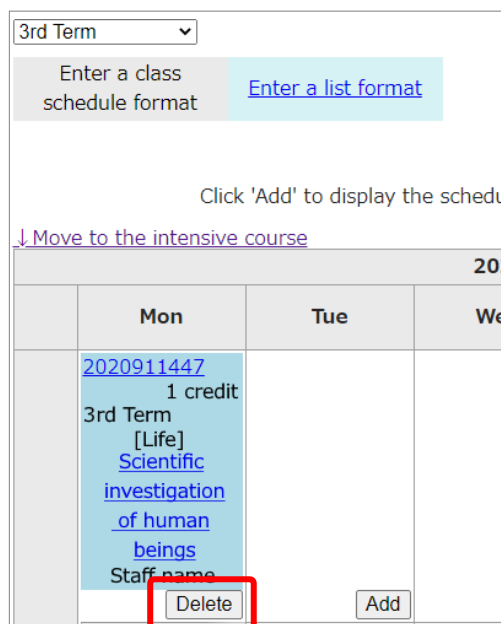

3rd Term

Enter a class schedule format [Enter a list format](#)

Click 'Add' to display the schedule

[↓ Move to the intensive course](#)

| | Mon | Tue | We |
|--|--|-----|----|
| | 2020911447 1 credit 3rd Term [Life] Scientific investigation of human beings Staff name | | |

Delete Add

Course Timetable and Schedule



1. Course Timetable

You can see the registered courses for each term by accessing your course schedule.

- 1 From the top menu, select “Course Grades” » “Course schedule”.

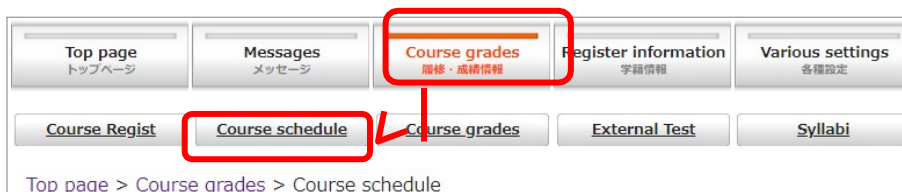

- 2 You will be redirected to your course timetable. From the pull-down menu, select the relevant school term. (Initially, nothing is displayed, so please specify the term.)

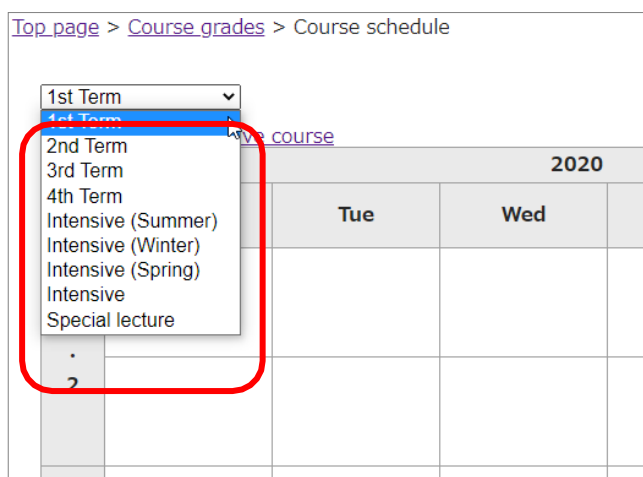

- 3 When looking at your timetable, you will notice that the course code as well as the course name for all the courses are highlighted. If you click on the course code, you will be able to view the course syllabus. If you click on the course name, you will be redirected to the Moodle page for that course.

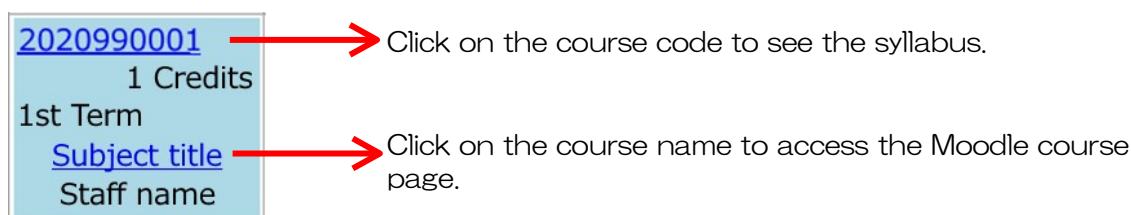

Background colors on the timetable and what they mean:

| | | | | | |
|--|-----------------|--|---|------------|--|
| <p>2020990001 1 Credits 1st Term Subject title Staff name</p> | Pale blue | General Education courses | <p>2020990001 1 Credits 1st Term Subject title Staff name</p> | Yellow | Subjects from different departments and faculties |
| <p>2020990001 1 Credits 1st Term Subject title Staff name</p> | Yellowish green | Major (<i>Senmon</i>) (own department/major) | <p>2020990001 1 Credits 1st Term Subject title Staff name</p> | Light blue | Special permission subjects (the instructor has granted permission for the student to register for this subject) |
| <p>2020990001 1 Credits 1st Term Subject title Staff name error contents</p> | Red | Registration Error (requires correction) | | | |

2. Schedule

You can see your schedule from the top page.

When you click on the course code of a particular course on the schedule table, you will be able to see the details of that course. Click on the course name to access the Moodle course page.

Adding a Schedule

Weekly Month

2020/07/06

| Schedule table | | | | | | | |
|----------------|---|-----------|---|---|------------|------------|------------|
| | 7/6 (Mon) | 7/7 (Tue) | 7/8 (Wed) | 7/9 (Thu) | 7/10 (Fri) | 7/11 (Sat) | 7/12 (Sun) |
| 08:00 | | | | | | | |
| 09:00 | <p>2020091211 1 Electronic Circuits</p> | | <p>2020091285 1 Thermodynamics I</p> | <p>2020091271 1 Vector and Complex Analyses</p> | | | |
| 10:00 | <p>2020091211 2 Electronic Circuits</p> | | <p>2020091285 2 Thermodynamics I</p> | <p>2020091271 2 Vector and Complex Analyses</p> | | | |
| 11:00 | <p>2020091271 3 Vector and Complex Analyses</p> | | <p>2020091217 3 Partial Differential Equation</p> | <p>2020091211 3 Electronic Circuits</p> | | | |

Click on the course name to access the Moodle course page.

Click on the course code to see the course details.



The university provides information to students via notices on physical bulletin boards, the school website, and Moodle. To supplement such information, the university provides information by sending emails to Gmail addresses assigned by the university ("Gmail") about notices (including advance notices) of lecture cancellations due to weather warnings, important matters related to academic affairs, and other emergency notices, etc.

Gmail is used to give the following notices. Please make sure to check your Gmail inbox consistently by auto-forwarding the messages from Gmail to your mobile phone, etc.

Gmail messages provide an outline of notices put up on the bulletin boards, etc. Students must check the full details on the bulletin boards and website.

- ☆ Main Gmail messages from the university
- (1) Notices about course registration, academic performance reports, etc. on the Academic Affairs System
- (2) Notices (including advance notices) of lecture cancellations due to weather warnings
- (3) Notices about infectious diseases (e.g. influenza) and recommendations to prevent spread of infection
- (4) Notices regarding restrictions of access to campus due to entrance examinations, etc.
- (5) Notices about seminars and events
- (6) Other notices about matters that affect all students

- How to use Okayama University Gmail
http://www.okayama-u.ac.jp/user/citm/limiting/eng/service/gmail_home.html

- Inquiries about the overall system for academic affairs
Academic Affairs Information System Development Office, Academic Affairs Department
ddg7059@adm.okayama-u.ac.jp Phone: +81-86-251-7058, -7059
- Okayama University Moodle Moodle support
moodle@okayama-u.ac.jp
- Application for courses whose students are chosen by lot and lot system
Staff in charge of liberal arts, Education Support Group, Academic Affairs Planning Division,
Academic Affairs Department
dah8433@adm.okayama-u.ac.jp Phone: +81-86-251-8433, -8434
- Use of the Integrated Authentication System (Okadai ID), Gmail, PCs on campus Information desk for users, Center for Information Technology and Management
ask@okayama-u.ac.jp Phone: +81-86-251-7232, -7236

1st Term

Course List for EPOK 2021-2022 1st Term

※All information listed is subject to change

| Term | Class Code | Classes | Timetable | | Credits | Language J:Japanese E:English | Online | In-person | Lecturer(s) | ★ Approval necessary |
|------|------------|---|-----------|-----------|---------|-------------------------------------|--------|-----------|--|-------------------------|
| 1 | 672001 | Study of Japan A with SDGs | Wed | 5-6-7-8 | 1 | J | ○ | | OBAYASHI Junko | |
| 1 | 671501 | EPOK Research Project: Spring I | TBA | TBA | 1 | E | ○ | | IGHRAD Academic Staff | |
| 1 | 133041 | Glass Science for Resource Recycling | Mon | 1-2 | 1 | E | TBA | | BENINO Yasuhiko | ★ |
| 1 | 919051 | Environment and Geography | Mon & Thu | 3 1-2 | 1.5 | J (Advanced level) | X | ○ | KIM Doo-Chul, and others | ★ |
| 1 | 911459 | English Communication: Healthy & Sustainable Societies 1 | Mon | 3-4 | 1 | E | TBA | | RUCYNSKI John Edward | |
| 1 | 132004 | Urban Sociology | Mon & Thu | 5-6 | 2 | E | TBA | | MIYAGAWA Haruna | ★ |
| 1 | 131078 | Laboratory in Water Management | Mon & Thu | 5-6-7 | 1 | E | TBA | | KUDO Ryoji and others | ★ |
| 1 | 673121 | Intercultural Communication I | Mon | 7 | 0.5 | E | TBA | | NAKAMURA Ian Iseo | |
| 1 | 131081 | Fundamentals of Mathematics | Mon | 7-8 | 1 | E | TBA | | TANG Jian | |
| 1 | 911081 | Japanese Agriculture and Rural Society | Mon | 7-8 | 1 | E | ○ | | INAMORI Takao | |
| 1 | 131078 | Culture and Illness | Mon & Thu | 7-8 | 2 | E | TBA | | UESUGI Takeshi | ★ |
| 1 | 133045 | Environmental Issues and Recycling Processes of Resources | Tue & Thu | 3-4 / 7-8 | 2 | E | TBA | | MATSUI Yasuhiro , NISHIYAMA Satoshi | |
| 1 | 912709 | Seminar of Sport Performance(Tennis) | Tue | 5-6 | 1 | E&J | TBA | | KOBAYASHI Yuji, | ★ |
| 1 | 132028 | Introduction to Applied Plant Science I | Tue | 5-6 | 1 | E | TBA | | KUBOYoshihiko and others | ★ |
| 1 | 673154 | Movie Analysis: Topics and Tasks | Tue | 5-6 | 1 | E | TBA | | MEIKI Susan Mary | |
| 1 | 134022 | Laboratory in Environmental Biology | Tue & Fri | 5-6-7 | 1 | E | TBA | | NAKAJIMA Yoshitaka , NAKATA Kazuyoshi | |
| 1 | 911082 | Comparative Education as Social Science I | Tue | 7-8 | 1 | E | ○ | | KAMBARA Nobuyuki | |
| 1 | 133036 | Heat and Mass Balances | Tue | 7-8 | 1 | E | TBA | | KIMURA Yukitaka | ★ |
| 1 | 133085 | Agrochemical Bioscience 2 - Biological Chemistry | Wed | 3-4 | 1 | E | TBA | | KANAO Tadayoshi and others | ★ |

| | | | | | | | | | | |
|----------------|--------|---|-----------------|-------|-----|-----|-----|---|--------------------------------|---|
| 1 | 132023 | Introduction to Environmental Chemistry | Thu | 1-2 | 1 | E | TBA | | KIMURA Kunio , NANBA Tokuro | ★ |
| 1 | 132024 | Civil Engineering I | Thu | 2-3 | 1 | E | TBA | | KIMOTO Kazushi and others | ★ |
| 1 | 911084 | An Exploration of Chanoyu: Ethnography of Art, Mind and History | Thu | 5-6 | 1 | E&J | ○ | | OBAYASHI Junko | |
| 1 | 131087 | Instrumental Analysis | Thu | 5-6 | 1 | E | TBA | | UDDIN Azhar | ★ |
| 1 | 673113 | Foreign Perspectives of Japan through Documentaries | Thu | 7-8 | 1 | E | TBA | | Rucynski John Edward | |
| 1 | 131083 | Fundamentals of Physics II | Thu | 7-8 | 1 | E | TBA | | TANG Jian | |
| 1 | 911111 | Japan in the Age of Globalization 2 | Fri | 3-4 | 1 | E | TBA | | KIM Dong Kwang | ★ |
| 1 | 911085 | Introduction to Japanology | Fri | 5-6 | 1 | E | ○ | | KAMBARA Nobuyuki | |
| 1 | 132029 | Introduction to Applied Plant Science II | Fri | 5-6 | 1 | E | TBA | | YOSHIDA Yuichi and others | ★ |
| 1 | 912036 | Servant Leadership 1 | Fri | 5-6 | 1 | E | ○ | | ISHIDA Mamoru | |
| 1 | 131073 | Introduction to Japanese Politics | Fri | 5-6 | 1.5 | E | TBA | | OSAWA Kimiko | |
| 1 | 131049 | Chemistry for Chemical Engineering | Fri | 5-6-7 | 1.5 | E | TBA | | UDDIN Azhar | ★ |
| 1 | 131066 | Topics in Management I | Fri | 7-8 | 1.5 | E | TBA | | GONG Yuan Yuan | |
| 1 | 673141 | Model United Nations Preparation Class | Fri | 7-8 | 1 | E | TBA | | FUJISHIMA Naomi | |
| 1 Intensive | 912006 | Field Work : Participation in Japanese Traditional Ritual Festival | Intensive | | 1 | E&J | X | ○ | FUJIMOTO Masumi and others, | ★ |
| 1 & 2 | 133064 | Introduction to Feminist Economics | Tue | 5-6 | 2 | E | TBA | | YAMAMOTO Yumiko | |
| 1 & 2 | 132066 | Fundamentals of Molecular Spectroscopy | Tue | 5-6 | 2 | E | TBA | | TANG Jian | |
| 1 & 2 | 133082 | Anthropology of the Self | Tue & Fri | 3-4 | 4 | E | TBA | | UESUGI Takeshi | ★ |
| 1 & 2 | 132056 | International Economics | Thu | 3-4 | 2 | E | TBA | | YAMAMOTO Yumiko | |
| 1 & 2 | 133068 | Topics in Political Science I | Fri | 1-2 | 2 | E | TBA | | OSAWA Kimiko | |
| 1 & 2 | 132049 | Topics in Management V | Fri | 5-6 | 2 | E | TBA | | GONG Yuan Yuan | |
| 1 & 2 | 132051 | Topics in Management VII | Fri | 9-10 | 2 | E | TBA | | GONG Yuan Yuan | |

Japanese Language Courses

※Check Japanese Language Course Catalog for details

| Term | Class Code | Classes | Timetable | Credits | Language | Online | In-person | Lecturer(s) | |
|------|------------|---|------------------------------|---------|----------|--------|-----------|--------------------|------------------|
| 1 | 917017 | Japanese1-1 (Placement Test Score 0-30) | Mon, Tue, Wed, Thu | 1-2 | 4 | J | ○ | Exam (Possibly) | SUESHIGE Miwa |
| 1 | 917025 | Japanese2-1 (A) (Placement Test Score 31-47) | Tue, Wed, Thu, Fri | 1-2 | 4 | J | ○ | Exam (Possibly) | SATO Miho |
| 1 | 917026 | Japanese2-1 (B) (Placement Test Score 31-47) | Mon, Tue, Wed, Thu | 1-2 | 4 | J | ○ | Exam (Possibly) | NAGANO Masumi |
| 1 | 917033 | Japanese3-1 (A) (Placement Test Score 48-58) | Mon, Tue, Thu, Fri | 3-4 | 4 | J | ○ | | GOTO Naomi |
| 1 | 917034 | Japanese3-1 (B) (Placement Test Score 48-58) | Mon, Wed, Thu, Fri | 3-4 | 4 | J | ○ | | OHTA Saeko |
| 1 | 917041 | Japanese4-1 (Placement Test Score 59-68) | Tue, Wed, Thu, Fri | 3-4 | 4 | J | ○ | Exam | MORIYA Tomomi |
| 1 | 917045 | Japanese5-1 (Placement Test Score 69-74) | Mon, Tue, Wed, Thu, | 1-2 | 4 | J | ○ | | UCHIMARU Yukako |
| 1 | 917049 | Japanese6-1 (Placement Test Score 75-82) | Mon, Tue, Thu, Fri | 1-2 | 4 | J | ○ | Exam (Possibly) | AOI Yuka |
| 1 | 917001 | Applied Japanese (Listening A) (Placement Test Score 83-100) | Thu | 3-4 | 1 | J | ○ | Exam (Possibly) | NAGANO Masumi |
| 1 | 917005 | Applied Japanese (Writing B) (Placement Test Score 83-100) | Tue | 3-4 | 1 | J | ○ | Exam | MORIYA Tomomi |
| 1 | 917009 | Applied Japanese (Speaking B) (Placement Test Score 83-100) | Fri | 1-2 | 1 | J | ○ | | UCHIMARU Yukako |
| 1 | 917013 | Applied Japanese (Reading A) (Placement Test Score 83-100) | Mon | 3-4 | 1 | J | ○ | Exam (Possibly) | SUESHIGE Miwa |
| 1 | 917053 | Japanese through Films 1-1 (Placement Test Score 48-68) | Fri | 5-6 | 1 | J | ○ | Exam (Possibly) | AKITA Setsuko |
| 1 | 917057 | Japanese through Films 2-1 (Placement Test Score 69-100) | Fri | 3-4 | 1 | J | ○ | Exam (Possibly) | AKITA Setsuko |
| 1 | 917067 | Extensive Reading 2-1 (Placement Test Score 75-100) | Fri | 5-6 | 1 | J | ○ | Exam (Possibly) | OHTA Saeko |
| 1 | 917071 | Intermediate Kanji and Vocabulary (Placement Test Score 59-74) | Mon | 3-4 | 1 | J | ○ | Exam (Possibly) | AOI Yuka |
| 1 | 917075 | Intermediate Grammar 1-1 (Placement Test Score 48-68) | Tue | 5-6 | 1 | J | ○ | Exam (Possibly) | AOI Yuka |
| 1 | 917079 | Intermediate Grammar 2-1 (Placement Test Score 69-100) | Thu | 5-6 | 1 | J | ○ | Exam | MORIYA Tomomi |
| 1 | 917083 | Japanese Culture and Society (Placement Test Score 69-100) | Tue | 5-6 | 1 | J | ○ | Exam (Possibly) | KANEMITSU Noriko |
| 1 | 917087 | Reading and Writing 1-1 (Placement Test Score 0-47) | Mon & Thu | 5-6 | 2 | J | ○ | Exam (Possibly) | UMEKAWA Yuko |
| 1 | 917093 | Reading and Writing 2-1 (Placement Test Score 31-58) | Tue & Thu | 5-6 | 2 | J | X | ○ | USHIDA Eiko |

2021-2022 EPOK Timetable of Course 1st Term

| | | Monday | | | Tuesday | | | Wednesday | | | Thursday | | | Friday | | | | | |
|--|------------------------------------|------------------------------------|---------------|-------------------------------|---------------|---------------|---------------|---------------|-------------------------------|---------------|---------------|---------------|---------------|---------------|---------------|--------------------------------|--------------------------------|--------------------------|-----|
| | | Class Code | Classes | Class Room | Class Code | Classes | Class Room | Class Code | Classes | Class Room | Class Code | Classes | Class Room | Class Code | Classes | Class Room | | | |
| 1P & 2P 1P:8:40-9:30 2P:9:40-10:30 | ☆Japanese1 | ☆Japanese1 | C24 | ☆Japanese1 | ☆Japanese1 | C24 | ☆Japanese1 | ☆Japanese1 | C24 | ☆Japanese1 | ☆Japanese1 | C24 | ☆Japanese1 | ☆Japanese2(A) | C12 | ☆Japanese2(A) | ☆Japanese6 | TBA | |
| | ☆Japanese2(B) | ☆Japanese2(B) | C11 | ☆Japanese2(A) | ☆Japanese2(B) | C11 | ☆Japanese2(B) | ☆Japanese2(B) | C11 | ☆Japanese2(B) | ☆Japanese2(B) | C11 | ☆Japanese2(B) | ☆Japanese5 | B22 | ☆Applied Japanese (Speaking B) | ☆Applied Japanese (Speaking B) | B22 | |
| | ☆Japanese5 | ☆Japanese5 | B22 | ☆Japanese5 | ☆Japanese5 | B22 | ☆Japanese5 | ☆Japanese5 | B22 | ☆Japanese5 | ☆Japanese5 | B22 | ☆Japanese5 | ☆Japanese6 | TBA | | | | |
| | ☆Japanese6 | ☆Japanese6 | C23 | ☆Japanese6 | ☆Japanese6 | C23 | | | | | | | | | | | | | |
| | | ☆Japanese3(A) | ☆Japanese3(A) | C11 | ☆Japanese3(A) | ☆Japanese3(B) | C23 | ☆Japanese3(B) | ☆Japanese3(B) | C23 | ☆Japanese3(A) | ☆Japanese3(A) | C11 | ☆Japanese3(A) | ☆Japanese3(B) | C23 | ☆Japanese3(B) | ☆Japanese4 | B22 |
| | | ☆Japanese3(B) | ☆Japanese3(B) | C23 | ☆Japanese4 | ☆Japanese4 | B22 | ☆Japanese4 | ☆Applied Japanese (Writing B) | B22 | ☆Japanese3(A) | ☆Japanese3(B) | C24 | ☆Japanese3(B) | ☆Japanese4 | B22 | ☆Japanese4 | ☆Japanese through Films2 | C24 |
| 3P & 4P 3P:10:40-11:35 4P:11:40-12:35 | ☆Intermediate Kanji and Vocabulary | ☆Intermediate Kanji and Vocabulary | B22 | ☆Applied Japanese (Writing B) | | | | | | | | | | | | | | | |
| | ☆Applied Japanese (Reading A) | ☆Applied Japanese (Reading A) | C12 | | | | | | | | | | | | | | | | |
| Others | | | | | | | | | | | | | | | | | | | |

| | | | | | | | | | | | |
|---|---|-----|---|------------|--------|-----------------------------|-----|--|-------------------|---|------------|
| <p>5P & 6P 5P:13:25-14:15 6P:14:25-15:15</p> | ☆Reading and Writing 1 | C11 | ☆Intermediate Grammar1 | C24 | 672001 | ■Study of Japan A with SDGs | C31 | ☆Reading and Writing 1 | C11 | ☆Extensive Reading 2 | C24 |
| | | | ☆Reading and Writing 2 ☆Japanese Culture and Society Movie Analysis: Topics and Tasks | C23 C11 | | | | ☆Reading and Writing 2 ☆Intermediate Grammar2 □An Exploration of Chanoyu: Ethnography of Art, Mind and History | C23 B22 C27 | ☆Japanese through Films1 □Introduction to Japanology | B22 C27 |
| <p>7P & 8P 7P:15:30-16:20 8P:16:30-17:20</p> | □Intercultural Communication I (7th P only) | TBA | □Comparative Education as Social Science I | C31 | 672001 | ■Study of Japan A with SDGs | C31 | □ Foreign Perspectives of Japan through Documentaries | TBA | □Model United Nations Preparation Class | TBA |
| | □Japanese Agriculture and Rural Society | A37 | | | | | | | | | |
| Others | 671501 ■EPOK Research Project: Spring I | | | | | | | | | | |
| Intensive course | | | | | | | | | | | |

| | |
|---|---|
| Course No. | 672011 |
| Course Title | Study of Japan A with SDGs |
| Instructor(Affiliation) | OBUYASHI Junko (67:Institute of Global Human Resource Development) |
| Term | 1st Term |
| Day/Period | Wed5,Wed6,Wed7,Wed8 |
| Number of credits | 1 |
| Classroom | Building for General Education C31 |
| Required / Elective | |
| Contact information | Room:General Education Building 3rd Floor C309 E-mail: j_obayashi@okayama-u.ac.jp Tel: 086-251-8935 |
| Office hours | Tuesdays 14:00-17:00 By appointment |
| Language | Japanese |
| Course description | The series of the course is designed to enable students to learn about Japanese culture, the issues of Japanese society and the environment especially with a perspective of the SDGs. Students are expected not only to learn about the past (history) and present status of Things Japanese, but also to understand the process, meaning, and role of the sustaining cultures of Japan. This course focuses material cultures and cultural practice in a “traditional” Japanese life in order to explore the issue of cultural, environmental and economical sustainability of traditional Japanese life styles. As hands-on experiential learning, we plan to visit the two sites in Okayama to learn the making of the traditional materials (craft work). The class also looks at the chado practice in relation to the traditional material cultures. Students will conclude the course with their own understanding of how traditional cultures could contribute to human wellbeing, and a suggestion of culturally sustainable living in the global age. The ultimate goal of the course is to develop human resources who can perceive the challenges as their own, become aware of the issues in the process of discussions with others, and think about how to cope with the challenge to build a sustainable living in the global community |
| Learning objectives | The course intends to provide first-hand opportunities for students to explore Okayama and Japan from a unique angle of SDGs. The students are expected to grasp traditional technique of the material culture of Bizen-pottery and Igusa-weaving, and the traditional practice of chado, and to discuss their pros and cons in the contemporary life in Japan. Finally students are expected to envision their own sustainable life styles according to what is learned through the classes. |
| Learning outcomes | Students should be able to: 1) Understand the cultural, society, and people of Okayama and Japan. 2) Explain the culture and society of Japan based on the learning. 3) Self-reflect on cultural values and attitudes with the understanding of the SDGs in the wider global context. |
| Course schedule | This course consists of lectures, presentation, and field trips. (1) Introduction: Overviewing the course, What is a Sustainable Living? (2) History and adaptation of Bizen Pottery in living: Preparations for Interviews (3) Field Trip to Bizen (4) Group Work on wrap-up Bizen trip, History and adaptation of Igusa Weaving in living: Preparations for Interviews (5) Field Trip to Hayashima (6) Group Work on wrap-up Hayashima trip ,Lecture on traditional cultures and living in Japan (video: chado) (7) Discussions on material cultures, and sustainable living: (8) (Group) Presentations ※ The schedule is subject to change |
| Learning activities outside of classroom | Reading and writing on the topics is essential. Students will review the materials covered in the previous weeks. Students are encouraged to read newspapers/ magazines articles relevant to this course and share them in the class. Students' active participation is highly expected. |
| Teaching format-Message to the students | Lecture, Discussion, Fieldwork Depending on the circumstance, all the sessions needs to be conducted online including the fieldtrips which may be substituted with non-field activities. |
| Equipment used-Message to the students | There will be hands-on activities. If anyone feels they will need special assistance for this class, please inform the instructor during the first two weeks of class. |
| Textbook | No textbook is required and if any, handouts will be provided. |
| Reference material | TBA |
| Grading | Attendance 25%, Participation 25%, Final Assignment 50% |
| Relation to research activity | |
| Prerequisites | You need to be insured for the off-campus activities. You need to be nunctual to go on the fieldtrins |
| Relation to SDGs Goals1 | 11. Sustainable Cities and Communities |
| Relation to SDGs Goals2 | 12. Responsible Consumption and Production |
| Relation to SDGs Goals3 | 16. Peace, Justice and Strong Insituations |
| Other comments | Activity fees is required. (TBA, To be collected at the beginning of the course.) Either Gakkensai insurance ²⁷ or Okayama University co-op insurance is required. |

| | |
|--|--|
| Course No. | 671501 |
| Course Title | EPOK Research Project: Spring I |
| Instructor(Affiliation) | OBAYASHI Junko, INAMORI Takao, MORI Takami (67:Institute of Global Human Resource Development) |
| Term | 1st Term |
| Day/Period | TBA 7, 8 |
| Number of credits | 1 |
| Classroom | TBA |
| Required / Elective | EPOK Certificate |
| Contact information | assigned advisor |
| Office hours | TBA |
| Language | English |
| Course description | Students conduct an original research for the total duration of 16 weeks (2 semesters: EPOK Research Project I and EPOK Research Project II) to explore a topic of interest among themes and issues in the wide variety of Japanese culture, society or environment. In this course (I), the first half of the research project, student will learn to build a research structure, including a topic statement, literature review, and methodology, in order to outline the project. At the end of the semester student should produce a research proposal which presents the thesis of the topic. Research Project may not duplicate available courses offered in the semesters. (The proposal should be developed to finish as a final research paper in the following Research Project II.) |
| Learning objectives | The course aims to aid EPOK students to pursue independent research interest and project on Japanese culture, society or environment, in which they are encouraged to utilize fieldwork opportunity. The goal of the course (I) is to construct, proceed and outline the research to make a proposal. |
| Learning outcomes | The student is able to: 1) Formulate a topic of interest to explore academically that encourages them to enhance an understanding of Japan. 2) Learn to conduct an active field work as a method of research. 3) Present the outline of the research. |
| Course schedule | Week 1)-7) Independent Study with Advisor:(The student will meet with the assigned instructor of the research project at least once every (two) week(s) during the semester.) *Schedule TBA by your advisor · Orientation: planning your EPOK project · Formulating Research Topic Assignment-1) Preliminary topic discussion, · Preliminary Literature Review Assignment-2) Reference · Research Methodology Assignment-3) Methodology and Research · Analysis and Argument Assignment-4) Analysis and Discussion Summary Week8) Outline the research project <Presentation> Final Term Assignment: Research Outline as Proposal Note: A student should expect to spend at least 45 hours, including meetings and readings, on the project over the course of the semester for a 1.0 course credit research project. |
| Learning activities outside of classroom | Independent research with directed review |
| Teaching format-Message to the students | The meeting hours need to be scheduled with the instructor. The student will work on conducting the research individually under the direction of an assigned instructor. At the end of the semester students present the research proposal. |
| Equipment used-Message to the students | TBA |
| Textbook | TBA |
| Reference material | |
| Grading | Attendance 20%, Assignments 30%, Research Proposal 50% |
| Relation to research activity | A good academic approach to the topic of interest, and a self-disciplined working attitude are necessary for the independent study. |
| Prerequisites | |
| Relation to SDGs Goals1 | 17.Partnerships for the Goals |
| Relation to SDGs Goals2 | |
| Relation to SDGs Goals3 | |
| Other comments | EPOK students who pursue ²⁸ EPOK Certificate must take this course (EPOK Research |

2nd Term

Course List for EPOK 2021-2022 2nd Term

!! information listed is subject to change

| Term | Class Code | Classes | Timetable | | Credits | Language J:Japanese E:English | Online | In-person | Lecturer(s) | ★ Approval necessary |
|------|------------|--|-----------|----------|---------|-------------------------------------|--|-----------|-------------------------------|----------------------------|
| | | | | | | | | | | |
| 2 | 672012 | Study of Japan B with SDGs | Wed | 5-6-7-8 | 1 | E & J | ○ | | INAMORI Takao | |
| 2 | 671502 | EPOK Research Project: Spring II | TBA | TBA | 1 | E | ○ | | IGHRAD Academic Staff | |
| 2 | 912717 | Seminar of Sport Performance(Flying Disc) (Choose from 912717 or 912722) | Mon | 1-2 | 1 | E&J | TBA | | KOBAYASHI Yuji, | ★ |
| 2 | 133038 | Recycle Engineering | Mon | 1-2 | 1 | E | TBA | | NANBA Tokuro | ★ |
| 2 | 911460 | English Communication: Healthy & Sustainable Societies 1 | Mon | 3-4 | 1 | E | TBA | | RUCYNSKI John Edward | ★ |
| 2 | 133044 | Conservation and Utilization of Water Resources | Mon | 4-5-6-7 | 2 | E | TBA | | SAITO Mitsuyo and others | ★ |
| 2 | 131079 | Anthropology of Disaster | Mon & Thu | 5-6 | 2 | E | TBA | | UESUGI Takeshi | ★ |
| 2 | 673122 | Intercultural Communication II | Mon | 7 | 0.5 | E | TBA | | NAKAMURA Ian Iseo | |
| 2 | 911086 | Area Studies: Approaches and Methodologies | Mon | 7-8 | 1 | E | ○ | | INAMORI Takao | |
| 2 | 912502 | Introduction to wellness experiencing Japanese culture | Mon | 7-8 | 1 | E | △ Some classes will be provided on-line | ○ | UZUKA Mariko | ★ |
| 2 | 131070 | Sociological Imagination | Mon & Thu | 7-8 | 2 | E | TBA | | MIYAGAWA Haruna | ★ |
| 2 | 131048 | Modern Physics | Mon & Thu | 8 7-8 | 1.5 | E | TBA | | TANG Jian | |
| 2 | 911106 | Lecture on Japanese Culture 1 | Tue | 3-4 | 1 | E | TBA | | KIM Dong Kwang | ★ |
| 2 | 132030 | Introduction to Animal Science | Tue | 5-6 | 1 | E | TBA | | NISHINO Naoki | ★ |
| 2 | 131047 | Mathematics for Physical Chemistry | Tue & Thu | 5 5-6 | 1.5 | E | TBA | | UDDIN Azhar | ★ |
| 2 | 911087 | Comparative Education as Social Science II | Tue | 7-8 | 1 | E | ○ | | KAMBARA Nobuyuki | |
| 2 | 912502 | Experience Community Service through Elderly Care | Tue | 7-8 | 1 | E | TBA | | MAHMOOD Sabina | |
| 2 | 133086 | Agrochemical Bioscience 3 - Organic Chemistry | Wed | 3-4 | 1 | E | TBA | | KIYOTA Hiromasa and others | ★ |
| 2 | 132047 | Introduction to Agrochemical Bioscience | Wed | 5-6 | 1 | E | TBA | | NAKAMURA Yoshimasa and others | ★ |
| 2 | 912722 | Seminar of Sport Performance(Flying Disc) (Choose from 912717 or 912722) | Thu | 1-2 | 1 | E&J | TBA | | KOBAYASHI Yuji, | ★ |

| | | | | | | | | | | |
|----------------|--------|--|-----------|-----|-----|---|-----------|--|--|---|
| 2 | 132022 | Fundamentals of Physical Chemistry | Thu | 1-2 | 1 | E | TBA | | KAMESHIMA Yoshikazu , TAKAGUCH Yutaka I | ★ |
| 2 | 911088 | Introduction to Area Studies on Hawaii I | Thu | 5-6 | 1 | E | O | | OBAYASHI Junko | |
| 2 | 132025 | Civil Engineering II | Fri | 3-4 | 1 | E | TBA | | KIMOTO Kazushi and others | ★ |
| 2 | 912037 | Servant Leadership 2 | Fri | 5-6 | 1 | E | O | | ISHIDA Mamoru | |
| 2 | 132027 | Introduction to Environmental Ecology | Fri | 5-6 | 1 | E | TBA | | DATAI Hisashi and others | ★ |
| 2 | 911106 | English Communication: Healthy & Sustainable Societies 2 | Fri | 5-6 | 1 | E | TBA | | KIM Dong Kwang | ★ |
| 2 | 131068 | Topics in Management III | Fri | 7-8 | 1.5 | E | TBA | | GONG Yuan Yuan | |
| 2 Intensive | 911455 | A Practical Guide to Intercultural Communication | Intensive | | 1 | E | on-demand | | KIM Dong Kwang | |
| 2 Intensive | 133065 | Trade Policy and Development | Intensive | | 2 | E | TBA | | YAMAMOTO Yumiko | |

Japanese Language Course

※Check Japanese Language Course Catalog for details

| Term | Class Code | Classes | Timetable | Credits | Language | Online | In-person | Lecturer(s) | |
|------|------------|---|------------------------------|---------|----------|--------|-----------|---------------------|-----------------|
| 2 | 917021 | Japanese1-2 (Placement Test Score 0-30) | Mon, Tue, Wed, Thu | 1-2 | 4 | J | O | Exam (Possiboly) | SUESHIGE Miwa |
| 2 | 917029 | Japanese2-2 (A) (Placement Test Score 31-47) | Tue, Wed, Thu, | 1-2 | 4 | J | O | Exam (Possiboly) | SATO Miho |
| 2 | 917030 | Japanese2-2 (B) (Placement Test Score 31-47) | Mon, Tue, Wed, Thu | 1-2 | 4 | J | O | Exam (Possiboly) | NAGANO Masumi |
| 2 | 917037 | Japanese3-2 (A) (Placement Test Score 48-58) | Mon, Tue, Thu, Fri | 3-4 | 4 | J | O | | GOTO Naomi |
| 2 | 917038 | Japanese3-2 (B) (Placement Test Score 48-58) | Mon, Wed, Thu, Fri | 3-4 | 4 | J | O | | OHTA Saeko |
| 2 | 917043 | Japanese4-2 (Placement Test Score 59-68) | Tue, Wed, Thu, Fri | 3-4 | 4 | J | O | Exam | MORIYA Tomomi |
| 2 | 917047 | Japanese5-2 (Placement Test Score 69-74) | Mon, Tue, Wed, Thu, | 1-2 | 4 | J | O | | UCHIMARU Yukako |
| 2 | 917050 | Japanese6-2 (Placement Test Score 75-82) | Mon, Tue, Thu, Fri | 1-2 | 4 | J | O | Exam (Possiboly) | AOI Yuka |
| 2 | 917002 | Applied Japanese (Listening A) (Placement Test Score 83-100) | Thu | 3-4 | 1 | J | O | Exam (Possiboly) | NAGANO Masumi |
| 2 | 917006 | Applied Japanese (Writing B) (Placement Test Score 83-100) | Tue | 3-4 | 1 | J | O | Exam | MORIYA Tomomi |
| 2 | 917010 | Applied Japanese (Speaking B) (Placement Test Score 83-100) | Fri | 1-2 | 1 | J | O | | UCHIMARU Yukako |
| 2 | 917014 | Applied Japanese (Reading A) (Placement Test Score 83-100) | Mon | 3-4 | 1 | J | O | Exam (Possiboly) | SUESHIGE Miwa |

| | | | | | | | | | |
|---|--------|---|-----------------|-----|---|---|---|---------------------|---------------|
| 2 | 917055 | Japanese through Films 1-2 (Placement Test Score 48-68) | Fri | 5-6 | 1 | J | ○ | Exam (Possiboly) | AKITA Setsuko |
| 2 | 917059 | Japanese through Films 2-2 (Placement Test Score 69-100) | Fri | 3-4 | 1 | J | ○ | Exam (Possiboly) | AKITA Setsuko |
| 2 | 917069 | Extensive Reading 2-2 (Placement Test Score 75-100) | Fri | 5-6 | 1 | J | ○ | Exam (Possiboly) | OHTA Saeko |
| 2 | 917073 | Intermediate Kanji and Vocabulary (Placement Test Score 59-74) | Mon | 3-4 | 1 | J | ○ | Exam (Possiboly) | AOI Yuka |
| 2 | 917077 | Intermediate Grammer 1-2 (Placement Test Score 48-68) | Tue | 5-6 | 1 | J | ○ | Exam (Possiboly) | AOI Yuka |
| 2 | 917081 | Intermediate Grammer 2-2 (Placement Test Score 69-100) | Thu | 5-6 | 1 | J | ○ | Exam | MORIYA Tomomi |
| 2 | 917084 | Japanese Culture and Society (Placement Test Score 69-100) | The | 5-6 | 1 | J | ○ | Exam (Possiboly) | KONKOH Noriko |
| 2 | 917090 | Reading and Writing 1-2 (Placement Test Score 0-47) | Mon & Thu | 5-6 | 2 | J | ○ | Exam (Possiboly) | UMEKAWA Yuko |
| 2 | 917096 | Reading and Writing 2-2 (Placement Test Score 31-58) | Tue & Thu | 5-6 | 2 | J | X | ○ | USHIDA Eiko |

2020-2021 EPOK Timetable of Course 2nd Term

| | | ☆Japanese Language Course ■:Foreign students only □:EPOK course and Reg. course students | | | | | | | | | | | | |
|---|--|--|-------------------------------|------------|---------------------------------|---------------------------------|------------|---------------------------------|---------------------------------|------------|--------------------------------|--------------------------------|------------|--|
| | | Monday | | Tuesday | | Wednesday | | Thursday | | Friday | | | | |
| | | Class Code | Classes | Class Room | Class Code | Classes | Class Room | Class Code | Classes | Class Room | Class Code | Classes | Class Room | |
| 1P & 2P 1P:8:40-9:40 2P:9:50-10:50 | | ☆Japanese1 | ☆Japanese1 | C24 | ☆Japanese1 | ☆Japanese1 | C24 | ☆Japanese1 | ☆Japanese1 | C24 | ☆Japanese2(A) | ☆Japanese2(A) | C12 | |
| | | ☆Japanese2(B) | ☆Japanese2(A) | C11 | ☆Japanese2(A) | ☆Japanese2(A) | C12 | ☆Japanese2(A) | ☆Japanese2(A) | C12 | ☆Japanese6 | ☆Japanese6 | TBA | |
| | | ☆Japanese5 | ☆Japanese2(B) | B22 | ☆Japanese2(B) | ☆Japanese2(B) | C11 | ☆Japanese2(B) | ☆Japanese2(B) | C11 | ☆Applied Japanese (Speaking B) | ☆Applied Japanese (Speaking B) | B22 | |
| | | ☆Japanese6 | ☆Japanese5 | C23 | ☆Japanese5 | ☆Japanese5 | B22 | ☆Japanese5 | ☆Japanese5 | B22 | | | | |
| | | | ☆Japanese6 | | C23 | ☆Japanese6 | | | ☆Japanese6 | | TBA | | | |
| | | | | | | | | | | | | | | |
| 3P & 4P 3P:11:00-12:00 4P:12:50-13:50 (Japanese Language Course 4P:12:10-13:10) | | ☆Japanese3(A) | ☆Japanese3(A) | C11 | ☆Japanese3(B) | ☆Japanese3(A) | C23 | ☆Japanese3(A) | ☆Japanese3(A) | C11 | ☆Japanese3(A) | ☆Japanese3(A) | C11 | |
| | | ☆Japanese3(B) | ☆Japanese4 | C23 | ☆Japanese4 | ☆Japanese3(B) | B22 | ☆Japanese3(B) | ☆Japanese3(B) | C23 | ☆Japanese3(B) | ☆Japanese3(B) | C23 | |
| | | ☆Intermediate Kanji and Vocabulary | ☆Applied Japanese (Writing B) | B22 | ☆Applied Japanese (Writing B) | Japanese 4 | B22 | Japanese 4 | Japanese 4 | B22 | ☆Japanese4 | ☆Japanese4 | B22 | |
| | | ☆Applied Japanese (Reading A) | ☆Applied Japanese (Reading A) | C12 | ☆Applied Japanese (Listening A) | ☆Applied Japanese (Listening A) | C24 | ☆Applied Japanese (Listening A) | ☆Applied Japanese (Listening A) | C24 | ☆Japanese through Films2 | ☆Japanese through Films2 | C24 | |
| Others | | | | | | | | | | | | | | |

| | | | | | | | | | | | |
|---|--|-----|---|------------|--------|-----------------------------|-----|---|-------------------|--------------------------|-----|
| 5P & 6P 5P:14:00-15:00 6P:15:10-16:10 | ☆Reading and Writing 1 | C11 | ☆Intermediate Grammar1 | C24 | 672012 | ■Study of Japan B with SDGs | C31 | ☆Reading and Writing 1 | C11 | ☆Extensive Reading 2 | C24 |
| | | | ☆Reading and Writing 2 ☆Japanese Culture and Society | C23 C11 | | | | ☆Reading and Writing 2 ☆Intermediate Grammar2 <input type="checkbox"/> Introduction to Area Studies on Hawaii I | C23 B22 C21 | ☆Japanese through Films1 | B22 |
| 7P & 8P 7P:16:20-17:20 8P:17:30-18:30 | <input type="checkbox"/> Intercultural Communication II (7th P only) | TBA | <input type="checkbox"/> Comparative Education as Social Science II | C31 | 672012 | ■Study of Japan B with SDGs | C31 | | | | |
| | <input type="checkbox"/> Area Studies: Approaches and Methodologies | D22 | | | | | | | | | |
| Others | 671502 ■EPOK Research Project: Spring II | | | | | | | | | | |
| Intensive course | | | | | | | | | | | |

| | |
|---|--|
| Course No. | 672012 |
| Course Title | Study of Japan B with SDGs |
| Instructor(Affiliation) | INAMORI Takao (67:Institute of Global Human Resource Development) |
| Term | 2nd Term |
| Day/Period | Wed5, Wed6, Wed7, Wed8 |
| Number of credits | 1 |
| Classroom | Building for General Education C31 |
| Required / Elective | |
| Contact information | Room:General Education Building 3rd Floor C303 E-mail: takaoinamori@okayama-u.ac.jp Tel: 086-251-7270 |
| Office hours | Mon-Fri Preferably by appointment |
| Language | English and Japanese |
| Course description | The series of the course is designed to enable students to learn about Japanese culture, the issues of Japanese society and the environment especially with a perspective of the SDGs. Students are expected not only to learn about the past (history) and present status of Things Japanese, but also to understand the process, meaning, and role of the sustaining cultures of Japan. In Study of Japan B, students will learn about the history, characteristics and issues of the Japanese education. Based on the knowledge and understanding, field study at an elementary school and high school in Okayama will be organised to figure out the current situation and exchange opinions about school-related matters. Finally, issues and solutions for SDGs goal no. 4 will be discussed the effective approach will be examined in comparison with Japan and the world education. |
| Learning objectives | 1. Learn about history of Japanese education system 2. Understand characteristics of Japanese education system 3. Comprehend current situation of primary and secondary education in Japan 4. Examine issues and solutions for SDGs goal No. 4 |
| Learning outcomes | 1. To be able to explain history, characteristics and issues of Japanese education system 2. To be able to describe current situation of primary and secondary education in Japan 3. To be able to analyse and examine issues and solutions for SDGs goal No. 4 |
| Course schedule | 1. Orientation 2. History of Japanese education system 3. Characteristics and issues of Japanese education and the system 4. Field visit 1 (Ishii elementary school) 5. Field visit 2 (Okayama Minami high school) 6. Field work (Takahashi city) 7. Examine issues and solutions of SDGs goal No. 4 * The schedule may be changed on account of the elementary and high schools. |
| Learning activities outside of classroom | Reading and writing on the topics is essential. Students will review the materials covered in the previous weeks. Students are encouraged to read newspapers/ magazines articles relevant to this course and share them in the class. Students' active participation is highly expected. |
| Teaching format-Message to the students | Occasionally learning material will be provided. Please complete the task by the due date. |
| Equipment used-Message to the students | Consult with the instructor in advance if you need special assistance. |
| Textbook | |
| Reference material | TBA |
| Grading | Attendance 25%, Participation 25%, Final Assignment 50% |
| Relation to research activity | |
| Prerequisites | The lectures will be delivered in both English and Japanese. |
| Relation to SDGs Goals1 | 4. Quality Education |
| Relation to SDGs Goals2 | |
| Relation to SDGs Goals3 | |
| Other comments | Activity fees is required. (TBA, To be collected at the beginning of the course.) |

| | |
|--|--|
| Course No. | 671502 |
| Course Title | EPOK Research Project: Spring II |
| Instructor(Affiliation) | OBAYASHI Junko, INAMORI Takao, MORI Takami (67:Institute of Global Human Resource Development) |
| Term | 2nd Term |
| Day/Period | TBA 7, 8 |
| Number of credits | 1 |
| Classroom | TBA |
| Required / Elective | EPOK Certificate assigned advisor |
| Contact information | |
| Office hours | TBA |
| Language | English |
| Course description | Research Project (II) indicates the research conducted in the previous semester will be brushed up to conclude as a final research essay in the course. The work will include completing the fieldwork, compiling and analyzing the data, concluding the findings possibly with suggestions for future research in the thesis. The essay of approximately 3000wds needs to be written according to the requested format, including tables and photos. The student needs to work on a short writing of the abstract in Japanese (if the essay is written in English). At the end of the course, the students will make a presentation based on the research essay. (EPOK Research Presentation session) |
| Learning objectives | The course aims to aid EPOK students to: 1) Pursue independent research interest in Japanese culture, society and environment. 2) Write academically to produce a research essay. 3) Organize and present effectively the research outcome. |
| Learning outcomes | The student is able to: 1) Complete a task to write a research essay as the final product of the research. 2) Learn to organize and present a research paper. 3) Obtain the further understanding of the topic in Japanese culture, society and environment, and Explain them with their own words. |
| Course schedule | Week 1)-6) Independent Study with Advisor:(The student will meet with the assigned instructor of the research project at least once every (two) week(s) during the semester.) *Schedule TBA by your advisor · Adjusting, Reviewing the Proposal · Analysis and Argument (Assignment: Analysis and Discussion Summary) · Reflection of the Research Conclusion · Writing Instruction Week 7) Complete and Submit the Project Essay Week 8) Research Project Presentation (to be scheduled in the final week of the semester) |
| Learning activities outside of classroom | Independent research with directed review |
| Teaching format-Message to the students | The meeting hours need to be scheduled with the instructor. The student will work on conducting the research individually under the direction of an assigned instructor. At the end of the semester students present the Research Project (final Essay). |
| Equipment used-Message to the students | TBA |
| Textbook | TBA |
| Reference material | |
| Grading | Participation 15%, Presentation 35%, Final product 50% The assigned instructor will evaluate the work of the semester including a final essay, and the final presentation with the total evaluations of the contributing instructors, in order to submit a final grade. Participation evaluates the organization and participation in pursuing the research through the semester. |
| Relation to research activity | A good academic approach to the topic of interest, and a self-disciplined working attitude are necessary for the independent study. |
| Prerequisites | |
| Relation to SDGs Goals1 | 4. Quality Education |
| Relation to SDGs Goals2 | 17.Partnerships for the Goals |
| Relation to SDGs Goals3 | |
| Other comments | EPOK students who pursue EPOK Certificate must take this course (EPOK Research Project I and II). |

3rd Term

Course List for EPOK 2021-2022 3rd Term

!! information listed is subject to change

| Term | Class Code | Classes | Timetable | | Credits | Language J:Japanese E:English | Online | in-Person | Lecturer(s) | ★ Approval necessary |
|------|------------|--|-----------|---------|---------|-------------------------------------|--------|-----------|--------------------------------------|----------------------------|
| 3 | 672013 | Study of Japan C with SDGs | Wed | 5-6-7-8 | 1 | J&E | ○ | | MOHRI Takami | |
| 3 | 671503 | EPOK Research Project: Fall I | TBA | TBA | 1 | E | ○ | | IGHRAD Academic Staff | |
| 3 | 133026 | Seminar on Foundation of Mathematical Science | Mon | 1-2 | 1 | E | TBA | | HAYASAKA Futoshi | ★ |
| 3 | 911457 | English Communication: Healthy & Sustainable Societies 1 | Mon | 1-2 | 1 | E | TBA | | PRICHARD Caleb | ★ |
| 3 | 912726 | Seminar of Sport Performance(Tennis) (Choose from 912726,912736 ,or 912738) | Mon | 1-2 | 1 | E&J | TBA | | KOBAYASHI Yuji, | ★ |
| 3 | 133066 | Poverty | Mon & Thu | 1-2 | 2 | E | TBA | | YAMAMOTO Yumiko | |
| 3 | 912518 | Self exploration through Creativity | Mon | 3-4 | 1 | E | TBA | | MAHMOOD Sabina | |
| 3 | 132053 | Sociology of Migration I | Mon & Thu | 3-4 | 2 | E | TBA | | MIYAGAWA Haruna | ★ |
| 3 | 132005 | Medical Anthropology | Mon & Thu | 5-6 | 2 | E | TBA | | UESUGI Takeshi | ★ |
| 3 | 673131 | Language , Culture, and Social Interaction I | Mon | 7 | 0.5 | E | TBA | | NAKAMURA Ian Iseo | |
| 3 | 131076 | Philanthropy and Nonprofit Organizations | Mon & Thu | 9-10 | 2 | E | TBA | | YOSHIOKA Takayuki | |
| 3 | 132020 | Elementary Mathematical Science | Tue | 1-2 | 1 | | TBA | | ISHIHARA Takashi, AOYAMA Takahiro | ★ |
| 3 | 911089 | Working in Cross-cultural Organisations | Tue | 5-6 | 1 | E | TBA | | INAMORI Takao | |
| 3 | 912504 | Experience Community Service through After-School Activity□ | Tue | 7-8 | 1 | E | X | | UZUKA Mariko | ★ |
| 3 | 673153 | Writing about Movies: Topics and Terms for Film Analysis | Tue | 7-8 | 1 | E | TBA | | MEIKI Susan Mary | |
| 3 | 911456 | Global Studies 3 | Wed | 5-6 | 1 | E | TBA | | KIM Dong Kwang | ★ |
| 3 | 912736 | Seminar of Sport Performance(Tennis) (Choose from 912726,912736 ,or 912738) | Thu | 1-2 | 1 | E&J | TBA | | KOBAYASHI Yuji, | ★ |
| 3 | 911169 | Introduction to Japanese Pop Culture | Thu | 3-4 | 1 | E&J | TBA | | FUJIMOTO Masumi | |
| 3 | 131084 | Quantum Physics and Atomic Structure | Thu | 3-4 | 1 | E | TBA | | TANG Jian | |
| 3 | 912738 | Seminar of Sport Performance(Tennis) (Choose from 912726,912736 ,or 912738) | Thu | 3-4 | 1 | E&J | TBA | | KOBAYASHI Yuji, | ★ |
| 3 | 911091 | Introduction to Area Studies of Hawai'i II | Thu | 5-6 | 1 | E | ○ | | OBAYASHI Junko | |

| | | | | | | | | | | |
|----------------|--------|--|-----------|------|-----|-----|-----|--|-----------------|---|
| 3 | 911110 | Japan in the Age of Globalization 1 | Thu | 5-6 | 1 | E | TBA | | KIM Dong Kwang | ★ |
| 3 | 131082 | Fundamentals of Physics I | Thu | 7-8 | 1 | E | TBA | | TANG Jian | |
| 3 | 131067 | Topics in Management II | Thu | 7-8 | 1.5 | E | TBA | | GONG Yuan Yuan | |
| 3 | 131088 | Introduction to Catalytic Chemistry | Fri | 1-2 | 1 | E | TBA | | UDDIN Azhar | ★ |
| 3 | 912034 | Servant Leadership 1 | Fri | 5-6 | 1 | E | ○ | | ISHIDA Mamoru | |
| 3 | 131041 | Introduction to Microeconomics | Fri | 5-6 | 1.5 | E | TBA | | YAMAMOTO Yumiko | |
| 3 | 673142 | Model United Nations Preparation Class | Fri | 7-8 | 1 | E | TBA | | FUJISHIMA Naomi | |
| 3 Intensive | 912005 | This is Okayama 1 | Intensive | | 1 | E&J | X | | FUJIMOTO Masumi | ★ |
| 3 & 4 | 132018 | Japanese Politics | Mon | 7-8 | 2 | E | TBA | | OSAWA Kimiko | |
| 3 & 4 | 131080 | Anthropology of Food | Tue | 5-6 | 3 | E | TBA | | UESUGI Takeshi | ★ |
| 3 & 4 | 131072 | Introduction to Political Science | Wed | 7-8 | 3 | E | TBA | | OSAWA Kimiko | |
| 3 & 4 | 132050 | Topics in Management VI | Thu | 5-6 | 2 | E | TBA | | GONG Yuan Yuan | |
| 3 & 4 | 132052 | Topics in Management VIII | Thu | 9-10 | 2 | E | TBA | | GONG Yuan Yuan | |
| 3 & 4 | 131075 | Korean Diaspora | Fri | 7-8 | 3 | E | TBA | | CHUNG Haeng-ja | ★ |

Japanese Language Course

for details

※Check Japanese Language Course Catalog

| Term | Class Code | Classes | Timetable | Credits | Language | Online | in-Person | Lecturer(s) |
|------|------------|---|-----------------------------|---------|----------|--------|-----------|-------------|
| 3 | | Japanese1-1(A) (Placement Test Score 0-30) | Mon, Tue, Thu, Fri | 1-2 | 4 | J | ○ | TBA |
| 3 | | Japanese1-1(B) (Placement Test Score 0-30) | Mon, Tue, Wed, Thu | 1-2 | 4 | J | ○ | TBA |
| 3 | | Japanese1-1(C) (Placement Test Score 0-30) | Mon, Tue, Wed, Thu | 3-4 | 4 | J | ○ | TBA |
| 3 | | Japanese2-1 (A) (Placement Test Score 31-47) | Tue, Wed, Thu, | 1-2 | 4 | J | ○ | TBA |
| 3 | | Japanese2-1 (B) (Placement Test Score 31-47) | Mon, Tue, Wed, Thu | 1-2 | 4 | J | ○ | TBA |
| 3 | | Japanese3-1 (A) (Placement Test Score 48-58) | Mon, Tue, Thu, Fri | 3-4 | 4 | J | ○ | TBA |
| 3 | | Japanese3-1 (B) (Placement Test Score 48-58) | Mon, Wed, Thu, Fri | 3-4 | 4 | J | ○ | TBA |

| | | | | | | | | |
|---|---|------------------------------|-----|---|---|---|--|-----|
| 3 | Japanese4-1 (Placement Test Score 59-68) | Tue, Wed, Thu, Fri | 3-4 | 4 | J | ○ | | TBA |
| 3 | Japanese5-1 (Placement Test Score 69-74) | Mon, Tue, Wed, Thu, | 1-2 | 4 | J | ○ | | TBA |
| 3 | Japanese6-1 (Placement Test Score 75-82) | Mon, Tue, Thu, Fri | 1-2 | 4 | J | ○ | | TBA |
| 3 | Applied Japanese (Listening B) (Placement Test Score 83-100) | Fri | 1-2 | 1 | J | ○ | | TBA |
| 3 | Applied Japanese (Writing A) (Placement Test Score 83-100) | Mon | 3-4 | 1 | J | ○ | | TBA |
| 3 | Applied Japanese (Speaking A) (Placement Test Score 83-100) | Thu | 3-4 | 1 | J | ○ | | TBA |
| 3 | Applied Japanese (Reading B) (Placement Test Score 83-100) | Tue | 5-6 | 1 | J | ○ | | TBA |
| 3 | Japanese through Films 1-1 (Placement Test Score 48-68) | Fri | 7-8 | 1 | J | ○ | | TBA |
| 3 | Japanese through Films 2-1 (Placement Test Score 69-100) | Fri | 5-6 | 1 | J | ○ | | TBA |
| 3 | Extensive Reading 1-1 (Placement Test Score 48-74) | Fri | 5-6 | 1 | J | ○ | | TBA |
| 3 | Extensive Reading 2-1 (Placement Test Score 75-100) | Wed | 3-4 | 1 | J | ○ | | TBA |
| 3 | Intermediate Kanji and Vocabulary (Placement Test Score 59-74) | Mon | 3-4 | 1 | J | ○ | | TBA |
| 3 | Intermediate Grammar 1-1 (Placement Test Score 48-68) | Wed | 5-6 | 1 | J | ○ | | TBA |
| 3 | Intermediate Grammar 2-1 (Placement Test Score 69-100) | Tue | 3-4 | 1 | J | ○ | | TBA |
| 3 | Study of Okayama (Placement Test Score 69-100) | Fri | 3-4 | 1 | J | ○ | | TBA |
| 3 | Reading and Writing 1-1(A) (Placement Test Score 0-47) | Mon & Thu | 5-6 | 2 | J | ○ | | TBA |
| 3 | Reading and Writing 1-1(B) (Placement Test Score 0-47) | Tue & Fri | 5-6 | 2 | J | ○ | | TBA |
| 3 | Reading and Writing 2-1(A) (Placement Test Score 31-58) | Tue & Thu | 5-6 | 2 | J | ○ | | TBA |
| 3 | Reading and Writing 2-1(B) (Placement Test Score 31-58) | Tue & Fri | 5-6 | 2 | J | ○ | | TBA |
| 3 | Japanese Through New and magazine Articles (Placement Test Score 59-74) | Tue | 5-6 | 1 | J | ○ | | TBA |
| 3 | Media Literacy (Placement Test Score 74-100) | Thu | 5-6 | 1 | J | ○ | | TBA |

2021-2022 EPOK Timetable of Course 3rd Term

| | | Monday | | | Tuesday | | | Wednesday | | | Thursday | | | Friday | | |
|--|------------------------------|------------------------------------|---------|------------------------|------------|----------------------|------------|---------------|---------|------------------------------|------------|--------------------------------|------------|-------------------|---------------------------------|------------|
| | | Class Code | Classes | Class Room | Class Code | Classes | Class Room | Class Code | Classes | Class Room | Class Code | Classes | Class Room | Class Code | Classes | Class Room |
| 1P & 2P 1P:8:40-9:30 2P:9:40-10:30 | | ☆Japanese1(A) | C21 | ☆Japanese1(A) | C21 | ☆Japanese1(B) | C23 | ☆Japanese1(A) | C24 | ☆Japanese1(A) | C24 | ☆Japanese1(A) | C24 | ☆Japanese1(A) | C24 | |
| | | ☆Japanese 1(B) | C23 | ☆Japanese1(B) | C23 | ☆Japanese2(A) | C11 | ☆Japanese1(B) | C11 | ☆Japanese1(B) | C23 | ☆Japanese1(B) | C23 | ☆Japanese2(A) | C11 | |
| | | ☆Japanese5 | B22 | ☆Japanese2(A) | C11 | ☆Japanese2(B) | C12 | ☆Japanese2(B) | C12 | ☆Japanese2(A) | C11 | ☆Japanese2(B) | C12 | ☆Japanese2(B) | C12 | |
| | | ☆Japanese6 | C24 | ☆Japanese2(B) | C12 | ☆Japanese5 | B22 | ☆Japanese5 | B22 | ☆Japanese2(B) | C12 | ☆Japanese5 | B22 | ☆Japanese6 | TBA | |
| | | | | | ☆Japanese5 | B22 | | | | | ☆Japanese5 | B22 | | | ☆Applied Japanese (Listening B) | B22 |
| | | | | | ☆Japanese6 | C24 | | | | | ☆Japanese6 | C24 | | | | |
| 3P & 4P 3P:10:40-11:35 4P:11:40-12:35 | | ☆Japanese1(C) | C12 | ☆Japanese1(C) | C12 | ☆Japanese1(C) | C12 | ☆Japanese1(C) | C12 | ☆Japanese1(C) | C12 | ☆Japanese1(C) | C12 | ☆Japanese3(A) | C23 | |
| | | ☆Japanese3(A) | C23 | ☆Japanese3(A) | C23 | ☆Japanese3(B) | C11 | ☆Japanese3(B) | C11 | ☆Japanese3(A) | C23 | ☆Japanese3(A) | C23 | ☆Japanese3(B) | C11 | |
| | | ☆Japanese3(B) | C11 | ☆Japanese4 | B22 | ☆Japanese4 | B22 | ☆Japanese4 | B22 | ☆Japanese4 | B22 | ☆Japanese3(B) | C11 | ☆Japanese4 | B22 | |
| | | ☆Intermediate Kanji and Vocabulary | C24 | ☆Intermediate Grammar2 | C24 | ☆Extensive Reading 2 | C24 | | | ☆Intermediate Grammar2 | C24 | ☆Japanese4 | C24 | ☆Study of Okayama | C24 | |
| | ☆Applied Japanese(Writing A) | B22 | | | | | | | | ☆Applied Japanese(Writing A) | B22 | ☆Applied Japanese (Speaking A) | B22 | | | |
| Others | | | | | | | | | | | | | | | | |

☆Japanese Language Course ■: Foreign students only □: EPOK students and others

| | |
|---|---|
| Course No. | 672013 |
| Course Title | Study of Japan C with SDGs |
| Instructor(Affiliation) | MOHRI Takami (67:Institute of Global Human Resource Development) |
| Term | 3rd Term |
| Day/Period | Wed5,Wed6,Wed7,Wed8 |
| Number of credits | 1 |
| Classroom | Building for General Education C31 |
| Required / Elective | |
| Contact information | E-mail: tmohri@okayama-u.ac.jp |
| Office hours | Wed 7 |
| Language | English and Japanese(Instructor mainly use Japanese) |
| Course description | <p>Study of Japan C theme : Development and Environmental protection on islands of the Seto Inland Sea.</p> <p>The series of the course is designed to enable students to learn the Japanese culture and the issues of Japanese society, the economy, and the environment with the SDGs. The aim is to develop human resources that can perceive these problems as their own, become aware of them in the process of discussions with others, and think about how to solve the problems. In this class, students will address the issues surrounding development on the beautiful islands of the Seto Inland Sea, and consider the conservation of nature and the development and sustainability of local communities and economies from the perspective of the SDGs. On a field trip, Students will visit Teshima, Naoshima or Inujima. Visit the negative heritage of the development of each island and the current facilities that have been regenerated. In addition, we will listen to the voices of the local people through interviews and think about the ideal way of sustainable development not only for the islands of Setouchi but also for your country and region. The assignment is a presentation and essay submission.</p> |
| Learning objectives | The course aims to provide opportunities to explore Okayama, and Japan from a unique angle. Students will not only learn the details of the Seto Inland Sea , but also have the opportunity to learn both the advantages and disadvantages of development and have their own opinions and visions in this course. |
| Learning outcomes | <p>Students should be able to:</p> <ol style="list-style-type: none"> 1) understand the cultural, society, and people of Okayama and Japan. 2) explain the culture and society of Japan based on the learning. 3) Understand the SDGs in the wider global context and their background Self-reflect on your values and attitudes concerning the SDGs and your community. |
| Course schedule | <p>This course consists of lectures, presentation, and field trips.</p> <ol style="list-style-type: none"> (1) Introduction: Lecture on industry and history of the Seto Inland Sea (2) Exchanging views in class discussions on SDGs Video (3) Preparing questions to ask for excursion interviews. (4) Field trip to Teshima Island. Interviewing people on excursions. (5) Field trip to Naoshima or Inujima Island. Interviewing people on excursions. (6) Group work, Preparation for Presentation (7) Presentation regarding the SDGs theme. (8) Preparing and finalizing essays for collection, Wrap-up <p>*Schedules are subject to changes</p> |
| Learning activities outside of classroom | Reading and writing on the topics is essential. |
| Teaching format-Message to the students | Students will visit Teshima, Naoshima or Inujima (Islands located on Okayama-prefecture, Kagawa-prefecture). If anyone feels they will need special assistance for the field trip, please inform the instructor during the first two weeks of classes. |
| Equipment used-Message to the students | If anyone feels they will need special assistance for their class, please inform the instructor during the first two weeks of classes. |
| Textbook | Teacher prepares materials |
| Reference material | |
| Grading | 25%: Attendance, 25%: Preparation for class/Active participation in class activities and discussion, 50%: Assignment (Final report 25%, Presentation 25%) |
| Relation to research activity | |
| Prerequisites | In class, Instructor mainly use Japanese (intermediate-low ~ Intermediate-high levels). If there is an explanation in advanced Japanese, English translation will be included. Students should check the meaning of the vocabulary before class to deepen their understanding. |
| Relation to SDGs Goals1 | 3. Good Health and Well-Bing |
| Relation to SDGs Goals2 | 4. Quality Education |
| Relation to SDGs Goals3 | 6. Clean Water and Sanitation also, No.7,9,10,11,14,15, 16,17 SDGs Coals |
| Other comments | Activity fees about 3,000 JPY/each field trip (train fares, passage fare) |

| | |
|---|--|
| Course No. | 671503 |
| Course Title | EPOK Research Project: Fall I |
| Instructor(Affiliation) | OBAYASHI Junko, INAMORI Takao, MORI Takami (67:Institute of Global Human Resource Development) |
| Term | 3rd Term |
| Day/Period | TBA 7, 8 |
| Number of credits | 1 |
| Classroom | TBA |
| Required / Elective | EPOK Certificate |
| Contact information | assigned advisor |
| Office hours | TBA |
| Language | English |
| Course description | <p>Students conduct an original research for the total duration of 16 weeks (2 semesters: EPOK Research Project I and EPOK Research Project II) to explore a topic of interest among themes and issues in the three genres of Japanese Culture, Language or Environment. Available EPOK research subjects are: 1) Culture [Japanese tradition, custom, and art], 2) Language: [Japanese language, second-language education], 3) Environment and Natural Science: [agriculture, management, developmental studies]. Students can do an independent research in the available subjects, and consult for the topic with the assigned advisor.</p> <p>In this course (I): the first half of the research project, student will learn to build a research structure, including a topic statement, literature review, and methodology, in order to outline the project. At the end of the semester student should produce a research proposal which outlines the thesis of the topic.</p> <p>(The proposal should be developed to finish as a final research paper in the following Research Project II.)</p> |
| Learning objectives | <p>The course aims to aid EPOK students to pursue independent research project on Japanese Culture, Language or Environment.</p> <p>The goal of the course (I) is to construct, proceed and outline the research to make a proposal.</p> |
| Learning outcomes | <p>The student is able to:</p> <ul style="list-style-type: none"> · Formulate a topic of interest to explore academically that encourages them to enhance an understanding of Japan. · Learn to conduct practical method of research. · Present the outline of the research. |
| Course schedule | <ul style="list-style-type: none"> · In the week-1 session (10/6-Wed 13:25-) students will exercise to formulate individual research topic. You are required to submit your choice of desirable seminar, according to which you should be assigned to the seminar . · The student will meet with the assigned seminar of the research project at least once every (two) week(s) during the semester. · At the end of the semester, students will present the research proposal. · A student should expect to spend at least 45 hours, including meetings and readings, on the project over the course of the semester for a 1.0 course credit research project. |
| Learning activities outside of classroom | Independent research with a directed review Readings, Fieldwork |
| Teaching format-Message to the students | The meeting hours of each seminar need to be scheduled with the instructor. The student will work on conducting the research individually under the direction of an assigned instructor. |
| Equipment used-Message to the students | TBA |
| Textbook | TBA |
| Reference material | |
| Grading | Participation 20%, Assignments 30%, Proposal 50% The assigned instructor will evaluate the work, including research proposal, and submit a grade at the end of the semester. |
| Relation to research activity | A good academic approach to the topic of interest, and a self-disciplined working attitude are necessary for the independent study. |
| Prerequisites | |
| Relation to SDGs Goals1 | 17.Partnerships for the Goals |
| Relation to SDGs Goals2 | |
| Relation to SDGs Goals3 | |
| Other comments | EPOK students who pursue EPOK Certificate must take this course (EPOK Research Project). Research Project may not duplicate available courses offered in the semesters |

4th Term

Course List for EPOK 2021-2022 4th Quarter

※All information listed is subject to change

| Quarter | Class Code | Classes | Timetable | | Credits | Language | Online | in-Person | Lecturer(s) | Class Room for In-person classes | ★ Approval necessary |
|---------|------------|--|-----------|---------|---------|---|--------|-----------|---------------------------|----------------------------------|----------------------|
| | | | | | | | | | | | |
| 4 | 672014 | Study of Japan D with SDGs | Wed | 5-6-7-8 | 1 | J | O | | OBAYASHI Junko | C31 | |
| 4 | 671504 | EPOK Research Project: Fall II | TBA | TBA | 1 | E | O | | IGHRAD Academic Staff | | |
| 4 | 133029 | Seminar on Statistical Science | Mon | 1-2 | 1 | E | TBA | | SAKAMOTO Wataru | B23 | ★ |
| 4 | 133067 | Inequality | Mon & Thu | 1-2 | 2 | E | TBA | | YAMAMOTO Yumiko | D13 | |
| 4 | 133005 | Globalization and Development | Mon & Thu | 3-4 | 2 | E | TBA | | MIYAGAWA Haruna | C32 | ★ |
| 4 | 133079 | Seminar in Medical Anthropology | Mon & Thu | 5-6 | 2 | E | TBA | | UESUGI Takeshi | A43 | ★ |
| 4 | 911797 | Introduction to the Seto inland sea region | Mon | 5-6 | 1 | E | TBA | | YAMAKAWA Junji | | |
| 4 | 912501 | Introduction to Emotional Intelligence | Mon | 5-6 | 1 | E | TBA | | MOHMOOD Sabina | | |
| 4 | 673132 | Language , Culture, and Social Interaction II | Mon | 7 | 0.5 | E | TBA | | NAKAMURA Ian Iseo | | |
| 4 | 911095 | International Cooperation and Project Management | Mon | 7-8 | 1 | E | O | | INAMORI Takao | D13 | |
| 4 | 911458 | English Communication: Healthy & Sustainable Societies 1 | Mon | 7-8 | 1 | E | TBA | | PRICHARD Caleb | | ★ |
| 4 | 131077 | Global Philanthropy and Comparative Nonprofit Sectors | Mon & Thu | 9-10 | 2 | E | TBA | | YOSHIOKA Takayuki | D23 | |
| 4 | 911096 | Environmental Education Methods | Tue | 5-6 | 1 | E | O | | INAMORI Takao | D25 | |
| 4 | 911029 | British and Irish Detective Fiction | Tue | 5-6 | 1 | E&J | TBA | | FOX Brian Thomas | | |
| 4 | 912108 | History of Bizen Ware and its Connoisseurship | Tue | 5-6 | 1 | E | X | O | WELLS Thomas John | | |
| 4 | 132069 | Introduction to Astrochemistry and Atmospheric Chemistry | Tue | 5-6 | 1 | E | TBA | | TANG Jian | B25 | |
| 4 | TBA | Introduction to Japanese Lexicology | Tue | 7-8 | 1 | E&J | TBA | | NAMBA Emi | TBA | |
| 4 | 912501 | Introduction to the 8 dimensions of Wellness | Tue | 7-8 | 1 | E | TBA | | MOHMOOD Sabina | | |
| 4 | 133084 | Agrochemical Bioscience 1 - Analytical Chemistry | Wed | 3-4 | 1 | E | TBA | | TAMURA Takashi and others | TBA | ★ |
| 4 | 912507 | Job Search for International Students | Wed | 5 | 0.5 | E&J (Check Syllabus for pre-requirement) | O | | UZUKA Mariko | C32 | ★ |
| 4 | 911454 | Creativity, Critical Thinking & Innovation | Wed | 7-8 | 1 | E | TBA | | KIM Dong Kwang | | |
| 4 | 131085 | Chemical Bonding and Molecular Structure | Thu | 3-4 | 1 | E | TBA | | TANG Jian | B31 | |
| 4 | 132904 | Social Issues in Contemporary Japan | Thu | 3-4 | 1 | E | TBA | | OSAWA Makoto | C21 | |

| | | | | | | | | | | | |
|-------------|--------|---|-----------|-------|-----|-----|-----|---|---------------------------|---------------|---|
| 4 | 912749 | Seminar of Sport Performance(Flying Disc) (Choose from 912749 or 912751) | Thu | 3-4 | 1 | E&J | TBA | | KOBAYASHI Yuji, | | ★ |
| 4 | 912751 | Seminar of Sport Performance(Flying Disc) (Choose from 912749 or 912751) | Thu | 5-6 | 1 | E&J | TBA | | KOBAYASHI Yuji, | | ★ |
| 4 | 911083 | Chado: Mind and Practice | Thu | 5-6 | 1 | E&J | TBA | | OBAYASHI Junko | Kuwanoki Dorm | |
| 4 | 131051 | Introduction to Agricultural Sciences | Thu | 5-6-7 | 1.5 | | TBA | | HIRA Yoshihiko and others | | ★ |
| 4 | 912035 | Servant Leadership 2 | Fri | 5-6 | 1 | E | ○ | ○ | ISHIDA Mamoru | | |
| 4 | 911094 | Japanese Language Education in a Global Society | Fri | 5-6 | 1 | J&E | TBA | | MOHRI Takami | A31 | |
| 4 | 131086 | Fundamentals of Chemistry | Fri | 5-6 | 1 | E | TBA | | UDDIN Azhar | B31 | ★ |
| 4 | 131042 | Introduction to Macroeconomics | Fri | 5-6 | 1.5 | E | TBA | | YAMAMOTO Yumiko | D25 | |
| 4 Intensive | 912006 | This is Okayama 2 | Intensive | | 1 | E&J | ○ | | FUJIMOTO Masumi | | ★ |

| Quarter | Class Code | Classes | Timetable | Credits | Language | Online | in-Person | Lecturer(s) | Class Room for In-person classes |
|---------|------------|---|------------------------------|---------|----------|--------|-----------|-------------|----------------------------------|
| 4 | | Japanese1-1(A) (Placement Test Score 0-30) | Mon, Tue, Thu, Fri | 1-2 | 4 | J | TBA | TBA | |
| 4 | | Japanese1-1(B) (Placement Test Score 0-30) | Mon, Tue, Wed, Thu | 1-2 | 4 | J | TBA | TBA | |
| 4 | | Japanese1-1(C) (Placement Test Score 0-30) | Mon, Tue, Wed, Thu | 3-4 | 4 | J | TBA | TBA | |
| 4 | | Japanese2-1 (A) (Placement Test Score 31-47) | Tue, Wed, Thu, | 1-2 | 4 | J | TBA | TBA | |
| 4 | | Japanese2-1 (B) (Placement Test Score 31-47) | Mon, Tue, Wed, Thu | 1-2 | 4 | J | TBA | TBA | |
| 4 | | Japanese3-1 (A) (Placement Test Score 48-58) | Mon, Tue, Thu, Fri | 3-4 | 4 | J | TBA | TBA | |
| 4 | | Japanese3-1 (B) (Placement Test Score 48-58) | Mon, Wed, Thu, Fri | 3-4 | 4 | J | TBA | TBA | |
| 4 | | Japanese4-1 (Placement Test Score 59-68) | Tue, Wed, Thu, Fri | 3-4 | 4 | J | TBA | TBA | |
| 4 | | Japanese5-1 (Placement Test Score 69-74) | Mon, Tue, Wed, Thu, | 1-2 | 4 | J | TBA | TBA | |
| 4 | | Japanese6-1 (Placement Test Score 75-82) | Mon, Tue, Thu, Fri | 1-2 | 4 | J | TBA | TBA | |
| 4 | | Applied Japanese (Listening B) (Placement Test Score 83-100) | Fri | 1-2 | 1 | J | TBA | TBA | |
| 4 | | Applied Japanese (Writing A) (Placement Test Score 83-100) | Mon | 3-4 | 1 | J | TBA | TBA | |
| 4 | | Applied Japanese (Speaking A) (Placement Test Score 83-100) | Thu | 3-4 | 1 | J | TBA | TBA | |
| 4 | | Applied Japanese (Reading B) (Placement Test Score 83-100) | Tue | 5-6 | 1 | J | TBA | TBA | |

| | | | | | | | | | | |
|---|--|---|-----------------|-----|---|---|-----|--|-----|--|
| 4 | | Japanese through Films 1-1 (Placement Test Score 48-68) | Fri | 7-8 | 1 | J | TBA | | TBA | |
| 4 | | Japanese through Films 2-1 (Placement Test Score 69-100) | Fri | 5-6 | 1 | J | TBA | | TBA | |
| 4 | | Extensive Reading 1-1 (Placement Test Score 48-74) | Fri | 5-6 | 1 | J | TBA | | TBA | |
| 4 | | Extensive Reading 2-1 (Placement Test Score 75-100) | Wed | 3-4 | 1 | J | TBA | | TBA | |
| 4 | | Intermediate Kanji and Vocabulary (Placement Test Score 59-74) | Mon | 3-4 | 1 | J | TBA | | TBA | |
| 4 | | Intermediate Grammar 1-1 (Placement Test Score 48-68) | Wed | 5-6 | 1 | J | TBA | | TBA | |
| 4 | | Intermediate Grammar 2-1 (Placement Test Score 69-100) | Tue | 3-4 | 1 | J | TBA | | TBA | |
| 4 | | Study of Okayama (Placement Test Score 69-100) | Fri | 3-4 | 1 | J | TBA | | TBA | |
| 4 | | Reading and Writing 1-1(A) (Placement Test Score 0-47) | Mon & Thu | 5-6 | 2 | J | TBA | | TBA | |
| 4 | | Reading and Writing 1-1(B) (Placement Test Score 0-47) | Tue & Fri | 5-6 | 2 | J | TBA | | TBA | |
| 4 | | Reading and Writing 2-1(A) (Placement Test Score 31-58) | Tue & Thu | 5-6 | 2 | J | TBA | | TBA | |
| 4 | | Reading and Writing 2-1(B) (Placement Test Score 31-58) | Tue & Fri | 5-6 | 2 | J | TBA | | TBA | |
| 4 | | Japanese Through New and magazine Articles (Placement Test Score 59-74) | Tue | 5-6 | 1 | J | TBA | | TBA | |
| 4 | | Media Literacy (Placement Test Score 74-100) | Thu | 5-6 | 1 | J | TBA | | TBA | |

| | | | | | | | | | | | | | |
|---|---|--------|--------------------------------------|-----|--------------------------------|--|---------------------------|-----------------|---------------------------|--|---------------------------|--|-----|
| 5P & 6P 5P:13:25-14:15 6P:14:25-15:15 | ☆Reading and Writing 1(A) | C23 | ☆Reading and Writing 1(B) | C23 | ☆Intermediate Grammar 1 | B22 | ☆Reading and Writing 1(A) | C23 | ☆Reading and Writing 1(B) | C23 | ☆Reading and Writing 1(B) | C23 | |
| | ☆Reading and Writing 2(A) | C12 | ☆Reading and Writing 2(B) | C12 | ■Study of Japan D with SDGs | C31 | ☆Reading and Writing 2(A) | C12 | ☆Reading and Writing 2(B) | C12 | ☆Reading and Writing 2(B) | C11 | |
| 7P & 8P 7P:15:30-16:20 8P:16:30-17:20 | ☆Japanese through News and Magazine Articles | B22 | ☆Applied Japanese (Reading B) | C24 | 911096 | ☆Japanese through News and Magazine Articles | B22 | ☆Media Literacy | B22 | ☆Extensive Reading 1 | C24 | ☆Japanese through Films 2 | B22 |
| | ☆Environmental Education Methods | D25 | □Introduction to Japanese Lexicology | TBA | | □Chado: Mind and practice | 911083 | □Kuwa noki-Dorm | 911083 | □Japanese Language Education in a Global Society | 911094 | □Japanese Language Education in a Global Society | A31 |
| Others | □Language, Culture, and Social Interaction II (7P only) | 673132 | TBA | TBA | 672014 | ■Study of Japan D with SDGs | C31 | | | | ☆Japanese through Films 1 | C24 | |
| | 671504 ■EPOK Research Project: Fall II | | | | | | | | | | | | |
| Intensive course | | | | | | | | | | | | | |

| | |
|---|---|
| Course No. | 672014 |
| Course Title | Study of Japan D with SDGs |
| Instructor(Affiliation) | OBAYASHI Junko (67:Institute of Global Human Resource Development) |
| Term | 4th Term |
| Day/Period | Wed5,Wed6,Wed7,Wed8 |
| Number of credits | 1 |
| Classroom | Building for General Education C31 |
| Required / Elective | |
| Contact information | Room:General Education Building 3rd Floor C309 E-mail: j_obayashi@okayama-u.ac.jp Tel: 086-251-8935 |
| Office hours | TBA |
| Language | Japanese |
| Course description | <p>The series of the course is designed to enable students to learn about Japanese culture, the issues of Japanese society and the environment especially with a perspective of the SDGs. Students are expected not only to learn about the past (history) and present status of Things Japanese, but also to understand the process, meaning, and role of the sustaining cultures of Japan.</p> <p>The course intends to provide first-hand opportunities for students to explore Okayama and Japan from a unique angle of SDGs.</p> <p>This course focuses tradition and challenges around the Japanese Food culture, production and consumption of food, in order to explore the issue of cultural, social sustainability of the core human necessity of Food in Japan. Guest lecture, visitation of factories are planned.</p> <p>(The course intends to use Japanese as the primary language.)</p> |
| Learning objectives | <p>Students should be able to:</p> <ol style="list-style-type: none"> 1) Understand the cultural, society, and environment of Okayama and Japan. 2) Explain the culture and society of Japan based on the learning. 3) Reflect on an economic development on a local level with the understanding of the SDGs. |
| Learning outcomes | <p>The students should :</p> <p>Learn about the role of the fermented food as the basic of the tradition of Japanese cooking.</p> <p>Understand the advantage and problems of the Japanese Food production.</p> <p>Propose an idea for a sustainable food cultures in Japan.</p> |
| Course schedule | <ol style="list-style-type: none"> (1)Introduction: Overviewing the course, Tradition and Issues around Japanese Food for SDGs? (2)Food Production: Tradition and Issues (3)Field (Growing Rice) (4)Japanese Food: Traditional Cooking, Fermented Food (5)Field (Fermenting Rice?) (6)Consumption: Issues (7)Field (Re-cycling food) (8)(Group) Presentations |
| Learning activities outside of classroom | <p>Reading and writing on the topics is essential.</p> <p>Students will review the materials covered in the previous weeks. Students are encouraged to read newspapers/ magazines articles relevant to this course and share them in the class. Students' active participation is highly expected.</p> |
| Teaching format-Message to the students | <p>Lecture, Discussion, Fieldwork</p> <p>Depending on the circumstance, all the sessions needs to be conducted online including the fieldtrips which may be substituted with non-field activities.</p> |
| Equipment used-Message to the students | <p>If anyone feels they will need special assistance for this class, please inform the instructor during the first two weeks of class.</p> |
| Textbook | No textbook |
| Reference material | If any, handout will be provided in the class. |
| Grading | Attendance 25%, Participation 25%, Final Assignment 50% |
| Relation to research activity | |
| Prerequisites | You need to be punctual for the class activities |
| Relation to SDGs Goals1 | |
| Relation to SDGs Goals2 | |
| Relation to SDGs Goals3 | |
| Other comments | <p>The course will be online (not in-person.) The interactive activities including fieldtrips and interview, needs to be canceled.</p> <p>Japanese is primarily used in the course.</p> <p>N/A: Activity fee is required if in-person. (TBA, To be collected at the beginning of the course.)</p> |

| | |
|---|---|
| Course No. | 671504 |
| Course Title | EPOK Research Project:Fall II |
| Instructor(Affiliation) | OBAYASHI Junko, INAMORI Takao, MORI Takami (67:Institute of Global Human Resource Development) |
| Term | 4 th Term |
| Day/Period | TBA 7, 8 |
| Number of credits | 1 |
| Classroom | TBA |
| Required / Elective | EPOK Certificate |
| Contact information | assigned advisor |
| Office hours | TBA |
| Language | English |
| Course description | <p>Research Project (II) indicates the research conducted in the previous semester will be brushed up to conclude as a final research essay in the course.</p> <p>The work will include completing the fieldwork, compiling and analyzing the data, concluding the findings possibly with suggestions for future research in the thesis. The essay of approximately 3000wds needs to be written according to the requested format, including tables and photos. The student needs to work on a short writing of the abstract in Japanese (if the essay is written in English).</p> <p>At the end of the course, the students will make a presentation based on the research essay. (EPOK Research Presentation session)</p> |
| Learning objectives | <p>The course aims to aid EPOK students to:</p> <ul style="list-style-type: none"> · Pursue independent research interest in Japanese culture, language or environment/science. · Write academically to produce a research essay. · Organize and present effectively the research outcome. |
| Learning outcomes | <p>The student is able to:</p> <p>Complete a task to write a research essay as the final product of the research.</p> <p>Learn to organize and present a research paper.</p> <p>Obtain the further understanding of the topic in Japanese culture, society and environment, and Explain them with their own words.</p> |
| Course schedule | <ul style="list-style-type: none"> · The student will meet with the assigned instructor of the research project at least once every (two) week(s) during the semester. · The student will complete the writing to submit by the deadline. · The student will present the final essay at a session for a research presentation to be scheduled in the final week of the semester. (1/26-Wed 15:30-) · Essay Submission Due (2/2-Wed 17:00) |
| Learning activities outside of classroom | Independent research with directed review |
| Teaching format-Message to the students | The meeting hours need to be scheduled with the instructor. The student will work on conducting the research individually under the direction of an assigned instructor. |
| Equipment used-Message to the students | TBA |
| Textbook | TBA |
| Reference material | |
| Grading | <p>Participation 15%, Presentation 35%, Final product 50%</p> <p>The assigned instructor will evaluate the work of the semester including a final essay, and the final presentation with the total evaluations of the contributing instructors, in order to submit a final grade. Participation evaluates the organization and participation in pursuing the research through the semester.</p> |
| Relation to research activity | A good academic approach to the topic of interest, and a self-disciplined working attitude are necessary for the independent study. |
| Prerequisites | EPOK Research I |
| Relation to SDGs Goals1 | 4. Quality Education |
| Relation to SDGs Goals2 | 17.Partnerships for the Goals |
| Relation to SDGs Goals3 | |
| Other comments | <p>EPOK students who pursue EPOK Certificate must take this course (EPOK Research Project I and II).</p> <p>Prerequisite: EPOK Research Project Fall I</p> <p>Research Project may not duplicate available courses offered in the semesters.</p> |

About Japanese Language Course

Visit Japanese Language web site to see how to take
Placement test and other information.

On the site, English translation follows Japanese.

<https://bit.ly/38cNs2o>

Things to do before classes start for those taking the Okayama University Japanese Language Course for the first time

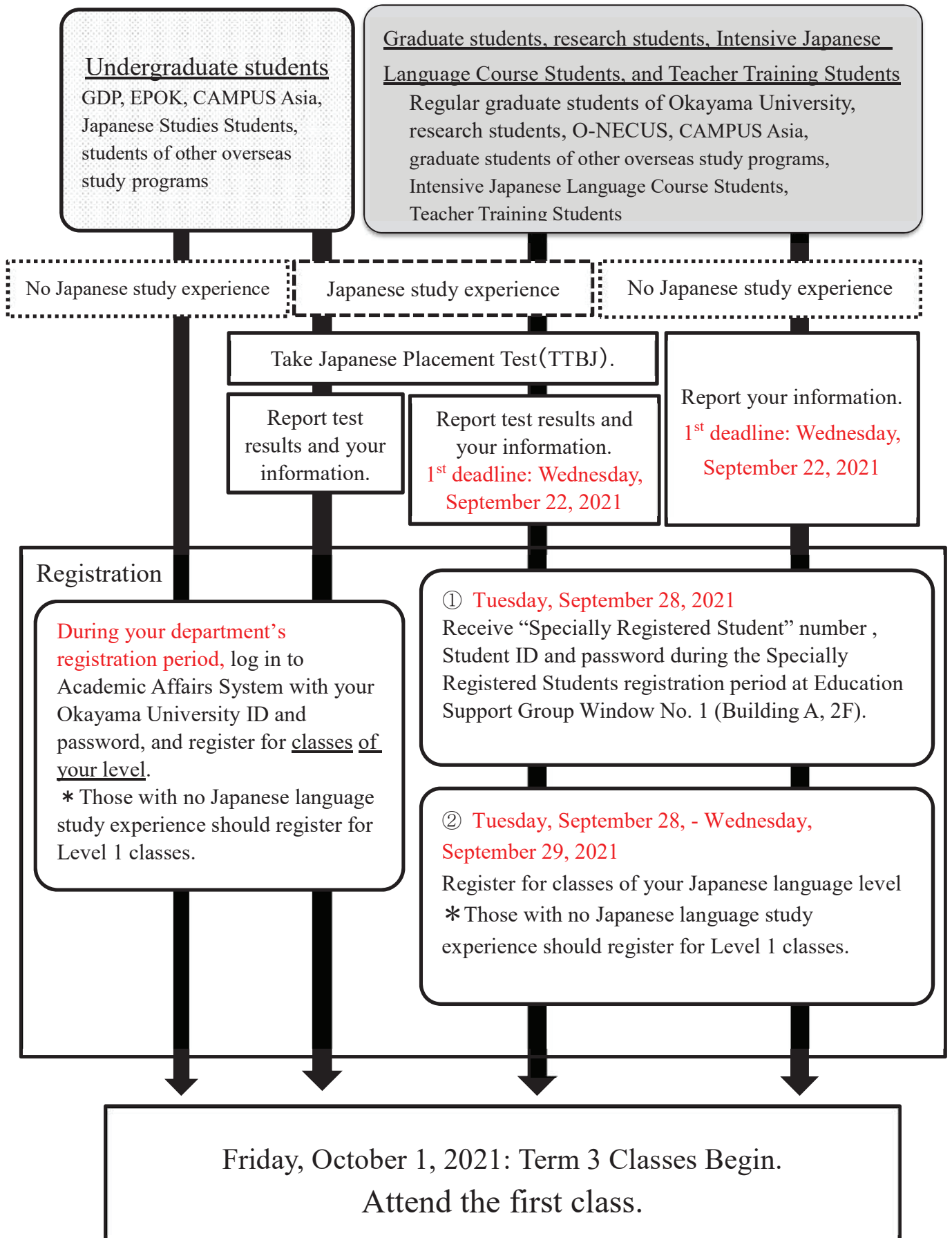

全学日本語コース 時間割表 -2021年度第3,4学期-
Japanese Language Course (Third and Fourth Term, 2021)

- ❖ 授業は1コマ 50 分です。全学日本語コースの授業は 50 分連続2コマで行われます。
- ❖ One class segment is 50 minutes.
The Japanese Language Course classes are made up of two consecutive 50-minute segments.

レベル 1 (Level 1) 日本語プレースメントテストの「日本語力の総合スコア」(点) 0 点～30 点

Japanese Score on a Placement Test 0-30

| | 月 Mon. | | 火 Tue. | | 水 Wed. | 木 Thu. | | 金 Fri. | |
|------------------|--|-------------------------|--|-------------------------|----------------------------------|--|-------------------------|--|--|
| 1 8:40-9:30 | 日本語 1(A) | 日本語 1(B) | 日本語 1(A) | 日本語 1(B) | 日本語 1(B) Japanese 1(B) C23 | 日本語 1(A) | 日本語 1(B) | 日本語 1(A) Japanese 1(A) C24 | |
| 2 9:40-10:30 | Japanese 1(A) C21 | Japanese 1(B) C23 | Japanese 1(A) C21 | Japanese 1(B) C23 | | Japanese 1(A) C24 | Japanese 1(B) C23 | | |
| 3 10:45-11:35 | 日本語 1(C) Japanese 1(C) C12 | | 日本語 1(C) Japanese 1(C) C12 | | 日本語 1(C) Japanese 1(C) C12 | 日本語 1(C) Japanese 1(C) C12 | | | |
| 4 11:45-12:35 | | | | | | | | | |
| 5 13:25-14:15 | 読み書き 1(A) Reading and Writing 1(A) C23 | | 読み書き 1(B) Reading and Writing 1(B) C23 | | | 読み書き 1(A) Reading and Writing 1(A) C23 | | 読み書き 1(B) Reading and Writing 1(B) C23 | |
| 6 14:25-15:15 | | | | | | | | | |

※日本語 1(A),日本語 1(B),日本語 1(C)は同じ内容です。これらの中から一つ、希望するクラスを選んでください。

Japanese 1(A), Japanese 1(B) and Japanese 1(C) have the same content. Please select one of these.

※読み書き 1(A)と読み書き 1(B)は同じ内容です。どちらか一つ、希望するクラスを選んでください。

Reading and Writing 1(A) and Reading and Writing 1(B) have the same content. Please select either one.

レベル 2 (Level 2) 日本語プレースメントテストの「日本語力の総合スコア」(点) 31 点～47 点

Japanese Score on a Placement Test 31-47

| | 月 Mon. | 火 Tue. | | 水 Wed. | | 木 Thu. | | 金 Fri. | |
|------------------|--|--|--|--|----------------------------------|--|--|--|--|
| 1 8:40-9:30 | | 日本語 2(A) Japanese 2(A) C11 | 日本語 2(B) Japanese 2(B) C12 | 日本語 2(A) Japanese 2(A) C11 | 日本語 2(B) Japanese 2(B) C12 | 日本語 2(A) Japanese 2(A) C11 | 日本語 2(B) Japanese 2(B) C12 | 日本語 2(A) Japanese 2(A) C11 | 日本語 2(B) Japanese 2(B) C12 |
| 2 9:40-10:30 | | | | | | | | | |
| 3 10:45-11:35 | | | | | | | | | |
| 4 11:45-12:35 | | | | | | | | | |
| 5 13:25-14:15 | 読み書き 1(A) Reading and Writing 1(A) C23 | 読み書き 1(B) Reading and Writing 1(B) C23 | 読み書き 2(A) Reading and Writing 2(A) C12 | 読み書き 2(B) Reading and Writing 2(B) C11 | | 読み書き 1(A) Reading and Writing 1(A) C23 | 読み書き 2(A) Reading and Writing 2(A) C12 | 読み書き 1(B) Reading and Writing 1(B) C23 | 読み書き 2(B) Reading and Writing 2(B) C11 |
| 6 14:25-15:15 | | | | | | | | | |

※日本語 2(A),日本語 2(B)は同じ内容です。どちらか一つ、希望するクラスを選んでください。

Japanese 2(A) and Japanese 2(B) have the same content. Please select either one.

※読み書き 1(A)と読み書き 1(B)は同じ内容です。どちらか一つ、希望するクラスを選んでください。

Reading and Writing 1(A) and Reading and Writing 1(B) have the same content. Please select either one.

※読み書き 2(A)と読み書き 2(B)は同じ内容です。どちらか一つ、希望するクラスを選んでください。

Reading and Writing 2(A) and Reading and Writing 2(B) have the same content. Please select either one.

レベル 3 (Level 3) 日本語プレースメントテストの「日本語力の総合スコア」(点) 48 点～58 点

Japanese Score on a Placement Test 48-58

| | 月 Mon. | 火 Tue. | | 水 Wed. | 木 Thu. | | 金 Fri. | | |
|------------------|--|--|--|--|--|--|---|--|---|
| 1 8:40-9:30 | | | | | | | | | |
| 2 9:40-10:30 | | | | | | | | | |
| 3 10:45-11:35 | 日本語 3(A) Japanese 3(A) C23 | 日本語 3(B) Japanese 3(B) C11 | 日本語 3(A) Japanese 3(A) C23 | 日本語 3(B) Japanese 3(B) C11 | 日本語 3(A) Japanese 3(A) C23 | 日本語 3(B) Japanese 3(B) C11 | 日本語 3(A) Japanese 3(A) C23 | 日本語 3(B) Japanese 3(B) C11 | |
| 4 11:45-12:35 | | | | | | | | | |
| 5 13:25-14:15 | | | 読み書き 2(A) Reading and Writing 2(A) C12 | 読み書き 2(B) Reading and Writing 2(B) C11 | 中級文法 1 Intermediate Grammar 1 B22 | 読み書き 2(A) Reading and Writing 2(A) C12 | | 読み書き 2(B) Reading and Writing 2(B) C11 | 多読で学ぶ 日本語 1 Extensive Reading 1 C24 |
| 6 14:25-15:15 | | | | | | | | | |
| 7 15:30-16:20 | | | | | | | 映像で学ぶ日本語 1 Japanese through Films 1 C24 | | |
| 8 16:30-17:20 | | | | | | | | | |

※日本語 3(A)と日本語 3(B)は同じ内容です。どちらか一つ、希望するクラスを選んでください。

Japanese 3(A) and Japanese 3(B) have the same content. Please select either one.

※読み書き 2(A)と読み書き 2(B)は同じ内容です。どちらか一つ、希望するクラスを選んでください。

Reading and Writing 2(A) and Reading and Writing 2(B) have the same content. Please select either one.

レベル 4 (Level 4) 日本語プレースメントテストの「日本語力の総合スコア」(点) 59 点～68 点

Japanese Score on a Placement Test 59-68

| | 月 Mon. | 火 Tue. | 水 Wed. | 木 Thu. | 金 Fri. |
|------------------|--|--|---|----------------------------|---|
| 1 8:40-9:30 | | | | | |
| 2 9:40-10:30 | | | | | |
| 3 10:45-11:35 | 中級漢字・語彙 Intermediate Kanji and Vocabulary C24 | 日本語 4 Japanese 4 B22 | 日本語 4 Japanese 4 B22 | 日本語 4 Japanese 4 C24 | 日本語 4 Japanese 4 B22 |
| 4 11:45-12:35 | | | | | |
| 5 13:25-14:15 | | 新聞・雑誌で学ぶ日本語 Japanese through News and Magazine Articles B22 | 中級文法 1 Intermediate Grammar 1 B22 | | 多読で学ぶ日本語 1 Extensive Reading 1 C24 |
| 6 14:25-15:15 | | | | | |
| 7 15:30-16:20 | | | | | 映像で学ぶ日本語 1 Japanese through Films 1 C24 |
| 8 16:30-17:20 | | | | | |

レベル 5 (Level 5) 日本語プレースメントテストの「日本語力の総合スコア」(点) 69 点～74 点

Japanese Score on a Placement Test 69-74

| | 月 Mon. | 火 Tue. | 水 Wed. | 木 Thu. | 金 Fri. |
|------------------|--|--|----------------------------|-------------------------------------|---|
| 1 8:40-9:30 | 日本語 5 Japanese 5 B22 | 日本語 5 Japanese 5 B22 | 日本語 5 Japanese 5 B22 | 日本語 5 Japanese 5 B22 | |
| 2 9:40-10:30 | | | | | |
| 3 10:45-11:35 | 中級漢字・語彙 Intermediate Kanji and Vocabulary C24 | 中級文法 2 Intermediate Grammar 2 C24 | | | 岡山を知ろう Study of Okayama C24 |
| 4 11:45-12:35 | | | | | |
| 5 13:25-14:15 | | 新聞・雑誌で学ぶ 日本語 Japanese through News and Magazine Articles B22 | | メディア・リテラシー Media Literacy B22 | 多読で学ぶ 日本語 1 Extensive Reading 1 C24 |
| 6 14:25-15:15 | | | | | |

レベル 6 (Level 6) 日本語プレースメントテストの「日本語力の総合スコア」(点) 75 点～82 点

Japanese Score on a Placement Test 75-82

| | 月 Mon. | 火 Tue. | 水 Wed. | 木 Thu. | 金 Fri. |
|------------------|----------------------------|---|--|-------------------------------------|---|
| 1 8:40-9:30 | 日本語 6 Japanese 6 C24 | 日本語 6 Japanese 6 C24 | | 日本語 6 Japanese 6 C21 | 日本語 6 Japanese 6 C21 |
| 2 9:40-10:30 | | | | | |
| 3 10:45-11:35 | | 中級文法 2 Intermediate Grammar 2 C24 | 多読で学ぶ日本語 2 Extensive Reading 2 C24 | | 岡山を知ろう Study of Okayama C24 |
| 4 11:45-12:35 | | | | | |
| 5 13:25-14:15 | | | | メディア・リテラシー Media Literacy B22 | 映像で学ぶ日本語 2 Japanese through Films 2 B22 |
| 6 14:25-15:15 | | | | | |

レベル 7 (Level 7) 日本語プレースメントテストの「日本語力の総合スコア」(点) 83 点～100 点

Japanese Score on a Placement Test 83-100

| | 月 Mon. | 火 Tue. | 水 Wed. | 木 Thu. | 金 Fri. |
|------------------|---|---|--|--|---|
| 1 8:40-9:30 | | | | | 応用日本語(聞く B) Applied Japanese (Listening B) B22 |
| 2 9:40-10:30 | | | | | |
| 3 10:45-11:35 | 応用日本語(書く A) Applied Japanese (Writing A) B22 | 中級文法 2 Intermediate Grammar 2 C24 | 多読で学ぶ日本語 2 Extensive Reading 2 C24 | 応用日本語(話す A) Applied Japanese (Speaking A) B22 | 岡山を知ろう Study of Okayama C24 |
| 4 11:45-12:35 | | | | | |
| 5 13:25-14:15 | | 応用日本語(読む B) Applied Japanese (Reading B) C24 | | メディア・リテラシー Media Literacy B22 | 映像で学ぶ日本語 2 Japanese through Films 2 C24 |
| 6 14:25-15:15 | | | | | |

Registration Forms

2021-2022 EPOK Registration Memo 1st Term

➤ Highlight classes you take in yellow

➤ Mark if approval Necessary

☆ Japanese Language Course

NAME:

E-mail:

| | Monday | | Tuesday | | Wednesday | | Thursday | | Friday | |
|--|---------------------------------------|--|-------------------------------|---|-------------------------------|-------------------------------|-------------------------------|---|---------------------------------|--|
| | Class Code | Classes | Class Code | Classes | Class Code | Classes | Class Code | Classes | Class Code | Classes |
| 1P & 2P 1P:8:40-9:30 2P:9:40-10:30 | ☆Japanese1 | ☆Japanese1 | ☆Japanese1 | ☆Japanese1 | ☆Japanese1 | ☆Japanese1 | ☆Japanese1 | ☆Japanese1 | ☆Japanese2(A) | ☆Japanese2(A) |
| | ☆Japanese2(B) | ☆Japanese2(A) | ☆Japanese2(A) | ☆Japanese2(A) | ☆Japanese2(A) | ☆Japanese2(A) | ☆Japanese2(A) | ☆Japanese2(A) | ☆Japanese2(A) | ☆Japanese2(A) |
| | ☆Japanese5 | ☆Japanese2(B) | ☆Japanese2(B) | ☆Japanese2(B) | ☆Japanese2(B) | ☆Japanese2(B) | ☆Japanese2(B) | ☆Japanese2(B) | ☆Japanese2(B) | ☆Japanese2(B) |
| | ☆Japanese6 | ☆Japanese5 | ☆Japanese5 | ☆Japanese5 | ☆Japanese5 | ☆Japanese5 | ☆Japanese5 | ☆Japanese5 | ☆Japanese5 | ☆Applied Japanese (Speaking B) |
| | | ☆Japanese6 | ☆Japanese6 | ☆Japanese6 | ☆Japanese6 | ☆Japanese6 | ☆Japanese6 | ☆Japanese6 | ☆Japanese6 | ☆Japanese6 |
| | | ☆Japanese3(A) | ☆Japanese3(A) | ☆Japanese3(A) | ☆Japanese3(A) | ☆Japanese3(A) | ☆Japanese3(A) | ☆Japanese3(A) | ☆Japanese3(A) | ☆Japanese3(A) |
| 3P & 4P 3P:10:40-11:35 4P:11:40-12:35 | ☆Japanese3(B) | ☆Japanese4 | ☆Japanese4 | ☆Japanese4 | ☆Japanese4 | ☆Japanese4 | ☆Japanese4 | ☆Japanese4 | ☆Japanese3(B) | ☆Japanese3(B) |
| | ☆Intermediate Kanji and Vocabulary | ☆Applied Japanese (Writing B) | ☆Applied Japanese (Writing B) | ☆Applied Japanese (Writing B) | ☆Applied Japanese (Writing B) | ☆Applied Japanese (Writing B) | ☆Applied Japanese (Writing B) | ☆Applied Japanese (Writing B) | ☆Japanese4 | ☆Japanese4 |
| | ☆Applied Japanese (Reading A) | | | | | | | | ☆Applied Japanese (Listening A) | ☆Japanese through Films2 |
| 5P & 6P 5P:13:25-14:15 6P:14:25-15:15 | ☆Reading and Writing 1 | ☆Intermediate Grammar1 | ☆Intermediate Grammar1 | ☆Intermediate Grammar1 | ☆Intermediate Grammar1 | ☆Intermediate Grammar1 | ☆Intermediate Grammar1 | ☆Intermediate Grammar1 | ☆Extensive Reading 2 | ☆Extensive Reading 2 |
| | | ☆Reading and Writing 2 | ☆Reading and Writing 2 | ☆Reading and Writing 2 | ☆Reading and Writing 2 | ☆Reading and Writing 2 | ☆Reading and Writing 2 | ☆Reading and Writing 2 | ☆Japanese through Films1 | ☆Japanese through Films1 |
| | | ☆Japanese Culture and Society | ☆Japanese Culture and Society | ☆Japanese Culture and Society | ☆Japanese Culture and Society | ☆Japanese Culture and Society | ☆Japanese Culture and Society | ☆Intermediate Grammar2 | 911085 | Introduction to Japanology |
| 7P & 8P 7P:15:30-16:20 8P:16:30-17:20 | 673121 | Intercultural Communication I | 911082 | Comparative Education as Social Science I | 672001 | Study of Japan A with SDGs | 673113 | Foreign Perspectives of Japan through Documentaries | 673141 | Model United Nations Preparation Class |
| | 911081 | Japanese Agriculture and Rural Society | | | | | | | | |
| Others | 671501EPOK Research Project: Spring I | | | | | | | | | |
| Intensive course | | | | | | | | | | |

2021-2022 EPOK Registration Memo 2nd Term

➤ Highlight classes you take in yellow
➤ If the class you take is not on the list, type it in and highlight yellow.

➤ Mark if approval Necessary

☆ Japanese Language Course

E-mail:

NAME:

| | Monday | | Tuesday | | Wednesday | | Thursday | | Friday | |
|--|---|---|---|---|---|--|--|--|--|--|
| | Class Code | Classes | Class Code | Classes | Class Code | Classes | Class Code | Classes | Class Code | Classes |
| 1P & 2P 1P:8:40-9:30 2P:9:40-10:30 | ☆ Japanese 1 ☆ Japanese 2(B) ☆ Japanese 5 ☆ Japanese 6 | ☆ Japanese 1 ☆ Japanese 2(A) ☆ Japanese 2(B) ☆ Japanese 5 ☆ Japanese 6 | ☆ Japanese 1 ☆ Japanese 2(A) ☆ Japanese 2(B) ☆ Japanese 5 ☆ Japanese 6 | ☆ Japanese 1 ☆ Japanese 2(A) ☆ Japanese 2(B) ☆ Japanese 5 ☆ Japanese 6 | ☆ Japanese 1 ☆ Japanese 2(A) ☆ Japanese 2(B) ☆ Japanese 5 ☆ Japanese 6 | ☆ Japanese 1 ☆ Japanese 2(A) ☆ Japanese 2(B) ☆ Japanese 5 ☆ Japanese 6 | ☆ Japanese 1 ☆ Japanese 2(A) ☆ Japanese 2(B) ☆ Japanese 5 ☆ Japanese 6 | ☆ Japanese 1 ☆ Japanese 2(A) ☆ Japanese 2(B) ☆ Japanese 5 ☆ Japanese 6 | ☆ Japanese 2(A) ☆ Japanese 6 ☆ Applied Japanese (Speaking B) | ☆ Japanese 2(A) ☆ Japanese 6 ☆ Applied Japanese (Speaking B) |
| 3P & 4P 3P:10:40-11:35 4P:11:40-12:35 | ☆ Japanese 3(A) ☆ Japanese 3(B) ☆ Intermediate Kanji and Vocabulary ☆ Applied Japanese (Reading A) | ☆ Japanese 3(A) ☆ Japanese 4 ☆ Applied Japanese (Writing B) | ☆ Japanese 3(A) ☆ Japanese 4 ☆ Applied Japanese (Writing B) | ☆ Japanese 3(A) ☆ Japanese 4 ☆ Applied Japanese (Writing B) | ☆ Japanese 3(A) ☆ Japanese 4 ☆ Applied Japanese (Writing B) | ☆ Japanese 3(A) ☆ Japanese 4 ☆ Applied Japanese (Listening A) | ☆ Japanese 3(A) ☆ Japanese 3(B) Japanese 4 ☆ Applied Japanese (Listening A) | ☆ Japanese 3(A) ☆ Japanese 3(B) Japanese 4 ☆ Applied Japanese (Listening A) | ☆ Japanese 3(A) ☆ Japanese 3(B) ☆ Japanese 4 ☆ Japanese through Films 2 | ☆ Japanese 3(A) ☆ Japanese 3(B) ☆ Japanese 4 ☆ Japanese through Films 2 |
| 5P & 6P 5P:13:25-14:15 6P:14:25-15:15 | ☆ Reading and Writing 1 | ☆ Intermediate Grammar 1 ☆ Reading and Writing 2 ☆ Japanese Culture and Society | ☆ Intermediate Grammar 1 ☆ Reading and Writing 2 ☆ Japanese Culture and Society | ☆ Intermediate Grammar 1 ☆ Reading and Writing 2 ☆ Japanese Culture and Society | ☆ Intermediate Grammar 1 ☆ Reading and Writing 2 ☆ Japanese Culture and Society | 672012 Study of Japan B with SDGs | ☆ Reading and Writing 1 ☆ Reading and Writing 2 ☆ Intermediate Grammar 2 Introduction to Area Studies on Hawaii I | ☆ Reading and Writing 1 ☆ Reading and Writing 2 ☆ Intermediate Grammar 2 Introduction to Area Studies on Hawaii I | ☆ Extensive Reading 2 ☆ Japanese through Films 1 | ☆ Extensive Reading 2 ☆ Japanese through Films 1 |
| 7P & 8P 7P:15:30-16:20 8P:16:30-17:20 | 673122 Intercultural Communication II (7th P only) 911086 Area Studies: Approaches and Methodologies | 911087 Comparative Education as Social Science II | 911087 Comparative Education as Social Science II | 911087 Comparative Education as Social Science II | 911087 Comparative Education as Social Science II | 672012 Study of Japan B with SDGs | | | | |
| Others | 671502 EPOK Research Project: Spring II | | | | | | | | | |
| Intensive course | | | | | | | | | | |

Study Japan EPOK Certificate: Yes fill in ↓ No

| | |
|---|----------|
| Course Credit Check List(Expected) 1+2 Term | |
| Japanese language (4) | |
| EPOK Research Project (I&II) (2) | |
| Others | |
| Total | 0 |

(15 credits or above)

(1 and 2 Term) Total Credits:

Approval: EPOK Advisor's Signature : _____
Date _____

Note: You need to submit Registration memo to EPOK Advisor by April 3rd (Sat)

After you received approval from EPOK Advisor, you need to register courses from Academic Affairs System by April 7th(Wed)

2021-2022 EPOK Course Schedule Changes(Drop) 1st Term

Name: _____ Student ID Number: _____ E-mail: _____

★ Japanese Language Course
 ➤ Highlight classes you take in yellow
 ➤ If the class you take is not on the list, type it in and highlight yellow.

➤ Mark if approval Necessary ◆ Fill in your final course schedule

| | Monday | | Tuesday | | Wednesday | | Thursday | | Friday | |
|--|---|--|--|--|--|--|--|--|---|---|
| | Class Code | Classes | Class Code | Classes | Class Code | Classes | Class Code | Classes | Class Code | Classes |
| 1P & 2P 1P:8:40-9:30 2P:9:40-10:30 | ☆Japanese1 | ☆Japanese1 | ☆Japanese1 | ☆Japanese1 | ☆Japanese1 | ☆Japanese1 | ☆Japanese1 | ☆Japanese1 | ☆Japanese2(A) | ☆Japanese2(A) |
| | ☆Japanese2(B) | ☆Japanese2(A) | ☆Japanese2(A) | ☆Japanese2(A) | ☆Japanese2(A) | ☆Japanese2(A) | ☆Japanese2(A) | ☆Japanese2(A) | ☆Japanese2(B) | ☆Japanese2(B) |
| | ☆Japanese5 | ☆Japanese2(B) | ☆Japanese2(B) | ☆Japanese2(B) | ☆Japanese2(B) | ☆Japanese2(B) | ☆Japanese2(B) | ☆Japanese2(B) | ☆Japanese5 | ☆Japanese5 |
| | ☆Japanese6 | ☆Japanese5 | ☆Japanese5 | ☆Japanese5 | ☆Japanese5 | ☆Japanese5 | ☆Japanese5 | ☆Japanese5 | ☆Japanese6 | ☆Japanese6 |
| | | ☆Japanese3(A) | ☆Japanese3(A) | ☆Japanese3(A) | ☆Japanese3(A) | ☆Japanese3(A) | ☆Japanese3(A) | ☆Japanese3(A) | ☆Japanese3(A) | ☆Japanese3(A) |
| | | ☆Japanese3(B) | ☆Japanese4 | ☆Japanese4 | ☆Japanese4 | ☆Japanese4 | ☆Japanese4 | ☆Japanese4 | ☆Japanese3(B) | ☆Japanese3(B) |
| 3P & 4P 3P:10:40-11:35 4P:11:40-12:35 | ☆Intermediate Kanji and Vocabulary | ☆Applied Japanese (Writing B) | ☆Applied Japanese (Writing B) | ☆Applied Japanese (Writing B) | ☆Applied Japanese (Writing B) | ☆Applied Japanese (Writing B) | ☆Applied Japanese (Writing B) | ☆Applied Japanese (Writing B) | ☆Japanese 4 | ☆Japanese 4 |
| | ☆Applied Japanese (Reading A) | | | | | | | | ☆Applied Japanese (Listening A) | ☆Applied Japanese (Listening A) |
| | ☆Reading and Writing 1 | ☆Intermediate Grammar1 | ☆Intermediate Grammar1 | ☆Intermediate Grammar1 | ☆Intermediate Grammar1 | ☆Intermediate Grammar1 | ☆Intermediate Grammar1 | ☆Intermediate Grammar1 | ☆Reading and Writing 1 | ☆Reading and Writing 1 |
| 5P & 6P 5P:13:25-14:15 6P:14:25-15:15 | | ☆Reading and Writing 2 | ☆Reading and Writing 2 | ☆Reading and Writing 2 | ☆Reading and Writing 2 | ☆Reading and Writing 2 | ☆Reading and Writing 2 | ☆Reading and Writing 2 | ☆Reading and Writing 2 | ☆Reading and Writing 2 |
| | | ☆Japanese Culture and Society | ☆Japanese Culture and Society | ☆Japanese Culture and Society | ☆Japanese Culture and Society | ☆Japanese Culture and Society | ☆Japanese Culture and Society | ☆Japanese Culture and Society | ☆Intermediate Grammar2 | ☆Intermediate Grammar2 |
| | | 673154 Movie Analysis: Topics and Tasks | 673154 Movie Analysis: Topics and Tasks | 673154 Movie Analysis: Topics and Tasks | 673154 Movie Analysis: Topics and Tasks | 673154 Movie Analysis: Topics and Tasks | 673154 Movie Analysis: Topics and Tasks | 673154 Movie Analysis: Topics and Tasks | An Exploration of Chanoyu: Ethnography of Art, Mind and History | An Exploration of Chanoyu: Ethnography of Art, Mind and History |
| 7P & 8P 7P:15:30-16:20 8P:16:30-17:20 | 673121 Intercultural Communication I (7th P only) | 911082 Comparative Education as Social Science I | 911082 Comparative Education as Social Science I | 911082 Comparative Education as Social Science I | 911082 Comparative Education as Social Science I | 911082 Comparative Education as Social Science I | 911082 Comparative Education as Social Science I | 911082 Comparative Education as Social Science I | 911084 Foreign Perspectives of Japan through Documentaries | 911084 Foreign Perspectives of Japan through Documentaries |
| | 911081 Japanese Agriculture and Rural Society | 672001 Study of Japan A with SDGs | 672001 Study of Japan A with SDGs | 672001 Study of Japan A with SDGs | 672001 Study of Japan A with SDGs | 672001 Study of Japan A with SDGs | 672001 Study of Japan A with SDGs | 672001 Study of Japan A with SDGs | 673113 Foreign Perspectives of Japan through Documentaries | 673113 Foreign Perspectives of Japan through Documentaries |
| | | 671501EPOK Research Project: Spring I | 671501EPOK Research Project: Spring I | 671501EPOK Research Project: Spring I | 671501EPOK Research Project: Spring I | 671501EPOK Research Project: Spring I | 671501EPOK Research Project: Spring I | 671501EPOK Research Project: Spring I | 673141 Model United Nations Preparation Class | 673141 Model United Nations Preparation Class |
| Others | | | | | | | | | | |
| Intensive course | | | | | | | | | | |

Note: ➤ Course changes can be made only by submitting this form to EPOK Advisor: By April 16 (Fri) 12:00PM ➤ After you receive approval from EPOK Advisor, you need to drop a course using Academic Affairs System by April 20(Tue)

◆ Drop:

| | | | | |
|----|------------|---------|--|-----------------------------|
| 1) | class code | classes | Yes <input type="checkbox"/> fill in ↓ | NO <input type="checkbox"/> |
| 2) | class code | classes | | |
| 3) | class code | classes | | |
| 4) | class code | classes | | |
| 5) | class code | classes | | |

| | |
|---|--------------------------------|
| Course Credit Check List(Expected) 1+2 Term | |
| Japanese language (4) | |
| EPOK Research Project (I&II) (2) | |
| Others | |
| Total | 0 (15 credits or above) |

Approval: EPOK Advisor's Signature _____
 Date _____

2021-2022 EPOK Registration Memo 3rd Term

▶ Highlight classes you take in yellow
▶ If the class you take is not on the list, type it in and highlight yellow.

▶ Mark if approval Necessary

☆ Japanese Language Course

NAME:

E-mail:

| | Monday | | Tuesday | | Wednesday | | Thursday | | Friday | | |
|--|---|---|--|---|--|--|--|---|---|---|---------------|
| | Class Code | Classes | Class Code | Classes | Class Code | Classes | Class Code | Classes | Class Code | Classes | |
| 1P & 2P 1P:8:40-9:30 2P:9:40-10:30 | ☆Japanese1(A) ☆Japanese 1(B) ☆Japanese5 ☆Japanese6 | ☆Japanese1(A) ☆Japanese1(B) ☆Japanese2(A) ☆Japanese2(B) ☆Japanese5 ☆Japanese6 | ☆Japanese1(B) ☆Japanese2(A) ☆Japanese2(B) ☆Japanese5 | ☆Japanese1(A) ☆Japanese1(B) ☆Japanese2(A) ☆Japanese2(B) ☆Japanese5 ☆Japanese6 | ☆Japanese1(A) ☆Japanese1(B) ☆Japanese2(A) ☆Japanese2(B) ☆Japanese5 ☆Japanese6 | ☆Japanese1(A) ☆Japanese1(B) ☆Japanese2(A) ☆Japanese2(B) ☆Japanese5 ☆Japanese6 | ☆Japanese1(A) ☆Japanese1(B) ☆Japanese2(A) ☆Japanese2(B) ☆Japanese5 ☆Japanese6 | ☆Japanese1(A) ☆Japanese1(B) ☆Japanese2(A) ☆Japanese2(B) ☆Japanese5 ☆Japanese6 | ☆Japanese1(A) ☆Japanese2(A) ☆Japanese2(B) ☆Japanese6 ☆Applied Japanese (Listening B) | ☆Japanese1(A) ☆Japanese2(A) ☆Japanese2(B) ☆Japanese6 ☆Applied Japanese (Listening B) | ✓ Approval |
| 3P & 4P 3P:10:40-11:35 4P:11:40-12:35 | ☆Japanese1(C) ☆Japanese3(A) ☆Japanese3(B) ☆Intermediate Kanji and Vocabulary ☆Applied Japanese(Writing A) | ☆Japanese1(C) ☆Japanese3(A) ☆Japanese4 ☆Intermediate Grammar2 | ☆Japanese1(C) ☆Japanese3(B) ☆Japanese4 ☆Extensive Reading 2 | ☆Japanese1(C) ☆Japanese3(A) ☆Japanese4 ☆Intermediate Grammar2 | ☆Japanese1(C) ☆Japanese3(A) ☆Japanese4 ☆Intermediate Grammar2 | ☆Japanese1(C) ☆Japanese3(A) ☆Japanese3(B) ☆Japanese4 | ☆Japanese1(C) ☆Japanese3(A) ☆Japanese3(B) ☆Japanese4 | ☆Japanese1(C) ☆Japanese3(A) ☆Japanese3(B) ☆Japanese4 ☆Applied Japanese (Speaking A) | ☆Japanese3(A) ☆Japanese3(B) ☆Japanese4 ☆Study of Okayama | ☆Japanese3(A) ☆Japanese3(B) ☆Japanese4 ☆Study of Okayama | ✓ Approval |
| 5P & 6P 5P:13:25-14:15 6P:14:25-15:15 | ☆Reading and Writing 1(A) | ☆Reading and Writing 1(B) ☆Reading and Writing 2(A) ☆Reading and Writing 2(B) ☆Japanese through News and Magazine Articles ☆Applied Japanese(Reading B) □Working in Cross-cultural Organisations | ☆Intermediate Grammar 1 ■ Study of Japan C with SDGs | ☆Reading and Writing 1(A) ☆Reading and Writing 2(A) ☆Media Literacy □Introduction to Area Studies on Hawaii II | ☆Reading and Writing 1(A) ☆Reading and Writing 2(A) | 672013 | 911091 | ☆Reading and Writing 1(A) ☆Reading and Writing 2(A) | ☆Reading and Writing 1(B) ☆Reading and Writing 2(B) ☆Extensive Reading 1 ☆Japanese through Films 2 | ☆Reading and Writing 1(B) ☆Reading and Writing 2(B) ☆Extensive Reading 1 ☆Japanese through Films 2 | ✓ Approval |
| 7P & 8P 7P:15:30-16:20 8P:16:30-17:20 | 673121 □Language, Culture, and Social Interaction I (7P only) | 673153 □Writing about Movies: Topics and Terms for Film Analysis | 672013 ■ Study of Japan C with SDGs | 672013 | 672013 | 672013 | 673142 | 673142 | ☆Japanese through Films 1 □ Model United Nations Preparation Class | ☆Japanese through Films 1 □ Model United Nations Preparation Class | ✓ Approval |
| Others | 671503EPOK Research Project: Fall 1 | | | | | | | | | | |
| Intensive course | | | | | | | | | | | |

2021-2022 EPOK Registration Memo 4th Term

► Highlight classes you take in yellow
► If the class you take is not on the list, type it in and highlight yellow.

► Mark if approval Necessary

✕ Japanese Language Course

NAME:

E-mail:

| | Monday | | | Tuesday | | | Wednesday | | | Thursday | | | Friday | | |
|--|------------|---|------------|--|---------|--|------------|--|------------|--|---------|---|------------|---|------------|
| | Class Code | Classes | ✓ Approval | Class Code | Classes | ✓ Approval | Class Code | Classes | ✓ Approval | Class Code | Classes | ✓ Approval | Class Code | Classes | ✓ Approval |
| 1P & 2P 1P:8:40-9:30 2P:9:40-10:30 | | ☆Japanese1(A) ☆Japanese 1(B) ☆Japanese5 ☆Japanese6 | | ☆Japanese1(A) ☆Japanese1(B) ☆Japanese2(A) ☆Japanese2(B) ☆Japanese5 ☆Japanese6 | | ☆Japanese1(B) ☆Japanese2(A) ☆Japanese2(B) ☆Japanese5 | | ☆Japanese1(A) ☆Japanese1(B) ☆Japanese2(A) ☆Japanese2(B) ☆Japanese5 ☆Japanese6 | | ☆Japanese1(A) ☆Japanese1(B) ☆Japanese2(A) ☆Japanese2(B) ☆Japanese5 ☆Japanese6 | | ☆Japanese1(A) ☆Japanese2(A) ☆Japanese2(B) ☆Japanese6 ☆Applied Japanese (Listening B) | | ☆Japanese1(A) ☆Japanese2(A) ☆Japanese2(B) ☆Japanese6 ☆Applied Japanese (Listening B) | |
| 3P & 4P 3P:10:40-11:35 4P:11:40-12:35 | | ☆Japanese1(C) ☆Japanese3(A) ☆Japanese3(B) ☆Intermediate Kanji and Vocabulary ☆Applied Japanese(Writing A) | | ☆Japanese1(C) ☆Japanese3(A) ☆Japanese4 ☆Intermediate Grammar2 | | ☆Japanese1(C) ☆Japanese3(B) ☆Japanese4 ☆Extensive Reading 2 | | ☆Japanese1(C) ☆Japanese3(A) ☆Japanese3(B) ☆Japanese4 ☆Applied Japanese (Speaking A) | | ☆Japanese1(C) ☆Japanese3(A) ☆Japanese3(B) ☆Japanese4 ☆Applied Japanese (Speaking A) | | ☆Japanese3(A) ☆Japanese3(B) ☆Japanese4 ☆Study of Okayama | | ☆Japanese3(A) ☆Japanese3(B) ☆Japanese4 ☆Study of Okayama | |
| 5P & 6P 5P:13:25-14:15 6P:14:25-15:15 | | ☆Reading and Writing 1(A) | | ☆Reading and Writing 1(B) ☆Reading and Writing 2(A) ☆Reading and Writing 2(B) ☆Japanese through News and Magazine Articles ☆Applied Japanese (Reading B) <input type="checkbox"/> Environmental Education Methods | | 672014 ☆Intermediate Grammar 1 ■Study of Japan D with SDGs | | ☆Reading and Writing 1(A) ☆Reading and Writing 2(A) ☆Media Literacy <input type="checkbox"/> Chado: Mind and practice | | ☆Reading and Writing 1(A) ☆Reading and Writing 2(A) ☆Media Literacy <input type="checkbox"/> Chado: Mind and practice | | ☆Reading and Writing 1(B) ☆Reading and Writing 2(B) ☆Extensive Reading 1 ☆Japanese through Films 2 <input type="checkbox"/> Japanese Language Education in a Global Society | | ☆Reading and Writing 1(B) ☆Reading and Writing 2(B) ☆Extensive Reading 1 ☆Japanese through Films 2 <input type="checkbox"/> Japanese Language Education in a Global Society | |
| 7P & 8P 7P:15:30-16:20 8P:16:30-17:20 | 673132 | <input type="checkbox"/> Language, Culture, and Social Interaction II (7P only) | | TBA | | 672014 ■Study of Japan D with SDGs | | 672014 ■Study of Japan D with SDGs | | 672014 ■Study of Japan D with SDGs | | ☆Japanese through Films 1 | | ☆Japanese through Films 1 | |
| Others | | 671504 EPOK Research Project/Fall II | | | | | | | | | | | | | |
| Intensive course | | | | | | | | | | | | | | | |

Study Japan EPOK Certificates: Yes No

| | |
|--|---|
| Course Credit Check List(Expected) 3+4Term | |
| Japanese language (4) | |
| EPOK Research Project (I&II) (2) | |
| Others | |
| Total | 0 |

(15 credits or above)

(3 and 4 Term) Total Credits:

Approval: EPOK Advisor's Signature : _____
Date _____

Note: You need to submit Registration memo to EPOK Advisor by Sep. 28th (Tue) 12:00P(JST)

After you received approval from EPOK Advisor, you need to register courses from Academic Affairs System by September 30th(Thu)

2021-2022 EPOK Course Schedule Changes(Drop) 3rd Term

Name: _____

E-mail: _____

Student ID Number: _____

► Highlight classes you take in yellow
► If the class you take is not on the list, type it in and highlight yellow.

► Mark if approval Necessary

☆ Japanese Language Course

◆ Fill in your final course schedule

| | Monday | | Tuesday | | Wednesday | | Thursday | | Friday | |
|--|---------------------------------------|--|--------------------------------|---|--------------------------------|--------------------------------|--|--|---------------------------------|---|
| | Class Code | Classes | Class Code | Classes | Class Code | Classes | Class Code | Classes | Class Code | Classes |
| 1P & 2P 1P:8:40-9:30 2P:9:40-10:30 | ☆Japanese1(A) | ☆Japanese1(A) | ☆Japanese1(C) | ☆Japanese1(B) | ☆Japanese1(C) | ☆Japanese1(C) | ☆Japanese1(A) | ☆Japanese1(A) | ☆Japanese1(A) | ☆Japanese1(A) |
| | ☆Japanese 1(B) | ☆Japanese1(B) | ☆Japanese3(A) | ☆Japanese2(A) | ☆Japanese3(B) | ☆Japanese3(B) | ☆Japanese1(B) | ☆Japanese1(B) | ☆Japanese2(A) | ☆Japanese2(A) |
| | ☆Japanese5 | ☆Japanese2(A) | ☆Japanese4 | ☆Japanese2(B) | ☆Japanese4 | ☆Japanese3(B) | ☆Japanese2(A) | ☆Japanese2(A) | ☆Japanese2(B) | ☆Japanese2(B) |
| | ☆Japanese6 | ☆Japanese2(B) | ☆Intermediate Grammar2 | ☆Japanese5 | ☆Japanese5 | ☆Japanese4 | ☆Japanese2(B) | ☆Japanese2(B) | ☆Japanese6 | ☆Japanese6 |
| | | ☆Japanese6 | ☆Intermediate Grammar1 | ☆Japanese5 | ☆Japanese5 | ☆Japanese4 | ☆Japanese5 | ☆Japanese5 | ☆Applied Japanese (Listening B) | ☆Applied Japanese (Listening B) |
| | | ☆Japanese1(C) | ☆Reading and Writing 1 | ☆Japanese1(C) | ☆Japanese1(C) | ☆Japanese1(C) | ☆Japanese1(C) | ☆Japanese1(C) | ☆Japanese3(A) | ☆Japanese3(A) |
| 3P & 4P 3P:10:40-11:35 4P:11:40-12:35 | ☆Japanese3(A) | ☆Japanese3(A) | ☆Japanese3(A) | ☆Japanese3(B) | ☆Japanese3(B) | ☆Japanese3(B) | ☆Japanese3(A) | ☆Japanese3(A) | ☆Japanese3(B) | ☆Japanese3(B) |
| | ☆Japanese3(B) | ☆Japanese3(B) | ☆Japanese4 | ☆Japanese2(B) | ☆Japanese4 | ☆Japanese3(B) | ☆Japanese3(B) | ☆Japanese3(B) | ☆Japanese4 | ☆Japanese4 |
| | ☆Intermediate Kanji and Vocabulary | ☆Intermediate Grammar2 | ☆Intermediate Reading 2 | ☆Extensive Reading 2 | ☆Extensive Reading 2 | ☆Extensive Reading 2 | ☆Japanese4 | ☆Japanese4 | ☆Study of Okeyama | ☆Study of Okeyama |
| | ☆Applied Japanese(Writing A) | ☆Applied Japanese(Writing A) | ☆Applied Japanese (Speaking A) | ☆Applied Japanese (Speaking A) | ☆Applied Japanese (Speaking A) | ☆Applied Japanese (Speaking A) | ☆Applied Japanese (Speaking A) | ☆Applied Japanese (Speaking A) | ☆Applied Japanese (Speaking A) | ☆Applied Japanese (Speaking A) |
| 5P & 6P 5P:13:25-14:15 6P:14:25-15:15 | ☆Reading and Writing 1 | ☆Reading and Writing 1(B) | ☆Intermediate Grammar 1 | ☆Intermediate Grammar 1 | ☆Intermediate Grammar 1 | ☆Intermediate Grammar 1 | ☆Reading and Writing 1(A) | ☆Reading and Writing 1(A) | ☆Reading and Writing 1(B) | ☆Reading and Writing 1(B) |
| | | ☆Reading and Writing 2(A) | 672013 | 672013 | 672013 | 672013 | ☆Reading and Writing 2(A) | ☆Reading and Writing 2(A) | ☆Reading and Writing 2(B) | ☆Reading and Writing 2(B) |
| | | ☆Reading and Writing 2(B) | | | | | ☆Media Literacy | ☆Media Literacy | ☆Extensive Reading 1 | ☆Extensive Reading 1 |
| | | ☆Japanese through News and Magazine Articles | 911089 | 911089 | 911089 | 911089 | ☆Introduction to Area Studies on Hawaii II | ☆Introduction to Area Studies on Hawaii II | ☆Japanese through Films 2 | ☆Japanese through Films 2 |
| 7P & 8P 7P:15:30-16:20 8P:16:30-17:20 | 673121 | ☆Language, Culture, and Social Interaction I (7P only) | 673153 | ☆Writing about Movels: Topics and Terms for Film Analysis | 672013 | ☆Study of Japan C with SDGs | | | ☆Japanese through Films 1 | ☆Japanese through Films 1 |
| | | | | | | | | | 673142 | ☆Model United Nations Preparation Class |
| Others | 671501EPOK Research Project: Spring I | | | | | | | | | |
| Intensive course | | | | | | | | | | |

Note: ► Course changes can be made only by submitting this form to EPOK Advisor: By October 8th (Fri) 12:00PM ► After you receive approval from EPOK Advisor, you need to drop a course using Academic Affairs System by October 12th (Tue)

Study Japan EPOK Certificate : Yes fill in ! NO

| | |
|---|--------------------------|
| Course Credit Check List(Expected) 3+24Term | |
| Japanese language (4) | |
| EPOK Research Project ((&I)) (2) | |
| Others | |
| Total | 0 (1.5 credits or above) |

Approval: EPOK Advisor's Signature _____
Date _____

◆ Drop:

1)

class code

classes

classes

classes

classes

2)

class code

classes

classes

classes

classes

3)

class code

classes

classes

classes

classes

4)

class code

classes

classes

classes

classes

5)

class code

classes

classes

classes

classes

Floor Map

一般教育棟 1階(A棟, B棟, C棟)

Building for General Education 1F, (Wing A, Wing B, Wing C)

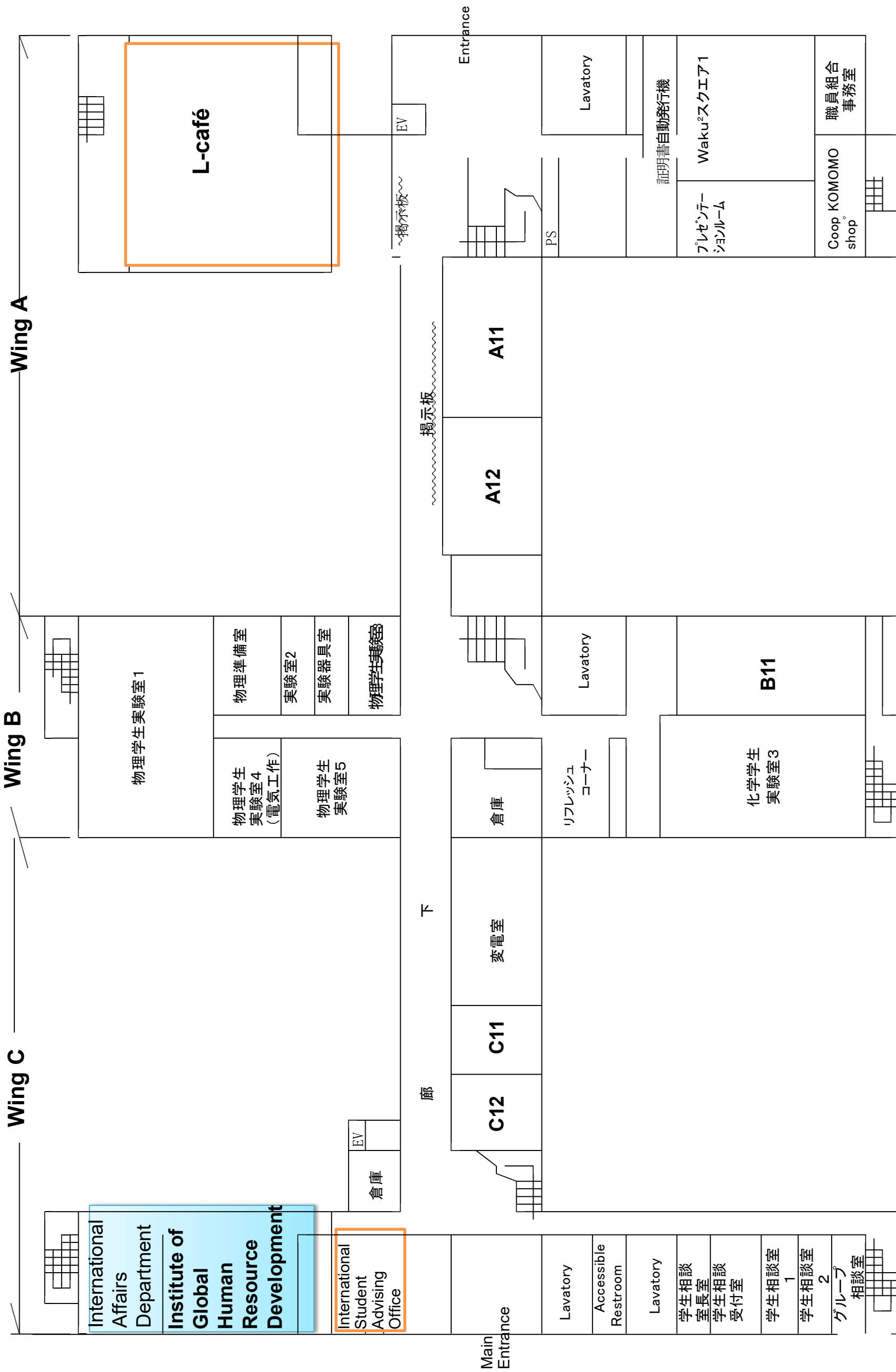

Building for General Education 2F, (Wing A, Wing B, Wing C)

一般教育棟 2階(A棟, B棟, C棟)

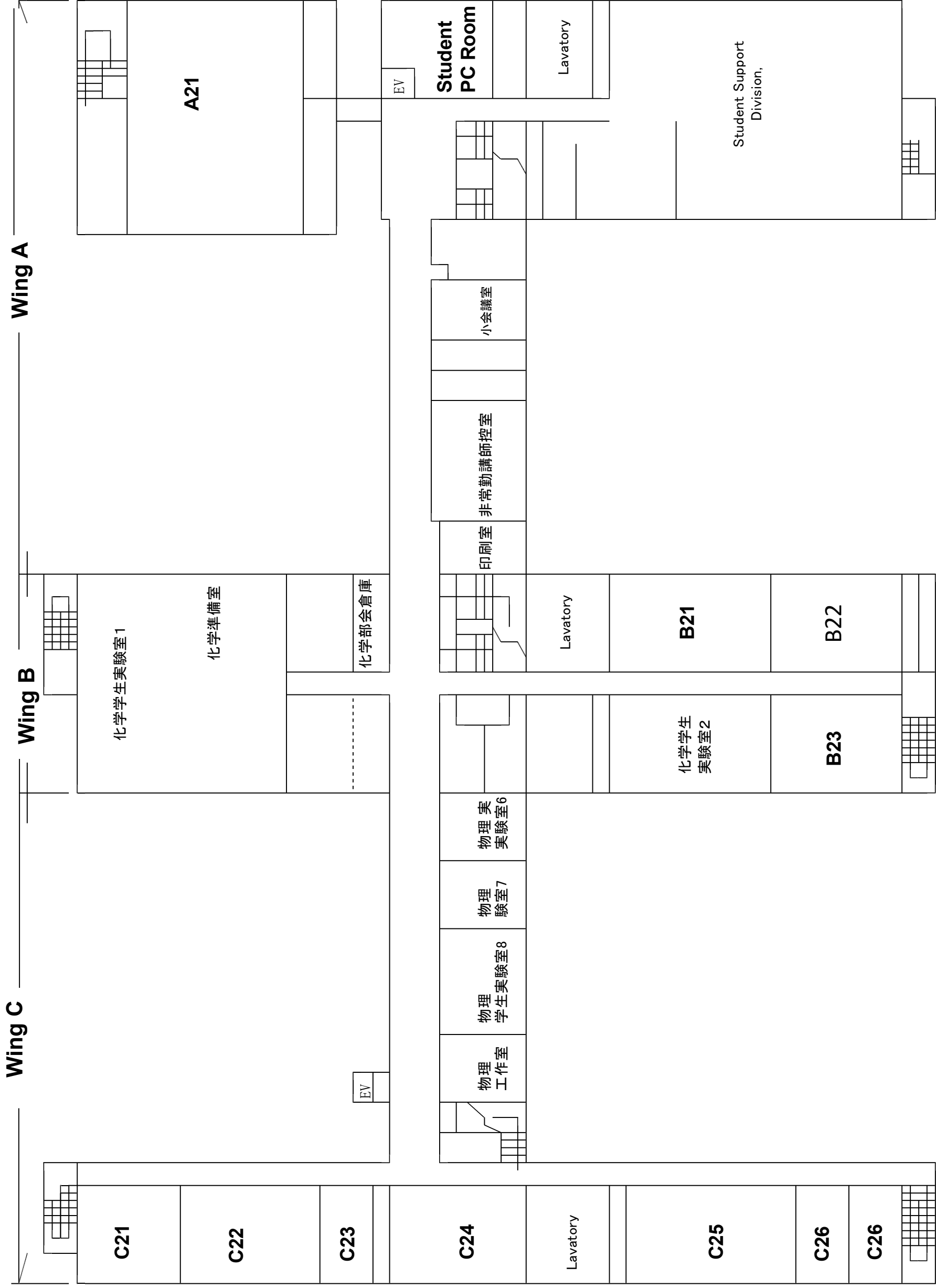

一般教育棟 3階(A棟, B棟, C棟)

Building for General Education 3F, (Wing A, Wing B, Wing C)

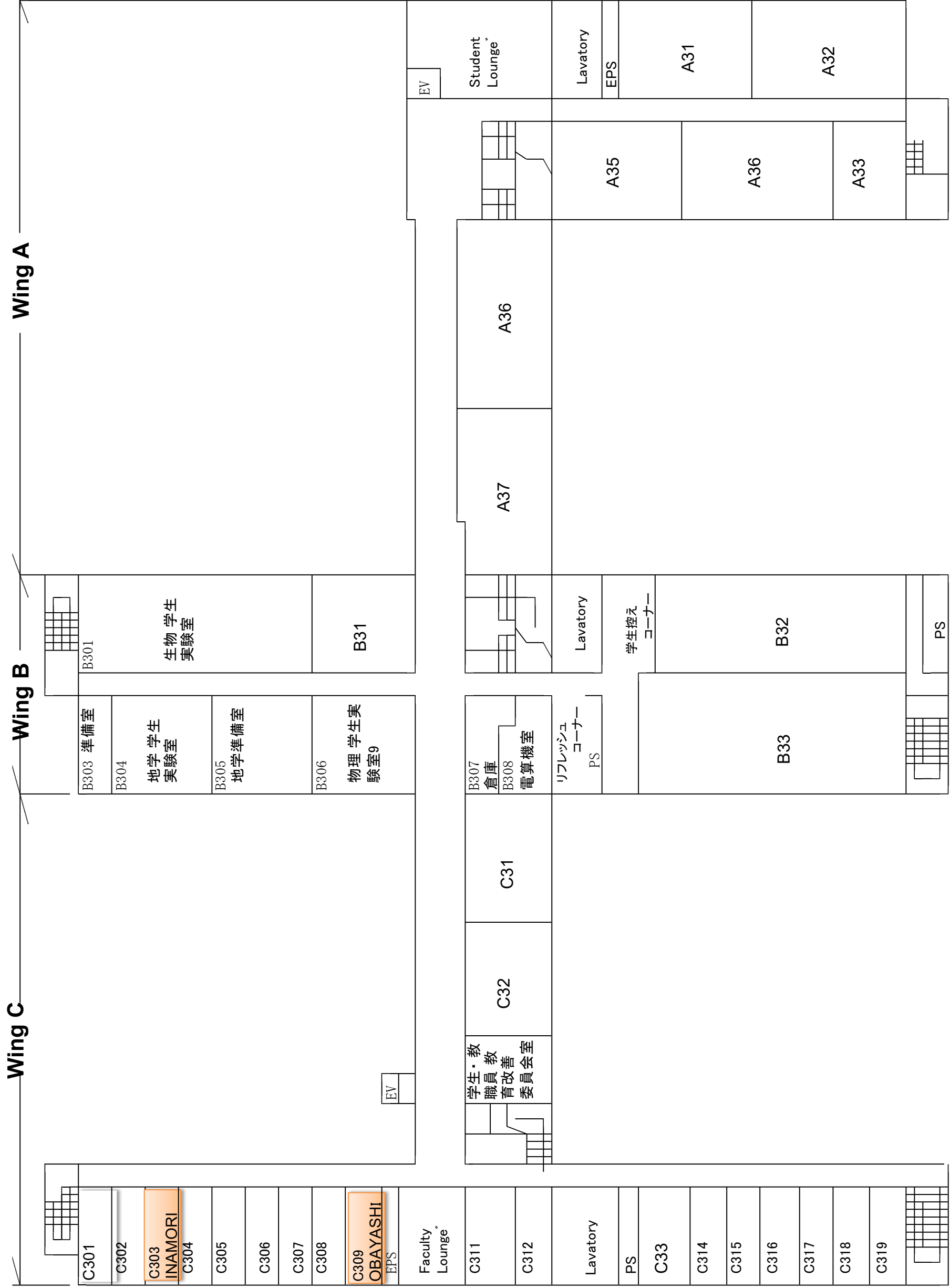

一般教育棟 4階(A棟, B棟, C棟)

Building for General Education 4F, (Wing A, Wing B, Wing C)



一般教育棟 1・2階(D棟, E棟)

Building for General Education 1F, 2F (Wing D, Wing E)

Wing D 1F

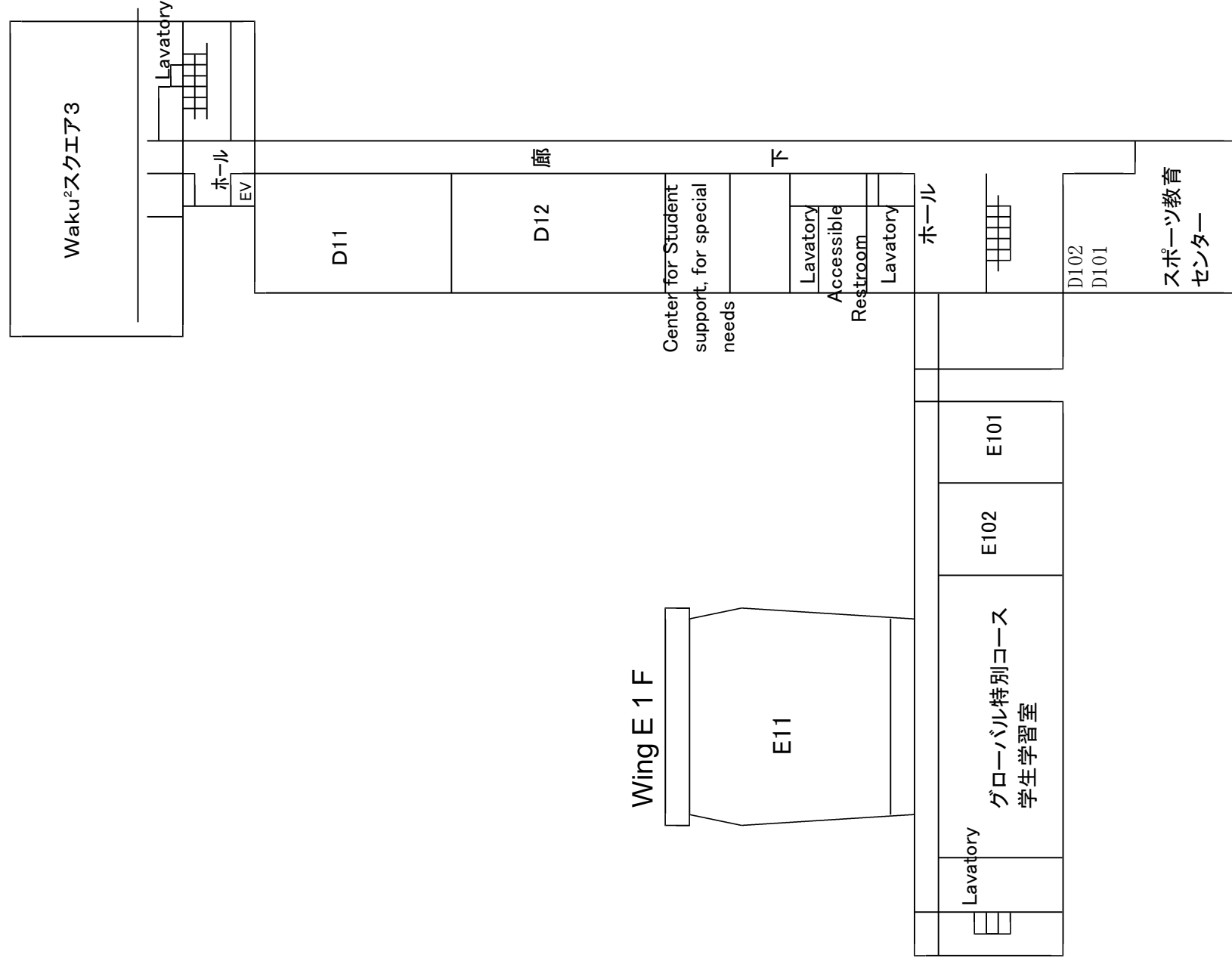

Wing D 2F

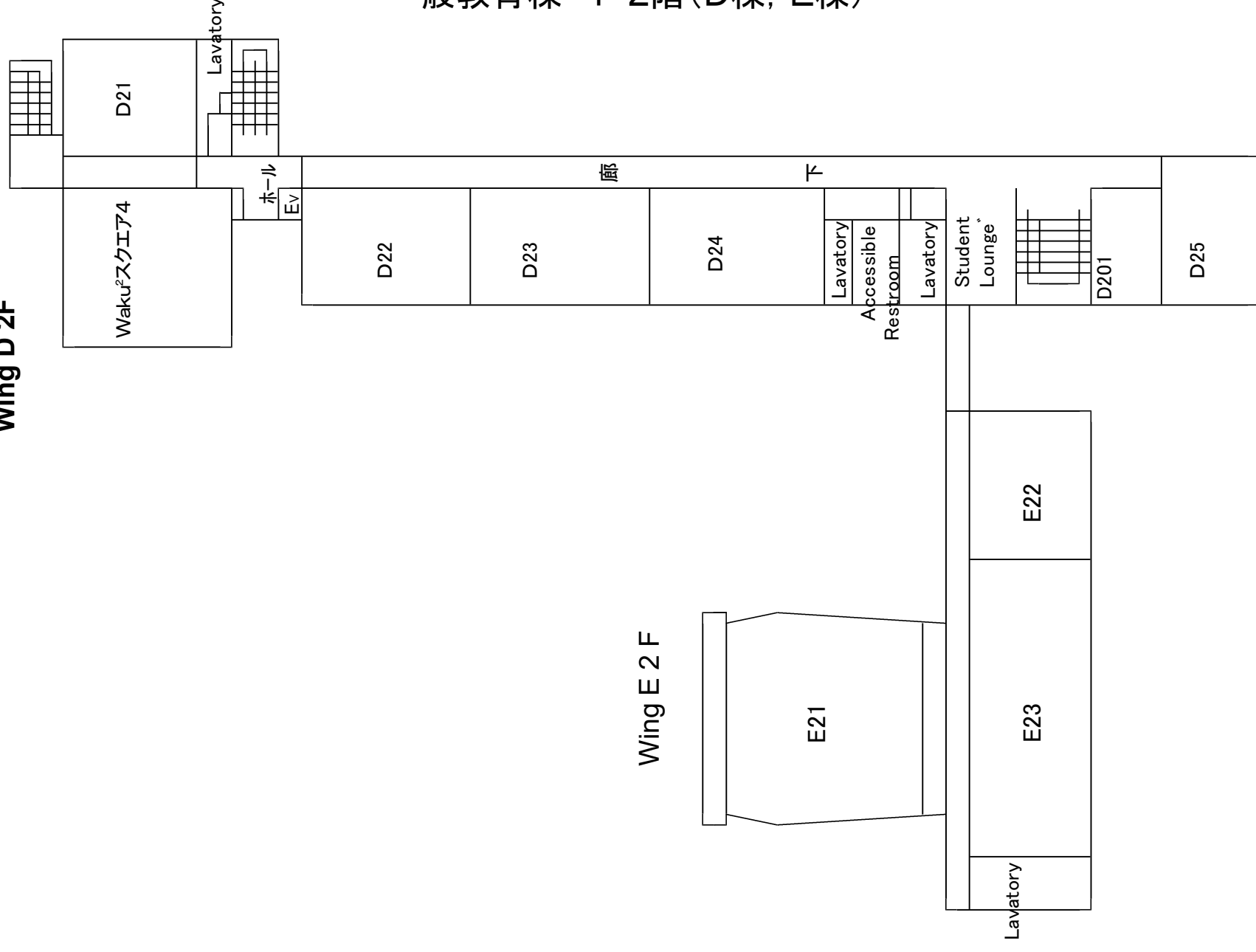

Building for Education Building 3F, 4F, 5F, 6F (Wing D, Wing E)

一般教育棟 3~6階(D棟, E棟)

Wing D 5 F

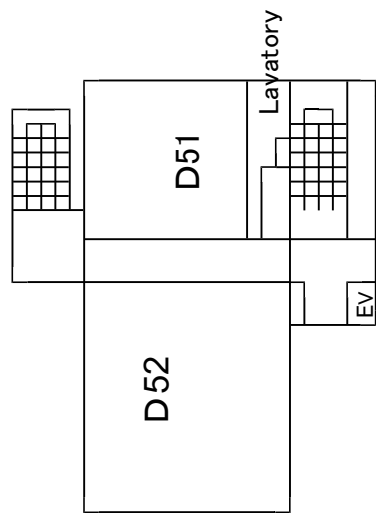

Wing D 3 F

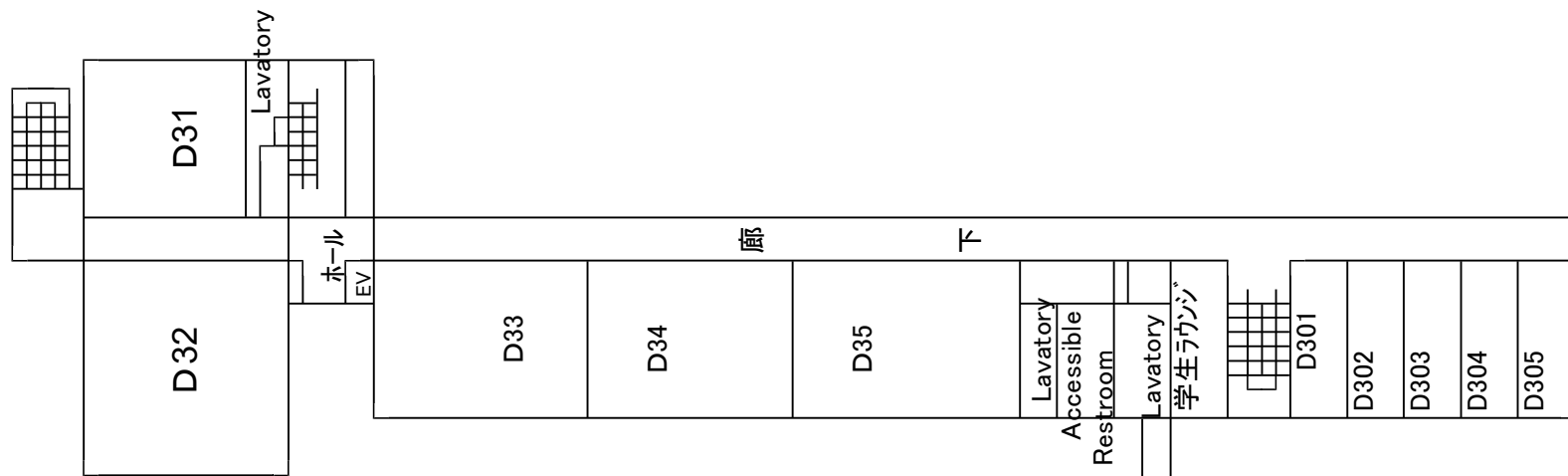

Wing D 6 F

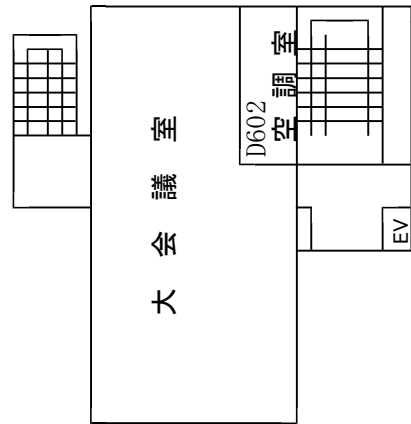

Wing E 3 F

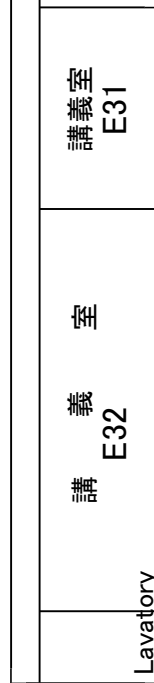

Wing E 4 F

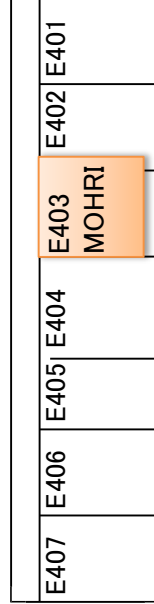

Wing D 4 F



**For further information please contact:
Institute of Global Human Resource Development
EPOK Academic Advisor:**

EPOK Cordinator

*Junko OBAYASHI (Associate Professor)

j_obayashi@okayama-u.ac.jp

*Takao INAMORI (Assosicate Professor)

takaoinamori@okayama-u.ac.jp

* Takami MOHRI (Assosicate Professor)

tmohri@okayama-u.ac.jp

EPOK Program, Administrative office:

International Student Division

*Kazumi USHIRODANI

epok-inbound1@adm.okayama-u.ac.jp

Institute of Global Human Resource
Development
Okayama University

1F, Wing C, Building for General Education,
2-1-1 Tsushima-naka Kita-ku, Okayama 700-8530
TEL: +81 (0)86 251-8547

<http://www.okayama-u.ac.jp/user/ouic/english/epok/index.html>

Email: epok-inbound1@adm.okayama-u.ac.jp