

EPOK - Exchange Program Okayama -

Institute of Global Human Resource Development

Okayama University

Japan

EPOK

COURSE CATALOG

2025-2026



Japan.
Committed
to SDGs



OKAYAMA
UNIVERSITY

**SUSTAINABLE
DEVELOPMENT
GOALS**

Okayama University supports the Sustainable Development Goals

Table of Contents

1. **Academic Calendar**
2. **General Information**
-Registration, Credits, Grading System
3. **Overview of the Academic Affairs system**
4. **1st Term**
-Timetable of Courses
5. **2nd Term**
-Timetable of Courses
6. **3rd Term**
-Timetable of Courses
7. **4th Term**
-Timetable of Courses
8. **About Japanese Language course**
Information: Refer to Japanese language Course
9. **Registration Forms**
10. **Campus Maps**

**For further information please contact:
Institute of Global Human Resource Development
EPOK Academic Advisor:**

Saida KHALMIRZAEVA, Associate Professor
pu6h2ipe@okayama-u.ac.jp

EPOK Program, Administrative office:
epok-inbound1@adm.okayama-u.ac.jp

Academic Year 2025 Schedule

M	D							Remarks	M	D							Remarks
	Sun.	Mon.	Tue.	Wed.	Thu.	Fri.	Sat.			Sun.	Mon.	Tue.	Wed.	Thu.	Fri.	Sat.	
Apr.			1	2	3	4	5	by March 21st ★JLC Picament test(online)	Oct.				1	2	3	4	1st ·Beginning of the third term classes
	6	7	8	9	10	11	12	3rd ★EPOK Guidance		5	6	7	8	9	10	11	
	13	14	15	16	17	18	19	3rd ★Arrival Orientaion		12	13	14	15	16	17	18	13th ·National Holiday
	20	21	22	23	24	25	26	4th ★Opening Ceremony		19	20	21	22	23	24	25	15th *Monday classes instead of Wednesday
	27	28	29	30				4th ★Campus Life Orientaion		26	27	28	29	30	31		
							9th ·Beginning of the first term classes										
May					1	2	3	29th ·National Holiday	Nov.							1	3rd ·National Holiday
	4	5	6	7	8	9	10	TBA ·Health Check-up		2	3	4	5	6	7	8	
	11	12	13	14	15	16	17	After Arrival ★Residence Registration		9	10	11	12	13	14	15	
	18	19	20	21	22	23	24	*2nd Tuesday classes instead of Friday		16	17	18	19	20	21	22	20th *Monday classes instead of Thursday
	25	26	27	28	29	30	31	*7th Tuesday classes instead of Wednesday		23	24	25	26	27	28	29	23rd&24th ·National Holidays
							*8th Monday classes instead of Thursday	30							25th ·Possible make-up class day		
Jun.	1	2	3	4	5	6	7	3rd-6th ·National Holidays	Dec.		1	2	3	4	5	6	3rd ·Beginning of the fourth term classes
	8	9	10	11	12	13	14	2nd ·Possible make -up class day		7	8	9	10	11	12	13	
	15	16	17	18	19	20	21	10th ·Beginning of the second term classes		14	15	16	17	18	19	20	
	22	23	24	25	26	27	28			21	22	23	24	25	26	27	Dec.26th-Jan.4th ·Office Closed
	29	30								28	29	30	31				
Jul.			1	2	3	4	5	21st ·National Holiday	Jan.					1	2	3	12th ·National Holiday
	6	7	8	9	10	11	12			4	5	6	7	8	9	10	
	13	14	15	16	17	18	19	*22nd Monday classes instead of Tuesday		11	12	13	14	15	16	17	14th *Friday classes instead of Wednesday
	20	21	22	23	24	25	26	30th ·Possible make -up class day		18	19	20	21	22	23	24	No classes due to the National Common Test for University Admissions
	27	28	29	30	31					25	26	27	28	29	30	31	
Aug.						1	2	6th or 7th ※Closing Ceremony	Feb.	1	2	3	4	5	6	7	3rd ·Possible make-up class day
	3	4	5	6	7	8	9	11th ·National Holiday		8	9	10	11	12	13	14	11th ·National Holiday
	10	11	12	13	14	15	16	12th-15th ·Office Closed		15	16	17	18	19	20	21	23rd ·National Holiday
	17	18	19	20	21	22	23			22	23	24	25	26	27	28	
	24	25	26	27	28	29	30										
Sept.		1	2	3	4	5	6	15th&23rd ·National Holidays	Mar.	1	2	3	4	5	6	7	
	7	8	9	10	11	12	13	TBA ★JLC Picament test(online)		8	9	10	11	12	13	14	
	14	15	16	17	18	19	20	26th ★EPOK Guidance		15	16	17	18	19	20	21	20th ·National Holiday
	21	22	23	24	25	26	27	26th ★Arrival Orientaion		22	23	24	25	26	27	28	
	28	29	30					TBA ★Opening Ceremony		29	30	31					
								TBA ★Campus Life Orientation									
								TBA ·Health Check-up									
								After Arrival ★Residence Registration									

1st Term Total	8	8	8	8	8	8	Class week Total (Including exam week)	3rd Term Total	8	8	8	8	8	8	Class week Total (Including exam week)
2nd Term Total	8	8	8	8	8	8		4th Term Total	8	8	8	8	8	8	

*JLC: Japanese Language Course · : For all EPOK students ★For New Enrollment students ※Those who will complete the program

- | | |
|--|---|
| <p>1st Term April 1–June 9</p> <p>2nd Term June 10–August 10</p> <p>3rd Term October 1–December 2</p> <p>4th Term December 3–February 14</p> <p>Exam week</p> | <p>■ Holiday/No classes</p> <p>□ Class schedule changed to another day</p> <p>□ Possible make-up class days</p> <p>*Dates for make-up classes decided by teachers</p> |
|--|---|

General Information

● Registration *The registration details to be informed at the EPOK Course Guidance.

1. Minimum coursework required: 10 hours per week (5 credits)
 2. The courses listed in the EPOK Course Catalogue are offered in English.
To check the Syllabi of the courses, visit the link below:
<https://kyomu.adm.okayama-u.ac.jp/Portal/Public/Syllabus/SearchMain.aspx>
 3. EPOK students can take the courses listed in the EPOK Course Catalogue.
 - As indicated in the list, some courses have prerequisite and require an approval from the instructor for enrollment. If interested in taking them, you need to contact the instructor via email well in advance before the semester begins. Remember to copy the email to your EPOK academic advisor.
 - Some faculty courses which are not listed on the EPOK course catalogue may be available to EPOK students under certain conditions including Japanese language proficiency. Read the syllabus well especially the “Target students” and “Open to other faculties” section as well as other requisites. If you wish to take the applicable course, contact the EPOK academic advisor well in advance to see if you are eligible and permitted to register in the course.

(See to the Overview of the Academic Affairs system on the page 7~)**
 4. Complete the EPOK Registration Form and submit it to the EPOK academic advisor through Moodle before the Interview for course planning.
 5. You can register the courses online for yourself on the Academic Affairs System**
 6. To drop classes, report to the EPOK academic advisor with the Course Change Report before making a change by yourself online Academic Affairs System (TBA).*
*After the period, you are not allowed to change your classes.
 7. Regarding the Japanese Language Course, you need to refer to the Japanese Course Catalogue.(See to About Japanese Language Course on the page 49)
 8. At the end of your exchange period, “Certificate of Attendance (EPOK)” will be issued to those who completed the semester(s) with the grade transcript.
“EPOK Certificate of Study Japan” can be obtained additionally if you pursue to fulfill its requirements.
(See to the coursework requirement for EPOK Certificate on the page 6)*
- If you require special consideration and support in the classes, please provide the relevant medical certification to the EPOK academic advisor.

- **Credits**

1. EPOK regular classes: Once a week (100 min) for 8 weeks = 1 credit

2. Japanese Language Courses are calculated as follows:

Cre	Week	Frequency	Course
4	8	4 times a week	Japanese 1 Japanese 2 Japanese 3 Japanese 4 Japanese 5 Japanese 6 Japanese 7** **courses to be combined
2	8	twice a week	Reading and Writing 1 Reading and Writing 2
1	8	once a week	others

For further information, please see 2025-2026 Japanese Course Catalogue.

- **Grading System**

Grade Classification	Mark (%)	Pass/Fail
A+	90 – 100 %	Pass
A	80 – 89 %	Pass
B	70 – 79 %	Pass
C	60 – 69 %	Pass
F	0 – 59 %	Fail

● EPOK Certificate (of Study Japan)

In order to obtain EPOK Certificate of Study Japan, students must complete the program under the certificate requisite as following:

Students must earn 15 or more credits per semester (1&2 semester/ 3&4 semester)

including: EPOK Research Project < 2 credits>
 EPOK Recommended Courses or/and Others: <2 credit or more>
 Japanese Language Courses < 4 credit or more >

Additional 7 credits should be taken either from EPOK elective or Japanese language or others.

➤ A full-year student who pursue a certificate “EPOK Certificate (1-Year)” must fulfill the requirement in both semesters (including minimum 15-credit) except for EPOK Research Project of 2-credit.

➤ A full-year student who fulfills the requirement only in either semester should receive “EPOK Certificate (6-Month).”

<6-month (one semester) course>

Course Subject/Category		Credit Required
Japanese Language		4 Credit Minimum
EPOK Elective	'Study of Japan'	} 2 Credit Minimum
	EPOK Recommended Courses	
	Others	
'EPOK Research Project'		2*
Required Total Credit		15

<1-year (two semester) course> Must fulfill the requirement both in Spring and Fall semesters.

Course Subject/Category		Credit Required
Japanese Language		8 Credit Minimum
EPOK Elective	'Study of Japan'	} 4 Credit Minimum
	EPOK Recommended Courses	
	Others	
'EPOK Research Project'		2*
Required Total Credit		30

* For 1-year student: the 2 credit of EPOK Research Project can be pursued in either semester (Spring / Fall)

- “EPOK Recommended Courses” include the courses offered by Institute of Global Human Resource Development, Global Discovery Program, Language Education (Japanese, English), General Education courses, and others, listed on the EPOK Course Catalogue.
- “Others” includes the courses in General Education and Faculties, which are not listed in the Catalogue.

Overview of the Academic Affairs System

Overview of the Academic Affairs System



The Academic Affairs System is designed to support various procedures that are vital to your campus life (i.e. academic affairs) such as registering courses, viewing academic records, and issuing certificates. An Okayama University ID (hereafter Okadai ID) is required to use the system. (The Center for Information Technology and Management will assign each student with an ID at the time of admission.)

- * An Okadai ID is required to access various information services on campus. Please manage your ID and password properly (Do not share them with anyone else.)
- * Automatic certificate issuing machines are installed at the following locations:
 - Tsushima Campus: the Building for General Education (two machines), Peach Union (one).
 - Shikata Campus: on the 1st floor of the Administration building (one).

Academic Affairs System

- View Academic Calendar
- View Syllabus
- Receive web messages (and reply)
- Register for courses (Only during registration period.)
- Register for Lottery courses (Only during registration period.)
- View Course schedule
- External Certification Exams
- Attendance Record
- Check academic transcript
- Check and register student information
- Receive results of regular medical checkups
- Register/delete information about Okayama University clubs and circles on campus

Supported browsers

- Microsoft Edge
- Mozilla Firefox
- Google Chrome
- Safari

Note: varies depending on version

Hours of access

Available 24 hours a day.
(Except for the year-end and New Year holidays, and maintenance days)

Relevant systems

- Okayama University Moodle system

Certificate issuing machines

- Certificates that can be printed: student discount certificate, enrollment certificate, expected graduation certificate, academic transcript, health certificate, etc.

Use of PCs and other devices on campus

Students can access the campus network via wireless LAN access points, which are provided at various locations on campus using devices such as laptops, smartphones, and tablets.

For more details, refer to the webpage below:

Website of the Center for Information Technology and Management, Okayama University

<http://www.okayama-u.ac.jp/user/citm/limiting/eng/service/index.html>

(This page is available only on campus network)

How to use the Academic Affairs System



Portal site

URL: <https://kyomu.adm.okayama-u.ac.jp/portal/>

Note: This link is the same for students and faculty.



How to access the Academic Affairs System from the university homepage

- 1 Open the web browser and access the Okayama University official website. Click on “*Current students*”, which is displayed in the top menu.

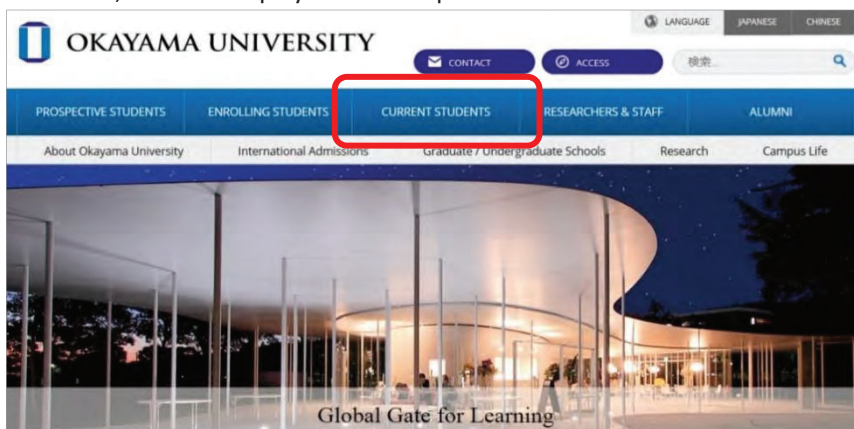

Okayama University official website: https://www.okayama-u.ac.jp/index_e.html

- 2 From the menu on the right-hand side of the screen click on “*Academic Affairs System*”.

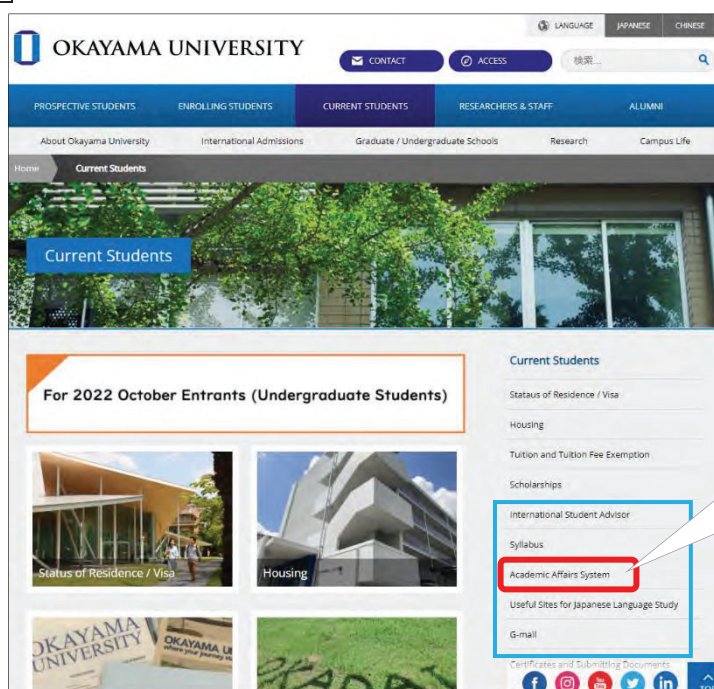

Close-up

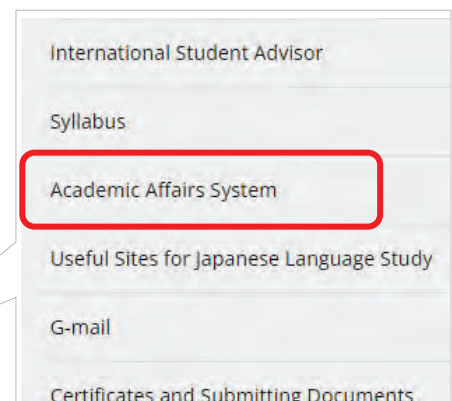

- 3 To access the English page, click on “Click here for English Version” on the Academic Affairs Page in Japanese and click on “Academic Affairs System” on the English page.

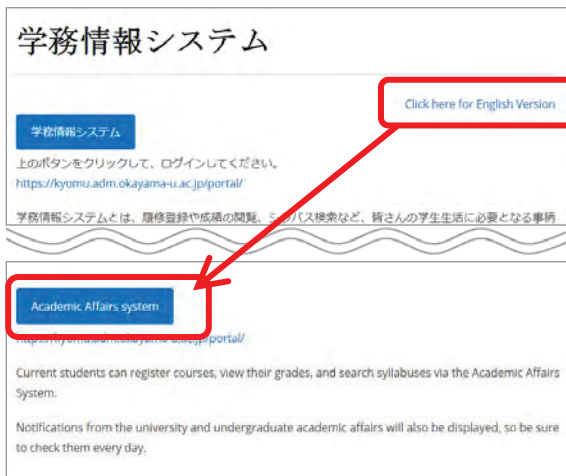

- 4 Log in with your Okadai ID and password



Regarding the Necessary Settings After Enrollment

During the orientation sessions for each school/faculty/program, you will receive a "Password Notification" letter containing your Okayama University ID and password necessary for accessing essential information services.

Please ensure to make the following settings after receiving the "Password Notification" letter:

- ◆ Register a personal email address for verification purposes

Failure to complete these settings will result in the inability to log in to the following services after enrollment:

- ◆ Microsoft 365
- ◆ Okayama University Gmail

For detailed instructions on setting up, please refer to the following pages:

- Guide for Using Okayama University Information Infrastructure Services (for Students)

*Choose a language comfortable for you

<https://www.okayama-u.ac.jp/user/citm/service/guide-student.html>



- Contact Information for Okayama University ID and Password Inquiries

Information Management Center User Consultation Service Inquiry Form

<https://msgs.ccsv.okayama-u.ac.jp/a/>



5 After logging in, you should be able to view your personal page.

The screenshot shows the personal page of OKADAI Taro. At the top right, there are font size options (S, M, L) and language selection buttons for Japanese and English. The user's name 'OKADAI Taro' is displayed. Below the name are navigation tabs: Top page, Messages, Course grades, Register information, and Various settings. A yellow box highlights the message notification: 'You have 4 new messages'. A 'Manual' button is also visible. The 'News List' section shows a table of recent news items. A yellow box at the bottom contains a notice about course registration.

Font size S M L

日本語 English

岡山大学 OKAYAMA UNIVERSITY

OKADAI Taro

Change language here.

Top page トップページ

Messages メッセージ

Course grades 履修・成績情報

Register information 学籍情報

Various settings 各種設定

Information

Lost/found items

Annual event

Login history

Class Information

Number of unread messages.

Manual マニュアル

Access the user manual here.

News List

Showing Not yet read Update

Category display settings

Date	Not yet read	Category	Subject
3/9/2021 4:05:22 PM	UNREAD	Medical checkup	2020年度の健康診断書の発行について
3/3/2021 2:40:51 PM	UNREAD	Higher Education Support System	遠隔認定（学業）による給付奨学金の継続について
2/1/2021 11:58:38 AM	UNREAD	Academic affairs	2021年度4学期期の卒業（修了）時期と授業料納入について / The schedule of graduation and tuition payment in 2021

System information

Course registration by 11:00 pm will be reflected in "Moodle" after 7:00 the next morning. Please note that it will not be reflected immediately.

Your log-in information will be stored until all the tabs on your browser have been closed. When using a public PC that is accessible to multiple users, be sure to log out and close all browsers at the end of your session.



Registering for courses online



Register for the courses of your choice using the online registration system:

The registration process is divided into two periods; namely the Course Registration Period, where you can add and drop courses, and the Course Deletable Period, where you can only drop courses. Details regarding the duration of each period will be announced separately by each faculty and may differ slightly. Additionally, there may be some courses that students are not able to register for online by themselves, so please pay close attention to the notices displayed on the Academic Affairs System.

1. Course Registration screen

- 1 From the top menu, select “Course grades” >> “Course registration”.



- 2 The Course registration screen will appear.

From the drop-down menu, select “Term”.

The screenshot shows the course registration interface. At the top left, there is a drop-down menu currently set to '3rd Term'. A red arrow points to this menu with the text 'From the drop-down menu, select “Term”.'. To the right of the menu is a 'Page for printing' button. Below the menu are search options: 'Enter a class schedule format', 'Enter a list format', 'Class schedule search', and 'Direct input of code'. A link 'Move to the intensive course' is visible. The main part of the screen is a grid for '2020 3rd Term' (highlighted by a red box). The grid has columns for days of the week (Mon, Tue, Wed, Thu, Fri, Sat) and rows for course numbers (1, 2). Each cell contains an 'Add' button. A red bracket on the right side of the grid is labeled 'Term currently being displayed'. Another red bracket on the right side is labeled 'Courses with a fixed day and time are displayed here'. Below the grid is a section for 'Intensive, etc.' courses, also with 'Add' buttons. A red bracket on the right side is labeled 'Courses without a fixed day and time are displayed here'. A link 'move to the normal tuition' is at the bottom left.

Select "list format" to display the course information.

2. How to register for courses

Choose one of three ways to register for your courses:

- | | |
|---|---|
| ① | Register using the Course schedule (Click the "add" button on the timetable display page) |
| ② | Register using the Course schedule search |
| ③ | Register by directly entering the course code (4 digits for the year + 6 digits for the lecture number) |

2-1. Register using the Course schedule

- 1 After confirming the day and time of the desired course, click the "add" button in the corresponding time period.

2 A new window will open displaying all of the courses within your curriculum offered at that time period.

- * Even if a certain course is not counted towards the graduation requirement, it will be displayed if the course is available for you to register.

Click the “add” button for the course you wish to register.

① General Education ② Own faculty own course ③ Courses from other courses ④ Other Faculty										
Mon 1 • 2Period										
	Faculty name	Class schedule code	Subject title	Instructor name		Number of credits	Select Section	Capacity	Registrants	Notes
1	General Education courses	2021913001	English (Speaking)-1	Staff name	<input type="button" value="Add"/>	0.50				
2	General Education courses	2021913002	English (Speaking)-1	Staff name	<input type="button" value="Add"/>	0.50				
3	General Education courses	2021913003	English (Speaking)-1	Staff name	<input type="button" value="Add"/>	0.50				
	General									

Click on the course name to view the syllabus.

①	General Education courses	General education subjects in the curriculum
②	Courses from own department and own course	Applicable for education faculty teaching course
③	Courses from other courses	Courses that fall outside the curriculum in your faculty or course, but are open to other students
④	Other Faculty	

3 If there is no problem with the error checking process, the course will be displayed in the timetable as follows:

3rd Term			
Enter a class schedule format Enter a list format			
Click 'Add' to display the schedule			
Move to the intensive course			
20			
	Mon	Tue	We
	2020911447 1 credit 3rd Term [Life] Scientific investigation of human beings Staff name <input type="button" value="Delete"/>		<input type="button" value="Add"/>

2-2. Register using the Class schedule search

After clicking on “Class schedule search”, a new window will open displaying the advanced search box shown below. You can search for a course using any of the following fields: Faculty, Department, Day of Week, Period, Course Title, and Instructor.

Find class schedule. Enter your search criteria and press the Search button.

Faculty	General Education courses[91]
Department	-----
Day of week	Mon.
Period	-----
Subject title	-----
Instructor	-----

Close Search

Partial match search

Timetable List											
	Faculty name	Class schedule (course) code	Subject title	Instructor name		Number of credits	Segment to select	Period	Capacity	Number of registered students	Notes
1	General Education courses	2021910101	Elementary Mathematics 1		Add	1		Mon. 7~8			

2-3. Register by directly entering the course code

After clicking on “Direct input of code”, a new window will open, as shown below. In the space provided, enter the relevant course code. (Please note that you should look up the course code in advance.)

Course code: 4 digits for the year + 6 digits for the lecture number

Please enter a timetable code directly.

Class schedule (course) code	2020911025
------------------------------	------------

Close Add

2-4. If an error occurs

If an error occurs, it will be displayed as follows, so please check the syllabus to confirm registration requirements. If you cannot understand the cause of the error, please inquire at the Academic Support office in the faculty where the course is offered.

General Education	Own faculty own course	Courses from other courses	Other Faculty
<p>時間割番号：2021913001 科目名：English (Speaking)-1 ERROR21:この科目は既に修得済みです/You have already earned credits for this course</p>			

Types of errors (example)

Error code	Error message	Reason /Appropriate response
11	同一曜日・時限に複数の科目が申告されています/Duplicate course registration error	The Course has been registered.
21	この科目は既に修得済みです/You have already earned credits for this course	A course for which you earned credits and which cannot be repeated has been chosen. The course must be deleted.
35	この科目を履修できる年次ではありません/Registration qualification error	You cannot take the course because registration is restricted to students from certain faculties or years. Please check the syllabus.
37	この科目を履修できる所属ではありません/Registration qualification error	
41	この科目は履修できません/Error not related to the curriculum	Please contact the Academic Support office of your faculty.
51	次の科目を履修しないと履修できません/Prerequisite error	You have not earned the necessary credits or have not met the requirements to take the course. Please check the syllabus.
52	次の科目を履修しているため履修できません/Prerequisite error	
62	履修上限を越えています/You have reached the maximum credits for this term	You exceed the credit cap (this varies according to faculty). The registered course must be deleted.
91	休学中は履修申請できません/Leave of Absence	Students on leave of absence, study abroad and suspended cannot register for the course. Please contact the Academic Support office of your faculty.
92	留学中は履修申請できません/Study Abroad	
93	停学中は履修申請できません/Suspended from university	

3. How to drop a course

In order to drop a course, click the “*delete*” button displayed on the timetable.

Students should be able to drop any course during the Course Registration Period and Course Modification Period; however, there may be some courses that students are not able to drop by themselves. For example, courses registered by the Academic Support division.

3rd Term ▾

Enter a class schedule format [Enter a list format](#)

Click 'Add' to display the schedule

[↓ Move to the intensive course](#)

	Mon	Tue	We
	2020911447 1 credit 3rd Term [Life] Scientific investigation of human beings Staff name		
	<input type="button" value="Delete"/>	<input type="button" value="Add"/>	



Course schedule and calendar



1. Course schedule

You can see the registered courses for each term by accessing your course schedule.

- 1 From the top menu, select “Course grades” >> “Course schedule”.



- 2 You will be redirected to your course schedule page. From the drop-down menu, select the relevant academic term. (Initially, nothing is displayed, so please specify the term.)

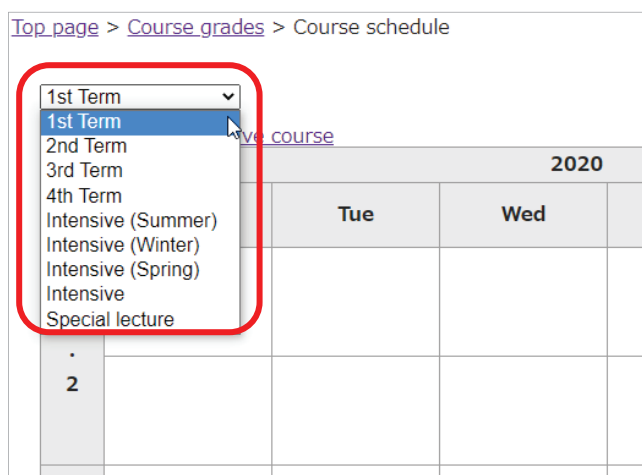

- 3 If you click on the course code, you will be forwarded to the course syllabus. If you click on the course name, you will be redirected to the Moodle page for that course.

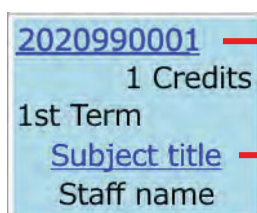

Click on the course code to see the syllabus.



Click on the course name to access the Moodle course page.

Background colors on the timetable and what they mean:

2020990001 1 Credits 1st Term Subject title Staff name	Pale blue	General Education courses	2020990001 1 Credits 1st Term Subject title Staff name	Yellow	Subjects from different departments and faculties
2020990001 1 Credits 1st Term Subject title Staff name	Yellow green	Major courses (own faculty /major)	2020990001 1 Credits 1st Term Subject title Staff name	Light blue	Specially permitted courses by academic support faculty
2021910601 1Credit 1st Term Basic Studies in Humanities STAFF Name ×既修得エフー	Red	Course registration error (requires correction)			

2. Calendar

You can see your schedule from the top page. When you click on the course code of a particular course on the schedule table, you will be able to see the details of that course. Click on the course name to access the Moodle course.

Adding a Schedule

Week Month

2020/07/06

Schedule table

	7/6 (Mon)	7/7 (Tue)	7/8 (Wed)	7/9 (Thu)	7/10 (Fri)	7/11 (Sat)	7/12 (Sun)
08:00							
09:00	2020091211 1 Electronic Circuits		2020091285 1 Thermodynamics I	2020091271 1 Vector and Complex Analyses			
10:00	2020091211 2 Electronic Circuits		2020091285 2 Thermodynamics I	2020091271 2 Vector and Complex Analyses			
11:00	2020091271 3 Vector and Complex Analyses		2020091217 3 Partial Differential Equation	2020091211 3 Electronic Circuits			

Click on the course name to access the Moodle course page.

Click on the course code to see the course details.

Detailed class schedule

Year	Schedule number	Subject title	Chief instructor	Day/Period	Time span	Number of credits
2020	2020091211	Electronic Circuits	KYOIN Shimei	Mon.1, Mon.2, Thr.3, Thr.4	2nd Term	2

No	Date	Period	Hour	Classroom name	Instructor	Class title	Classroom tips	Notes
1	2020/06/15(Mon)	01~01	08:40 ~ 09:40	Faculty of Engineering Lecture Room 3	KYOIN Shimei1, KYOIN Shimei2			
2	2020/06/15(Mon)	02~02	09:50 ~ 10:50	Faculty of Engineering Lecture Room 3	KYOIN Shimei1, KYOIN Shimei2			
3	2020/06/18(Thu)	03~03	11:00 ~	Faculty of Engineering	KYOIN Shimei1, KYOIN			

Syllabus



A syllabus describes the outline, objective, plan, etc. of each course.

Please be sure to confirm it.

1 From the top menu, select "Course grades" >> "Syllabus".



2 A new window will open displaying the syllabus search.

Syllabus

Semester
Year: 2021

Faculty, etc.
Faculty: [dropdown]
Department: [dropdown]
Course: [dropdown]

Schedule
Term: [dropdown]
Day of week: [dropdown]
Period: [dropdown]
Course No. (enter first few digits): [input]

Word search (partial word searches are enabled)
Course title search: [input]
Instructor name search: [input]
Full-text search: [input]
SDGs: [input]

Class by teachers with practical experience
 Please check if you want to search for subjects where classes by professors with practical experience will be held.

Numbering code
分野(AREA): Step1 [dropdown], Step2 [dropdown], Step3 [dropdown], Step4 [dropdown]
授業形態(t): 0:Lecture 1:Exercises 2:Experiments, Training, Practical 3:PBL, TBL, SGD 4:e-learning 5:Other
対象学生(TGET): [dropdown]
レベル(x): 0:Introductory level 1:Freshmen 2:Sophomore 3:Junior 4:Senior 5:Between the Senior and master's degrees 6:Master's degrees 7:Doctor's degrees
特別な注意(W): A:Attention N:No-Attention
num area name: [input]

Search
Clear conditions
Close

Return to top

Faculty / Department

Term/Semester, Day of the week, Period, Course number

Free word search

Numbering code search

3 The search results are listed as shown below.

To show the details, click the “JPN”(Japanese) or “Eng” (English) button.

Number of items to display 30 items at a time								
	Course No.	Jpn	Eng	Course title	Instructor(s)	Term	Day & Period	Numbering code
1	910101	Jpn	Eng	Elementary Mathematics 1		1st Term	Mon.7~8	UGSZ0LAFZ0001N
2	910102	Jpn	Eng	Elementary Mathematics 2		2nd Term	Mon.7~8	UGSZ0LAFZ0002N
3	910103	Jpn	Eng	Elementary Biology 1		1st Term	Mon.7~8	NBBZ0LAFZ0001N
4	910104	Jpn	Eng	Elementary Biology 1		1st Term	Thr.7~8	NBBZ0LAFZ0002N

4 The details of a syllabus are shown.

Please check the contents carefully before registering for the course.

Page for link		For printing	
2021 1st Term		General Education courses	
		Jpn / Eng: English	
初等数学 1 Elementary Mathematics 1			
Course No.	Classification	Term	
910101	General Education Courses	1st Term	
Numbering code	Classroom		
UGSZ0LAFZ0001N	Building for General Education A32		
Required / Elective			
Not Required			
Number of credits	Day & Period		
1	Mon.7~8		
Instructor(s)			
Target students			
All Faculties			
Open to other faculties			
See "Target students" above.			
Contact information			
Please take advantage of office hours.			
Office hours			
It is after the lecture.			

* For details of the “numbering code”, refer to the page below.

Okayama University official website (in Japanese):

ナンバリングとは (What is numbering?)

<https://www.okayama-u.ac.jp/tp/student/numbering.html>



Checking your transcript



You can check the classes you have registered for, the credits you have earned, and your grades.

- To check with a computer -> go to the next page
- To check with a smartphone or tablet => go to page 21

1. To check your transcripts with a computer

Log in to the Academic Affairs System from the Okayama University page, and click “Course grades”»”Course grades”

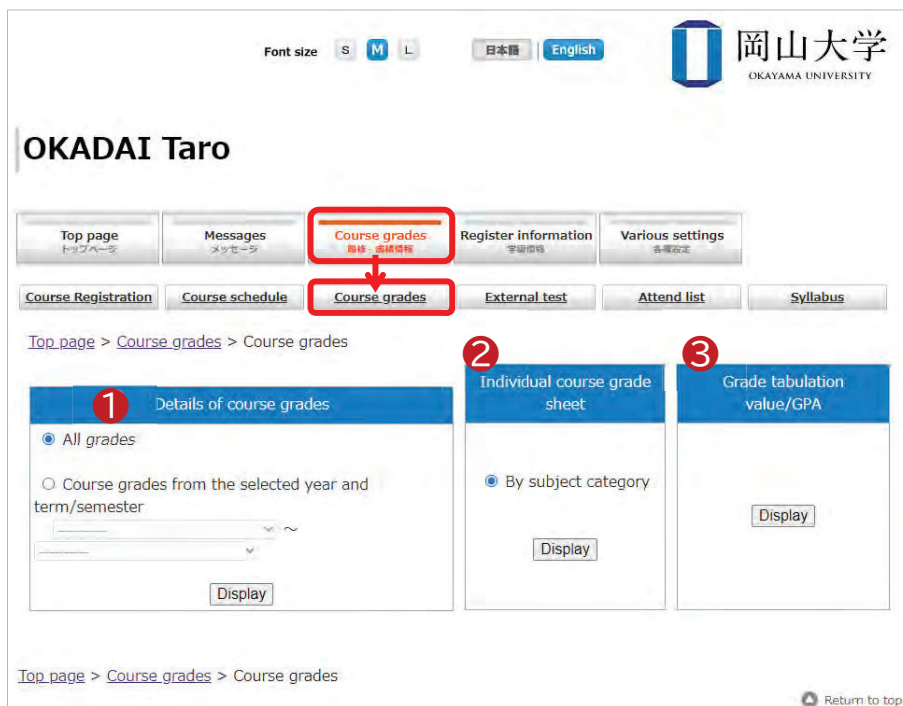

① Details of course grades	Check your registration and credits on the web page.
② Individual course grade sheet	View a printable version of your transcript.
③ Grade tabulation value/GPA	View statistics of your credits, GPA, and registration status.

Medical examination



You can view the results of your medical checkup online. Please check with the Health Service Center for the posting dates.

- 1 Click on 'Register information' and then select 'Health information'.

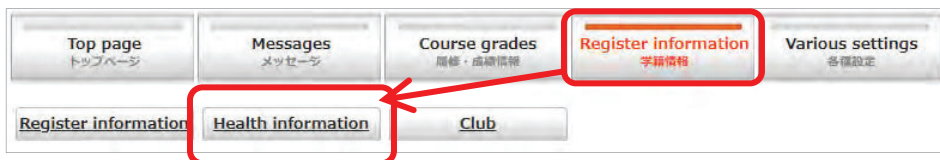

- 2 The results of your annual medical checkup will be displayed. Information may be missing depending on the checkup status and year. For more details, please contact the Health Service Center (086-251-7189, Tsushima campus)

Top page > School register – Student information > Health information

Inspection Item	Normal reference value	2019年 4月 9日	2018年 4月 16日	2017年 4月 3日
Height		159	157	156
Weight		58	52	57
BMI	18.5-25.0	23	21	24
Fat rate	Obesity Standards: Male >25%; Female >30%			25
Urine	Protein	(-)(+)		-
	Blood	(-)(+)		-
	Sugar	(-)		-
Pressure	High	[Hypertension] > 140 mmHg	100	100
	Low	[Hypertension] > 90 mmHg	60	60
X-ray		異常なし	異常なし	異常なし
Cardio				
Blood	ALT	≤40		
	Tcho	130-219		
	Ua	2.5-7.5		
	Hb	Male >13.5; Female >12.0		
	HBS antigen	(-)		
	LDLcho	70-139		
	HbA1c	4.6-6.2		
	Creatinine	Male 0.6-1.1; Female 0.5-0.8		
Eye	right:			
	left:			
Internal		異常なし	異常なし	異常なし
Note				

Top page > School register – Student information > Health information

[Return to top](#)

Okayama University Moodle system



Moodle is the name of the Learning Management System (LMS) at Okayama University. It supports your classes and other learning activities online. In the Moodle system, the contents of each course, such as lecture materials, references, quizzes, assignments and class evaluations, are managed.

* You must check with the instructor of each class and follow their instructions regarding Moodle, as it is used differently depending on the course.

1. How to access Moodle

1 Access Moodle through the following URL or QR code.

- Okayama University Moodle

<https://moodle.el.okayama-u.ac.jp/>



*You can view it from off campus by computer or mobile phone.

To access from the Okayama University official homepage, click [在学生・保護者の方](#) from the menu bar on the top → then click on “Moodle” on the banner.

2 The Moodle top page will be displayed. Click on either button below to log in.

Choose the language for titles and other names. The course content will not be written in English unless the instructor writes in English.

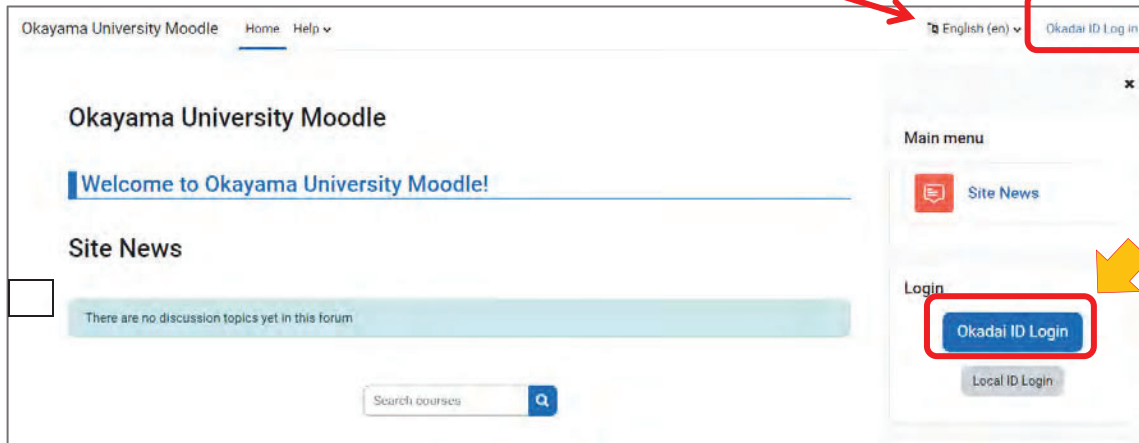

3 Log in with your Okadai ID and password



4 The main “dashboard” page will be displayed after log in. Please make sure your name is on the page.

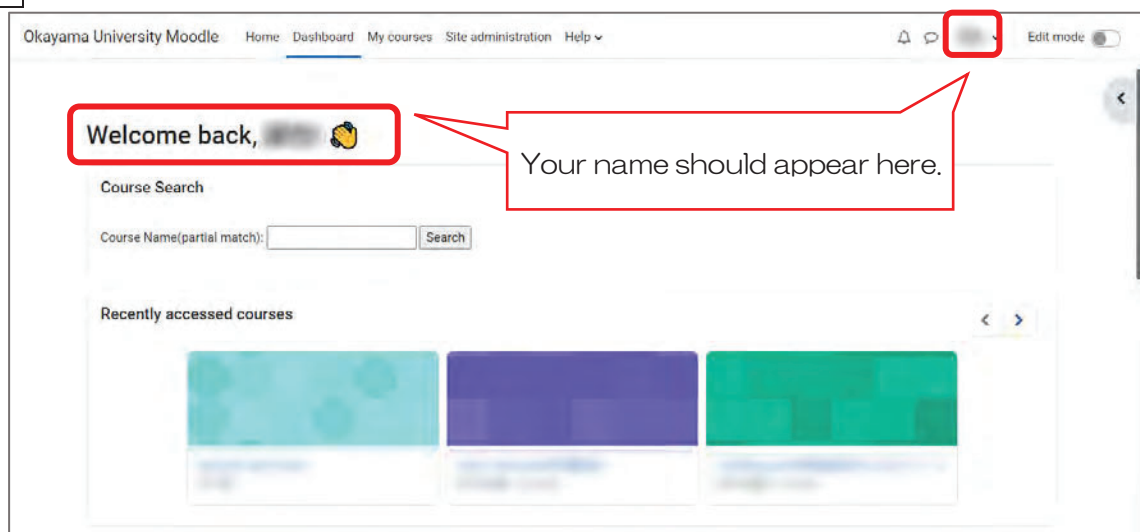

2. Course overview

All available classes will be in the “My courses”.

If you are not automatically registered for a course, follow the instructor’s instructions to register yourself.

- * Course registered by 23:00 will be confirmed in the morning of the **next day** on the Moodle page.

Types	Registration on Moodle system	Available period	Course name
Currently enrolled course	Automatically registered	During academic year after registration	{Academic year + Course number} & Course title
Course evaluation	Automatically registered	Designated period	(Course evaluation) {Academic year + Course number} & Course title
Others	<ul style="list-style-type: none">• Registered by the instructor• Self-registered	Depends on setting	Various names

3. Course Evaluation

Okayama University conducts course evaluations in order to use students’ opinions to facilitate improvements. It is all conducted in the Moodle system anonymously. Your evaluation will not affect your grades.

- * The evaluation period and other details are posted on the homepage and bulletin boards.
- * You will see the link to the evaluation in the Moodle course during the specified period.

< Screen of the course during evaluation period >

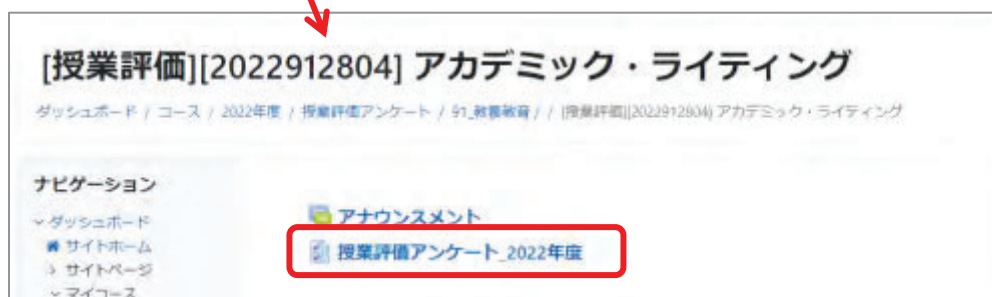
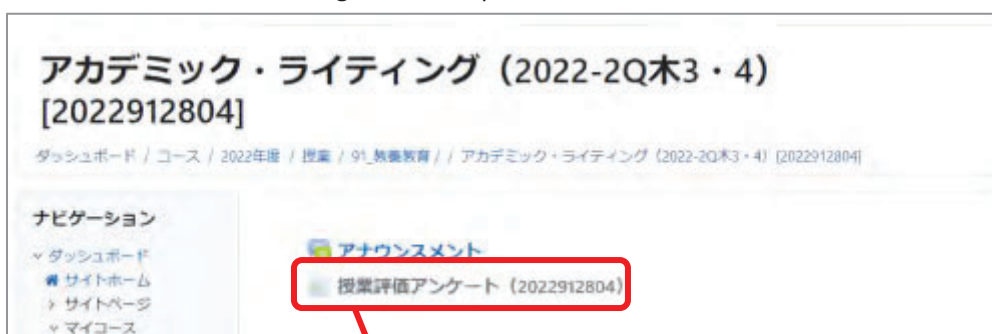

Gmail



Okayama University provides information to students via bulletin boards and the Okayama University official homepage. In addition, important information is sent by email to students' Gmail addresses assigned by Okayama University (hereafter called Gmail), such as notices or advance notices of lecture cancellations due to official weather warnings, important academic matters, and other emergency announcements.

You may receive the following notices via Gmail.

☆ Examples of Gmail messages from the university

- (1) Announcements on course registration, academic performance, etc. from the academic affairs system
- (2) Notices (including advance notices) of lecture cancellations due to weather warnings
- (3) Notices about infectious diseases (e.g. influenza) and messages to prevent the spread of infection
- (4) Notices regarding restrictions of access to the campus due to entrance examinations, etc.
- (5) Notices about seminars and events
- (6) Other announcements about university-related matters

Please check your Gmail messages regularly by auto-forwarding the messages from your Gmail account to your mobile phone or frequently used email account.

Gmail messages will be summaries of important notices from the university. Please check details on the campus bulletin boards and Okayama University website.

- Okayama Univ. Gmail (This page is available only on campus network.)

http://www.okayama-u.ac.jp/user/citm/limiting/eng/service/gmail_home.html

- Login screen for Okayama University Gmail (in Japanese)



<http://mail.s.okayama-u.ac.jp/>



.....

Information desks

- Inquiries about the overall system for academic affairs
Office of Academic Affairs Information System, Academic Affairs Department
ddg7059@adm.okayama-u.ac.jp Phone: +81-86-251-7058, -7059
- Okayama University Moodle
Course instructors and academic administrators

X(Twitter) : @OkadaiMoodle 
- Application for Lottery courses
Academic Support Section, Academic Planning Division, Academic Affairs Department
dah8433@adm.okayama-u.ac.jp Phone: +81-86-251-7248
- Use of the Integrated Authentication System (Okadai ID), Gmail, PCs on campus
Information desk, Center for Information Technology and Management
<https://msgs.csv.okayama-u.ac.jp/a/> 

1st Term

Course List for EPOK 2025-2026 1st Term

※All information listed is subject to change

Quarter	Class Code	Classes	Timetable		Credits	Language J:Japanese E:English	Lecturer(s)	★ Lottery Consult to EPOK office for registration	○ Contact Lecturer before Registration
1	672011	Study of Japan A with SDGs	Wed	5-6	1	E	KHALMIRZAEVA SAIDA		
1 & 2	671505	EPOK Research Project: Spring	Wed	7-8	2	E	IGHRAD Academic Staff		
1	912286	Knowledge and Skill for Globalization Age	Mon	5-6	1	E	TBA		
1	912265	Warrior Tales: The Samurai in Reality and Fiction	Mon	7-8	1	E	KHALMIRZAEVA Saida		
1	131081	Fundamentals of Mathematics	Mon	7-8	1	E	TANG Jian		
1	133081	Anthropology of Science	Mon & Thu	5-6	2	E	UESUGI Takeshi		○
1	131070	Sociological Imagination	Mon & Thu	7-8	2	E	MIYAGAWA Haruna		○
1	132907	Music and Power	Mon	9-10	1	E	SAWA Tomoe		
1	912257	Japanese Agriculture and Rural Society	Thu	3-4	1	E	INAMORI Takao		
1	673153	Writing about Movies: Topics and Terms for Film Analysis	Tue	5-6	1	E	MEIKI Susan Mary		
1	132028	Introduction to Applied Plant Science I	Tue	5-6	1	E	Takashi AKAGI and others		○
1	133085	Agrochemical Bioscience 2 - Biological Chemistry	Wed	3-4	1	E	KANAO Tadayoshi and others	Check "Prerequisite Course" on the syllabus and Need to contact Lecturer before course registration.	
1	912220	International Student Support Practice	Wed	5-6	1	E & J	UZUKA Mariko	<Remarks> More than 30 hours of actively involvement will be equivalent to one credit.	
1	132908	Religion and Literature in Japan	Thu	3-4	1	E	KHALMIRZAEVA SAIDA		
1	131087	Instrumental Analysis	Thu	5-6	1	E	UDDIN Azhar		○
1	912125	An Exploration of Chanoyu: Ethnography of Art, Mind and History	Thu	5-6	1	E	OBAYAH I Junko	★	
1	673113	Foreign Perspectives of Japan through Documentaries	Thu	7-8	1	E	RUSYNSKI John Edward		

1	131083	Fundamentals of Physics II	Thu	7-8	1	E	TANG Jian	
1	132029	Introduction to Applied Plant Science II	Fri	5-6	1	E	Hidenori MATSUI and others	○
1	131049	Chemistry for Chemical Engineering	Fri	5-6-7	1.5	E	UDDIN Azhar	○
1 Intensive	912294	Learning Japanese language and culture through international co-learning activities	Intensive	Check Syllabus for details	1	E	OBAYAH I Junko, INAMORI Takao, MOHRI Takami, KHALMIRZAEVA Saida, AKITA Miho	
1 Intensive	912295	Studying on Social Issues through international co-learning activities	Intensive	Check Syllabus for details	1	E	INAMORI Takao	
1 Intensive	912048	cross-cultural communication and team building	Intensive April-May	Check Syllabus for details	1	J	FUJIMOTO Masumi, UZUKA Mariko, SEKIMOTO Atsushi	Need to contact Lectuere before the registration! Only available to those who have been approved for registration by Lectuere.Registration will be closed when the number of applicants reaches the limit After receiving the permission, you may register the class via academic affirs system.
1 Intensive	912026	Field Work : Participation in Jinsho Traditional Festival in Misasa, Tottori	Intensive May	Check Syllabus for details	1	E & J	FUJIMOTO Masumi, INAMORI Takao	Need to contact Lectuere before the registration! Only available to those who have been approved for registration by Lectuere.Registration will be closed when the number of applicants reaches the limit After receiving the permission, you may register the class via academic affirs system.
1 & 2	132061	Nonprofit Management and Social Entrepreneurship	Mon & Thu	7-8	4	E	YOSHIOKA Takayuki	Check "Prerequisite Course" on the syllabus before course registration.
1 & 2	132056	International Economics	Tue	3-4	2	E	YAMAMOTO Yumiko	Check "Prerequisite Course" on the syllabus and Need to contact Lecturer before course registration.
1 & 2	132066	Fundamentals of Molecular Spectroscopy	Tue	7-8	2	E	TANG Jian	
1 & 2	133082	Anthropology of the Self	Tue & Fri	5-6	4	E	UESUGI Takeshi	○
1 & 2	131072	Introduction to Political Science	Wed	7-8	3	E	OSAWA Kimiko	

1 & 2	133068	Topics in Political Science I	Thu	3-4	2	E	OSAWA Kimiko	Check "Prerequisite Course" on the syllabus before course registration.
1 & 2	133034	Biomass and Bioenergy	Fri	1-2	2	E	UDDIN Azhar	○
1 & 2	133064	Introduction to Feminist Economics	Fri	3-4	2	E	YAMAMOTO Yumiko	Check "Prerequisite Course" on the syllabus and Need to contact Lecturer before course registration.

Japanese Language Courses

※Check Japanese Language Course website for details

Quarter	Class Code	Classes	Timetable	Credits	Language	Lecturer(s)	Class Room for In-person classes	
1		Japanese1-1 (Placement Test Score 0-30)	Mon, Tue, Wed, Thu	1-2	4	J	SUESHIGE Miwa, ENDO Midori	Check JP course Page
1		Japanese2-1 (Placement Test Score 31-47)	Tue, Wed, Thu, Fri	1-2	4	J	SATOH Miho, MIURA Atsuko	Check JP course Page
1		Japanese2-1 (Placement Test Score 31-47)	Mon, Tue, Wed, Thu	1-2	4	J	KOMIYA Saori, UMEKAWA Yuko	Check JP course Page
1		Japanese3-1 (Placement Test Score 48-58)	Mon, Wed, Thu, Fri	3-4	4	J	NAGANO Masumi, Ota Saeko	Check JP course Page
1		Japanese4-1 (Placement Test Score 59-68)	Mon, Tue, Wed, Fri	3-4	4	J	MORIYA Tomomi, UOI Kayo	Check JP course Page
1		Japanese5-1 (Placement Test Score 69-74)	Mon, Tue, Wed, Thu	1-2	4	J	UCHIMARU Yukako, WAKI Takako	Check JP course Page
1		Japanese6-1 (Placement Test Score 75-82)	Mon, Tue, Thu, Fri	1-2	4	J	AOI Yuka, AKITA Setsuko	Check JP course Page
1		Applied Japanese (Listening A1) (Placement Test Score 83-100)	Thu	1-2	1	J	NAGANO Masumi	Check JP course Page
1		Applied Japanese (Writing B1) (Placement Test Score 83-100)	Tue	5-6	1	J	MORIYA Tomomi	Check JP course Page
		Applied Japanese (Speaking B1) (Placement Test Score 83-100)	Fri	1-2	1	J	UCHIMARU Yukako	Check JP course Page
1		Applied Japanese (Reading A1) (Placement Test Score 83-100)	Mon	3-4	1	J	SUESHIGE Miwa	Check JP course Page
1		Japanese through Films1-1 (Placement Test Score 48-68)	Fri	1-2	1	J	NISHIYAMA Reiko	Check JP course Page
1		Japanese through Films2-1 (Placement Test Score 69-100)	Fri	5-6	1	J	UOI Kayo	Check JP course Page
1		Extensive Reading 1-1 (Placement Test Score 48-74)	Thu	5-6	1	J	AKITA Setsuko	Check JP course Page

1		Extensive Reading 2-1 (Placement Test Score 75-100)	Wed	1-2	1	J	Ota Saeko	Check JP course Page
1		Study of Japan 1 (Placement Test Score 75-100)	Fri	3-4	1	J	NISHIYAMA Reiko	Check JP course Page
1		Survival Japanese 1 (Placement Test Score 0-30)	Fri	1-2	1	J	MIURA Atsuko	Check JP course Page
1		Media Literacy 2-1	Mon	5-6	1	J	SUESHIGE Miwa	Check JP course Page
1		Basic Kanji and Vocabulary 1 (Placement Test Score 31-58)	Tue	3-4	1	J	AOI Yuka	Check JP course Page
1		Intermediate Kanji and Vocabulary 1 (Placement Test Score 59-74)	Wed	5-6	1	J	KUROKAWA Yumiko	Check JP course Page
1		Intermediate Grammar 1-1 (Placement Test Score 48-68)	Mon	5-6	1	J	AOI Yuka	Check JP course Page
1		Intermediate Grammar 2-1 (Placement Test Score 69-100)	Thu	3-4	1	J	MORIYA Tomomi	Check JP course Page
1		Reading and Writing 1-1 (Placement Test Score 0-47)	Mon & Thu	3-4	2	J	UMEKAWA Yuko	Check JP course Page
1		Reading and Writing 2-1 (Placement Test Score 31-58)	Tue & Fri	5-6	2	J	SATOH Miho	Check JP course Page

This will
be an
online
class.

2nd Quarter

Course List for EPOK 2025-2026 2nd Term

※All information listed is subject to change

Quarter	Class Code	Classes	Timetable		Credits	Language	Lecturer(s)	★ Lottery Consult to EPOK office for registration	○ Contact Lecturer before Registration
			J:Japanese E:English						
2	672012	Study of Japan with SDGs	Wed	5-6	1	E&J	INAMORI Takao		
2	132058	International Politics	Mon	3-4	1.5	E	OSAWA Kimiko	Check "Prerequisite Course" on the syllabus before course registration.	
2	912282	What is Japanese University - its structure and function-	Mon	3-4	1	E	TBA		
2	912267	Gender and Society in Japan	Mon	5-6	1	E	KHALMIRZAEVA Saida		
2	912202	Self exploration through Creativity	Mon	7-8	1	E	MAHAMOOD Sabina	★	
2	132004	Urban Sociology	Mon & Thu	5-6	2	E	MIYAGAWA Haruna	Check "Prerequisite Course" on the syllabus and Need to contact Lecturer before course registration.	
2	131078	Culture and Illness	Mon & Thu	7-8	2	E	UESUGI Takeshi		○
2	131048	Modern Physics	Mon & Thu	8 7-8	1.5	E	TANG Jian		
2	132030	Introduction to Animal Science	Tue	5-6	1	E	NAOKI Nishino, KIMURA Koji		○
2	131047	Mathematics for Physical Chemistry	Tue & Thu	5 5-6	1.5	E	UDDIN Azhar		○
2	133086	Agrochemical Bioscience 3 - Organic Chemistry	Wed	3-4	1	E	KIYOTA Hiromasa and others	Check "Prerequisite Course" on the syllabus and Need to contact Lecturer before course registration.	
2	132047	Introduction to Agrochemical Bioscience	Wed	5-6	1	E	KANAO Tadayoshi and others		○
2	912221	International Student Support Practice	Wed	5-6	1	E&J	UZUKA Mariko	<Remarks> More than 30 hours of actively involvement will be equivalent to one credit.	
2	912258	Area Studies: Approaches and Methodologies	Thu	3-4	1	E	INAMORI Takao		
2	912262	Introduction to Area Studies on Hawaii I	Thu	5-6	1	E	OBAYASHI Junko	★	
2	132027	Introduction to Environmental Ecology	Fri	5-6	1	E	DATAI Hisashi and others		○
2 Intensive	912030	Tourism in Okayama 1	Intensive	Check Syllabus for details	1	E	FUJIMOTO Masumi, INAMORI Takao	Before registering for this class, be sure to submit a request for permission to the instructor in charge of this class and obtain permission.	

Japanese Language Course

※Check Japanese Language Course website for details

Quarter	Class Code	Classes	Timetable	Credits	Language	Lecturer(s)	Class Room for In-person classes	
2		Japanese1-2 (Placement Test Score 0-30)	Mon, Tue, Wed, Thu	1-2	4	J	SUESHIGE Miwa, ENDO Midori	Check JP course Page
2		Japanese2-2 (Placement Test Score 31-47)	Tue, Wed, Thu, Fri	1-2	4	J	SATOH Miho, MIURA Atsuko	Check JP course Page
2		Japanese2-2 (Placement Test Score 31-47)	Mon, Tue, Wed, Thu	1-2	4	J	KOMIYA Saori, UMEKAWA Yuko	Check JP course Page
2		Japanese3-2 (Placement Test Score 48-58)	Mon, Wed, Thu, Fri	3-4	4	J	NAGANO Masumi, Ota Saeko	Check JP course Page
2		Japanese4-2 (Placement Test Score 59-68)	Mon, Tue, Wed, Fri	3-4	4	J	MORIYA Tomomi, UOI Kayo	Check JP course Page
2		Japanese5-2 (Placement Test Score 69-74)	Mon, Tue, Wed, Thu	1-2	4	J	UCHIMARU Yukako, WAKI Takako	Check JP course Page
2		Japanese6-2 (Placement Test Score 75-82)	Mon, Tue, Thu, Fri	1-2	4	J	AOI Yuka, AKITA Setsuko	Check JP course Page
2		Applied Japanese (Listening A2) (Placement Test Score 83-100)	Thu	1-2	1	J	NAGANO Masumi	Check JP course Page
2		Applied Japanese (Writing B2) (Placement Test Score 83-100)	Tue	5-6	1	J	MORIYA Tomomi	Check JP course Page
2		Applied Japanese (Speaking B2) (Placement Test Score 83-100)	Fri	1-2	1	J	UCHIMARU Yukako	Check JP course Page
2		Applied Japanese (Reading A2) (Placement Test Score 83-100)	Mon	3-4	1	J	SUESHIGE Miwa	Check JP course Page
2		Japanese through Films1-2 (Placement Test Score 48-68)	Fri	1-2	1	J	NISHIYAMA Reiko	Check JP course Page
2		Japanese through Films2-2 (Placement Test Score 69-100)	Fri	5-6	1	J	UOI Kayo	Check JP course Page
2		Extensive Reading 1-2 (Placement Test Score 48-74)	Thu	5-6	1	J	AKITA Setsuko	Check JP course Page
2		Extensive Reading 2-2 (Placement Test Score 75-100)	Wed	1-2	1	J	Ota Saeko	Check JP course Page
2		Study of Japan 2 (Placement Test Score 75-100)	Fri	3-4	1	J	NISHIYAMA Reiko	Check JP course Page
2		Survival Japanese 2 (Placement Test Score 0-30)	Fri	1-2	1	J	MIURA Atsuko	Check JP course Page

This will be
an online
class.

2		Media Literacy 2-2	Mon	5-6	1	J	SUESHIGE Miwa	Check JP course Page
2		Basic Kanji and Vocabulary 2 (Placement Test Score 31-58)	Tue	3-4	1	J	AOI Yuka	Check JP course Page
2		Intermediate Kanji and Vocabulary 2 (Placement Test Score 59-74)	Wed	5-6	1	J	KUROKAWA Yumiko	Check JP course Page
2		Intermediate Grammar 1-2 (Placement Test Score 48-68)	Mon	5-6	1	J	AOI Yuka	Check JP course Page
2		Intermediate Grammar 2-2 (Placement Test Score 69-100)	Thu	3-4	1	J	MORIYA Tomomi	Check JP course Page
2		Reading and Writing 1-2 (Placement Test Score 0-47)	Mon & Thu	3-4	2	J	UMEKAWA Yuko	Check JP course Page
2		Reading and Writing 2-2 (Placement Test Score 31-58)	Tue & Fri	5-6	2	J	SATOH Miho	Check JP course Page

3rd Term

Course List for EPOK 2025-2026 3rd Term

※All information listed is subject to change

Quarter	Class Code	Classes	Timetable		Credits	Language J:Japanese E:English	Lecturer(s)	★ Lottery Consult to EPOK office for registration	○ Contact Lecturer before Registration
3	672013	Study of Japan C with SDGs	Wed	5-6	1	E	MOHRI Takami		
3 & 4	671506	EPOK Research Project: all	Wed	7-8	2	E	IGHRAD Academic Staff		
3	912266	Japanese Performing Arts	Mon	1-2	1	E	KHALMIRZAEVA Saida		
3	912259	Working in Cross-cultural Organizations	Mon	3-4	1	E	INAMORI Takao		
3	132053	Sociology of Migration I	Mon & Thu	3-4	2	E	MIYAGAWA Haruna	Check "Prerequisite Course" on the syllabus and Need to contact Lecturer before course registration.	
3	131041	Introduction to Microeconomics	Mon	5-6	1.5	E	YAMAMOTO Yumiko		
3	912283	International Student - What is the Significance of Studying Abroad	Mon	5-6	1	E	TBA		
3	912205	Role of Identity in Intercultural Communication	Mon	7-8	1	E	MAHAMOOD Sabina	★	
3	131076	Philanthropy and Nonprofit Organizations	Mon & Thu	9-10	2	E	YOSHIOKA Takayuki		
3	912206	Introduction to wellness experiencing Japanese culture	Tue	5-6	1	E	UZUKA Mariko	★	
3	132005	Medical Anthropology	Tue & Fri	5-6	2	E	UESUGI Takeshi	Check "Prerequisite Course" on the syllabus and Need to contact Lecturer before course registration.	
3	673157	Writing about Movies: Movies and Culture	Tue	7-8	1	E	MEIKI Susan Mary		
3	131084	Quantum Physics and Atomic Structure	Tue	7-8	1	E	TANG Jian		
3	912222	International Student Support Practice	Wed	5-6	1	E&J	UZUKA Mariko	<Remarks> More than 30 hours of actively involvement will be equivalent to one credit.	
3	131073	Introduction to Japanese Politics	Wed	7-8	1.5	E	OSAWA Kimiko		
3	912263	Introduction to Area Studies on Hawaii II	Thu	5-6	1	E	OBAYASHI Junko	★	
3	912268	Japanese Society and Culture Through Literature I	Thu	7-8	1	E	KHALMIRZAEVA SAIDA		
3	131082	Fundamentals of Physics I	Thu	7-8	1	E	TANG Jian		
3	131088	Introduction to Catalytic Chemistry	Fri	1-2	1	E	UDDIN Azhar		○

3	673156	Humor and Cross-Cultural Communication	Fri	7-8	1	E	RUCYNSKI John Edward	
3 Intensive	912039	Tourism in Okayama 2	Intensive	Check Syllabus for details	1	E	FUJIMOTO Masumi, IWABUCHI Yasushi	Need to contact Lectuere before the registration! Only available to those who have been approved for registration by Lectuere.Registration will be closed when the number of applicants reaches the limit After receiving the permission, you may register the class via academic affairs system.
3 Intensive	912040	For Okayama Future	Intensive Oct.	Check Syllabus for details	1	E	FUJIMOTO Masumi	Need to contact Lectuere before the registration! Only available to those who have been approved for registration by Lectuere.Registration will be closed when the number of applicants reaches the limit After receiving the permission, you may register the class via academic affairs system.
3 & 4	133071	Topics in Political Science IV	Mon	7-8	2	E	OSAWA Kimiko	
3 & 4	133083	Anthropology of Memory	Mon & Thu	5-6	4	E	UESUGI Takeshi	Check "Prerequisite Course" on the syllabus and Need to contact Lecturer before course registration.
3 & 4	133065	Trade Policy and Development	Tue	3-4	2	E	YAMAMOTO Yumiko	Check "Prerequisite Course" on the syllabus and Need to contact Lecturer before course registration.
3 & 4	133066	Poverty	Wed	5-6	2	E	YAMAMOTO Yumiko	Check "Prerequisite Course" on the syllabus and Need to contact Lecturer before course registration.
3 & 4	131075	Korean Diaspora	Wed	9-10	3	E	CHUNG Haeng-ja	○

Japanese Language Course

※Check Japanese Language Course website for details

Quarter	Class Code	Classes	Timetable	Credits	Language	Lecturer(s)	Class Room for In-person classes	
3		Japanese1-1 (Placement Test Score 0-30)	Mon, Tue, Wed, Thu	1-2	4	J	SUESHIGE Miwa, ENDO Midori	Check JP course Page
3		Japanese1-1 (Placement Test Score 0-30)	Mon, Tue, Wed, Fri	1-2	4	J	MIURA Atsuko, NISHIYAMA Reiko	Check JP course Page
3		Japanese2-1 (Placement Test Score 31-47)	Mon, Tue, Thu, Fri	1-2	4	J	KOMIYA Saori, UMEKAWA Yuko	Check JP course Page
3		Japanese2-1 (Placement Test Score 31-47)	Tue, Wed, Thu, Fri	3-4	4	J	SATOH Miho, AKITA Setsuko	Check JP course Page
3		Japanese3-1 (Placement Test Score 48-58)	Mon, Tue, Wed, Fri	3-4	4	J	NAGANO Masumi, NISHIYAMA Reiko	Check JP course Page
3		Japanese3-1 (Placement Test Score 48-58)	Mon, Wed, Thu, Fri	3-4	4	J	Ota Saeko, KOMIYA Saori	Check JP course Page

3	Japanese 4-1 (Placement Test Score 59-68)	Mon, Wed, Thu, Fri	3-4	4	J	MORIYA Tomomi, UOI Kayo	Check JP course Page
3	Japanese 5-1 (Placement Test Score 69-74)	Mon, Tue, Thu, Fri	1-2	4	J	UCHIMARU Yukako, WAKI Takako	Check JP course Page
3	Japanese 6-1 (Placement Test Score 75-82)	Mon, Tue, Thu, Fri	1-2	4	J	AOI Yuka, AKITA Setsuko	Check JP course Page
3	Applied Japanese (Listening B1) (Placement Test Score 83-100)	Fri	1-2	1	J	NAGANO Masumi	Check JP course Page
3	Applied Japanese (Writing A1) (Placement Test Score 83-100)	Mon	3-4	1	J	MORIYA Tomomi	Check JP course Page
3	Applied Japanese (Speaking A1) (Placement Test Score 83-100)	Thu	3-4	1	J	UCHIMARU Yukako	Check JP course Page
3	Applied Japanese (Reading B1) (Placement Test Score 83-100)	Tue	3-4	1	J	SUESHIGE Miwa	Check JP course Page
3	Japanese through Films 1-1 (Placement Test Score 48-68)	Mon	1-2	1	J	MIURA Atsuko	Check JP course Page
3	Japanese through Films 2-1 (Placement Test Score 69-100)	Mon	5-6	1	J	UOI Kayo	Check JP course Page
3	Extensive Reading 1-1 (Placement Test Score 48-74)	Fri	5-6	1	J	AKITA Setsuko	Check JP course Page
3	Extensive Reading 2-1 (Placement Test Score 75-100)	Thu	5-6	1	J	NAGANO Masumi	Check JP course Page
3	Basic Kanji and Vocabulary1 (Placement Test Score 31-58)	Tue	5-6	1	J	AOI Yuka	Check JP course Page
3	Intermediate Kanji and Vocabulary1 (Placement Test Score 59-74)	Wed	5-6	1	J	KUROKAWA Yumiko	Check JP course Page
3	Intermediate Grammar 1-1 (Placement Test Score 48-68)	Mon	5-6	1	J	AOI Yuka	Check JP course Page
3	Intermediate Grammar 2-1 (Placement Test Score 69 -100)	Wed	1-2	1	J	Ota Saeko	Check JP course Page
3	Study of Okayama1 (Placement Test Score 75-100)	Fri	3-4	1	J	UCHIMARU Yukako	Check JP course Page
3	Reading and Writing 1-1 (Placement Test Score 0-47)	Mon & Tue	3-4	2	J	UMEKAWA Yuko	Check JP course Page
3	Reading and Writing 1-1 (Placement Test Score 0-47)	Tue & Wed	5-6	2	J	MIURA Atsuko	Check JP course Page
3	Reading and Writing 2-1 (Placement Test Score 31-58)	Mon & Thu	5-6	2	J	ENDO Midori	Check JP course Page
3	Reading and Writing 2-1 (Placement Test Score 31-58)	Tue & Fri	5-6	2	J	SATOH Miho	Check JP course Page
3	Media Literacy 1-1 (Placement Test Score 48-68)	Wed	7-8	1	J	KUROKAWA Yumiko	Check JP course Page

4th Term

Course List for EPOK 2025-2026 4th Term

※All information listed is subject to change

Quarter	Class Code	Classes	Timetable	Credits	Language	Lecturer(s)	★ Lottery Consult to EPOK office for registration	○ Contact Lecturer before Registration
4	672014	Study of Japan D with SDGs	Wed	5-6	1	E&J	OBAYASHI Junko	
4	912260	International Cooperation and Project Management	Mon	1-2	1	E	INAMORI Takao	
4	131042	Introduction to Macroeconomics	Mon	5-6	1.5	E	YAMAMOTO Yumiko	
4	912065	Introduction to the Seto inland sea region	Mon	5-6	1	E	YAMAKAWA Junji	★
4	912208	Introduction to Emotional Intelligence	Mon	7-8	1	E	MAHMOOD Sabina	★
4	912284	Let's Explore Attractiveness of Japan	Mon	7-8	1	E	TBA	
4	673171	A Passion for Japan: Living, Working, and Thriving in Japan	Mon	7-8	1	E	RUCYNSKI JOHN EDWARD	
4	133005	Globalization and Development	Mon & Thu	3-4	2	E	MIYAGAWA Haruna	Check "Prerequisite Course" on the syllabus and Need to contact Lecturer before course registration.
4	131077	Global Philanthropy and Comparative Nonprofit Sectors	Mon & Thu	9-10	2	E	YOSHIOKA Takayuki	Check "Prerequisite Course" on the syllabus before course registration.
4	133035	Advanced Catalysis	Tue & Fri	1-2 7-8	2	E	UDDIN Azhar	Check "Prerequisite Course" on the syllabus and Need to contact Lecturer before course registration.
4	131079	Anthropology of Disaster	Tue & Fri	5-6	2	E	UESUGI Takeshi	○
4	673192	Utilizing AI Prompt Engineering Correctly for English Writing	Tue	5-6	1	E	MEIKI Susan Mary	
4	132069	Introduction to Astrochemistry and Atmospheric Chemistry	Tue	7-8	1	E	TANG Jian	
4	133084	Agrochemical Bioscience 1 - Analytical Chemistry	Wed	3-4	1	E	TAMURA Takashi and others	○
4	132909	Female Writers and Characters in Japanese Literature	Wed	3-4	1	E	KHALMIRZAEVA SAIDA	
4	912223	International Student Support Practice	Wed	5-6	1	E&J	UZUKA Mariko	<Remarks> More than 30 hours of actively involvement will be equivalent to one credit.
4	912219	Job Search for International Students	Wed	7	0.5	E&J	UZUKA Mariko	

4	132904	Social Issues in Contemporary Japan	Thu	3-4	1	E	OSAWA Makoto	
4	912261	Environmental Education Methods	Thu	3-4	1	E	INAMORI Takao	
4	912126	An Exploration of Chanoyu: Mind and Practice	Thu	5-6	1	E	OBAYASHI Junko	★
4	131051	Introduction to Agricultural Sciences	Thu	5.6.7	1.5	E	TAMURA Takashi and others	
4	912269	Japanese History and Religion	Thu	7-8	1	E	KHALMIRZAEVA SAIDA	
4	912211	Introduction to the 8 dimensions of Wellness	Thu	7-8	1	E	MAHMOOD Sabina	★
4	673161	Teaching Foreign Languages	Thu	7-8	1	E	PRICHARD Caleb	
4	131085	Chemical Bonding and Molecular Structure	Thu	7-8	1	E	TANG Jian	
4	912285	Engaging with the Diversity of Japanese Society through Dialogue	Thu	7-8	1	E	AKITA Miho	★
4	912264	Japanese Language Education in a Global Society	Fri	5-6	1	E & J	MOHRI Takami	★
4	131086	Fundamentals of Chemistry	Fri	5-6	1	E	UDDIN Azhar	
4	912270	Japanese Society and Culture Through Literature II	Fri	7-8	1	E	KHALMIRZAEVA Saida	
4 Intensive	912042	Learning about Japanese Railroads from Practice	Intensive	Check Syllabus for details	1	J	FUJIMOTO Masumi	Only students who are proficient in Japanese and foreign languages can take this course. Please consult with your instructor before registering for this course.

Japanese Language Course

※Check Japanese Language Course website for details

Quarter	Class Code	Classes	Timetable	Credits	Language	Lecturer(s)	Class Room for In-person classes	
4		Japanese1-2 (Placement Test Score 0-30)	Mon, Tue, Wed, Thu	1-2	4	J	SUESHIGE Miwa, ENDO Midori	Check JP course Page
4		Japanese1-2 (Placement Test Score 0-30)	Mon, Tue, Web, Fri	1-2	4	J	MIURA Atsuko, NISHIYAMA Reiko	Check JP course Page
4		Japanese2-2 (Placement Test Score 31-47)	Mon, Tue, Thu, Fri	1-2	4	J	KOMIYA Saori, UMEKAWA Yuko	Check JP course Page
4		Japanese2-2 (Placement Test Score 31-47)	Tue, Wed, Thu, Fri	3-4	4	J	SATOH Miho, AKITA Setsuko	Check JP course Page
4		Japanese3-2 (Placement Test Score 48-58)	Mon, Tue, Wed, Fri	3-4	4	J	NAGANO Masumi, NISHIYAMA Reiko	Check JP course Page
4		Japanese3-2 (Placement Test Score 48-58)	Mon, Wed, Thu, Fri	3-4	4	J	Ota Saeko, KOMIYA Saori	Check JP course Page

4	Japanese 4-2 (Placement Test Score 59-68)	Mon, Wed, Thu, Fri	3-4	4	J	MORIYA Tomomi, UOI Kayo	Check JP course Page
4	Japanese 5-2 (Placement Test Score 69-74)	Mon, Tue, Thu, Fri	1-2	4	J	UCHIMARU Yukako, WAKI Takako	Check JP course Page
4	Japanese 6-2 (Placement Test Score 75-82)	Mon, Tue, Thu, Fri	1-2	4	J	AOI Yuka, AKITA Setsuko	Check JP course Page
4	Applied Japanese (Listening B2) (Placement Test Score 83-100)	Fri	1-2	1	J	NAGANO Masumi	Check JP course Page
4	Applied Japanese (Writing A2) (Placement Test Score 83-100)	Mon	3-4	1	J	MORIYA Tomomi	Check JP course Page
4	Applied Japanese (Speaking A2) (Placement Test Score 83-100)	Thu	3-4	1	J	UCHIMARU Yukako	Check JP course Page
4	Applied Japanese (Reading B2) (Placement Test Score 83-100)	Tue	3-4	1	J	SUESHIGE Miwa	Check JP course Page
4	Japanese through Films 1-2 (Placement Test Score 48-68)	Mon	1-2	1	J	MIURA Atsuko	Check JP course Page
4	Japanese through Films 2-2 (Placement Test Score 69-100)	Mon	5-6	1	J	UOI Kayo	Check JP course Page
4	Extensive Reading 1-2 (Placement Test Score 48-74)	Fri	5-6	1	J	AKITA Setsuko	Check JP course Page
4	Extensive Reading 2-2 (Placement Test Score 75-100)	Thu	5-6	1	J	NAGANO Masumi	Check JP course Page
4	Basic Kanji and Vocabulary2 (Placement Test Score 31-58)	Tue	5-6	1	J	AOI Yuka	Check JP course Page
4	Intermediate Kanji and Vocabulary2 (Placement Test Score 59-74)	Wed	5-6	1	J	KUROKAWA Yumiko	Check JP course Page
4	Intermediate Grammar 1-2 (Placement Test Score 48-68)	Mon	5-6	1	J	AOI Yuka	Check JP course Page
4	Intermediate Grammar 2-2 (Placement Test Score 69-100)	Wed	1-2	1	J	Ota Saeko	Check JP course Page
4	Study of Okayama2 (Placement Test Score 75-100)	Fri	3-4	1	J	UCHIMARU Yukako	Check JP course Page
4	Reading and Writing 1-2 (Placement Test Score 0-47)	Mon & Tue	3-4	2	J	UMEKAWA Yuko	Check JP course Page
4	Reading and Writing 1-2 (Placement Test Score 0-47)	Tue & Wed	5-6	2	J	MIURA Atsuko	Check JP course Page
4	Reading and Writing 2-2 (Placement Test Score 31-58)	Mon & Thu	5-6	2	J	ENDO Midori	Check JP course Page
4	Reading and Writing 2-2 (Placement Test Score 31-58)	Tue & Fri	5-6	2	J	SATOH Miho	Check JP course Page
4	Media Literacy 1-2 (Placement Test Score 48-68)	Wed	7-8	1	J	KUROKAWA Yumiko	Check JP course Page

About Japanese Language Course

Visit Japanese Language Course web site to see how to
take Placement test and other information.

(English translation follows Japanese)

https://www.ipec.okayama-u.ac.jp/language/japanese/page_628/page_147/

Japanese Language Course Catalog for Term 1 in 2025



Q: I don't like to know more about the course.

A: All the information on the Japanese Language Course is available below. Please be sure to read it before taking the course.

→ https://www.jpcc.okayama-u.ac.jp/language/p_1



Q: What is the Okayama University Japanese Language Course like?

A: The Japanese Language course has seven levels from elementary to advanced. There are integrated classes and skills-based / topic-based classes in the Japanese Language Course. **You can only take Japanese subjects at your level.**

Integrated Classes

The integrated classes meet four days a week. Students learn the four skills (reading, writing, listening and speaking) in an integrated manner through grammar and vocabulary. Students must attend Classes four times a week.



Skill-based and Topic-based Classes

The skill-based and topic-based classes meet 1-2 days a week. Students can select classes according to their interests.

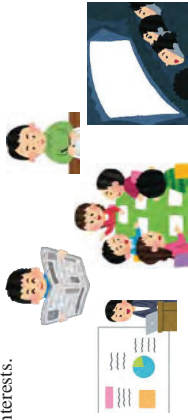

- * **You cannot start to take Integrated Classes from Term 1.**
- * **You can only take Japanese subjects at your level.**

Things to know before attending Class

Graduate students, research students and others

Regular graduate students of Okayama University, Overseas Students, graduate students of other overseas study programs, research students, Teacher Training Students, and Intensive Japanese Language Course Students

Those who have taken Okayama University Japanese Language Course in the past

Those taking Okayama University Japanese Language Course for the first time

Japanese study experience

Japanese study experience

Registration

Take Japanese Placement Test (TTBI)

From Tuesday, April 1 to Friday, April 4, 2025

Register for classes at your Japanese level on the [Japanese Language Course website](#).

* **Registration for Term 1 and Term 2 is to be done together.**

* Those with no Japanese language study experience should register for **Level 1 classes**.

Tuesday, April 8, 2025

Check your Japanese classes on Okayama University Moodle before classes begin

Wednesday April 10, 2025 Term 1 Classes begin. Attend the first class.

[EPOK]



Undergraduate students

P, EPOK, Japanese Studies Students, students of other overseas study programs

Those who have taken Okayama University Japanese Language Course in the past

Those taking Okayama University Japanese Language Course for the first time

Japanese study experience

Japanese study experience

Registration

Take Japanese Placement Test (TTBI)

* **P students take the exam during the period designated by their department.**

Type your test results and your information in the **report form**

During your department's registration period, log in to the [Academic Affairs System](#) and register for classes of your Japanese language level.

* Those with no Japanese language study experience should register for **Level 1 classes**.

Check your Japanese classes on Okayama University Moodle before classes begin.

Wednesday April 10, 2025 Term 1 Classes begin. Attend the first class.



Q: How do I know my Japanese level?

A: Please take the Japanese placement test. The grade in the placement test determines your Japanese level. Please refer to [Japanese Placement Test](#) on the Okayama University Japanese Language Course website. If you have ever taken the Japanese language course, your level is decided by the pass or fail of the Integrated Classes (Japanese language 0-2) you took last time.



Q: Please tell me about the enrollment procedure.

A: The procedure depends on whether you have studied Japanese before and your status at Okayama University. Please refer to [Okayama University Japanese Language Course website](#). If it is difficult to follow the procedures, please attend the Course Registration Consultation.

Course Registration Consultation ※ You need to apply

Date and Time: Friday, April 4, 2025, 10:00-12:00

Place: Room C24, General Education Building C, 2nd Fl, Tsuchima Campus

全学日本語コース 時間割表 - 05年度第1学期-
Japanese language Course (Term 1 and Term in the 05 academic year)

- ◆ 授業は1コマ50分です。全学日本語コースの授業は50分連続2コマで行われます。
- ◆ One class segment is 50 minutes.
- The Japanese Language Course classes are made up of two consecutive 50-minute segments.

レベル1 (e d1)

月 Mon.		火 Tue.		水 Wed.		木 Thu.		金 Fri.	
1	0-30	日本語1 Japanese 1 C24	日本語1 Japanese 1 C24	日本語1 Japanese 1 C24	日本語1 Japanese 1 C24	日本語1 Japanese 1 C24	日本語1 Japanese 1 C24	サバイバル日本語 Survival Japanese ※注意 one	映像で学ぶ日本語1 Japanese through Films 1 B22
3	0-10-30	読み書き1 Reading and Writing 1 C12							
10	5-11-35	読み書き1 Reading and Writing 1 C12							
11	5-1-35								

※サバイバル日本語は、オンラインクラスを予定しています。Survival Japanese will be an online class.

レベル (e d)

月 Mon.		火 Tue.		水 Wed.		木 Thu.		金 Fri.	
1	0-30	日本語2(A) Japanese 2(A) C12	日本語2(B) Japanese 2(B) C12	日本語2(A) Japanese 2(A) C12	日本語2(B) Japanese 2(B) C11	日本語2(A) Japanese 2(A) C12	日本語2(B) Japanese 2(B) C11	日本語2(A) Japanese 2(A) C12	日本語2(B) Japanese 2(B) C12
3	0-10-30	読み書き1 Reading and Writing 1 C12	初級漢字・語彙 Basic Kanji and vocabulary C23		読み書き1 Reading and Writing 1 C12				
10	5-11-35	読み書き1 Reading and Writing 1 C12							
11	5-1-35								
13	5-1-15								
6	1-5-15-15								

※日本語2(A)と日本語2(B)は同じ内容です。どちらか一つ、希望するクラスを選んでください。
Japanese 2(A) and Japanese 2(B) have the same content. Please select either one.

レベル3 (e d3)

月 Mon.		火 Tue.		水 Wed.		木 Thu.		金 Fri.	
1	0-30								映像で学ぶ日本語1 Japanese through Films 1 B22
3	0-10-30								
10	5-11-35	初級漢字・語彙 Basic Kanji and vocabulary C23		日本語3 Japanese 3 C23	日本語3 Japanese 3 C23	日本語3 Japanese 3 C23	日本語3 Japanese 3 C23	日本語3 Japanese 3 C23	日本語3 Japanese 3 C23
11	5-1-35								
5	13-5-1-15	中級文法1 Intermediate grammar 1 C24	読み書き2 Reading and Writing 2 C23						
6	1-5-15-15								

レベル (e e l)

月 Mon.		火 Tue.		水 Wed.		木 Thu.		金 Fri.	
1	0-30								映像で学ぶ日本語1 Japanese through Films 1 B22
3	0-10-30								
10	5-11-35	日本語4 Japanese 4 C24	日本語4 Japanese 4 C24	日本語4 Japanese 4 C24	日本語4 Japanese 4 C24	日本語4 Japanese 4 C24	日本語4 Japanese 4 C24	日本語4 Japanese 4 C24	日本語4 Japanese 4 C24
11	5-1-35	中級文法1 Intermediate grammar 1 C24		中級漢字・語彙 Intermediate Kanji and vocabulary C24		多読で学ぶ日本語1 Extensive Reading 1 C24			
13	5-1-15								
6	1-5-15-15								

レベル5 (e e5)

月 Mon.		火 Tue.		水 Wed.		木 Thu.		金 Fri.	
1	0-30	日本語5 Japanese 5 B22	日本語5 Japanese 5 B22	日本語5 Japanese 5 B22	日本語5 Japanese 5 B22	日本語5 Japanese 5 B22	日本語5 Japanese 5 B22	日本語5 Japanese 5 B22	映像で学ぶ日本語2 Japanese through Films 2 C24
3	0-10-30								
10	5-11-35								
11	5-1-35								
13	5-1-15								
6	1-5-15-15								

レベル6 (e e6)

月 Mon.		火 Tue.		水 Wed.		木 Thu.		金 Fri.	
1	0-30	日本語6 Japanese 6 C23	日本語6 Japanese 6 C23	多読で学ぶ日本語2 Extensive Reading 2 C23	多読で学ぶ日本語2 Extensive Reading 2 C23	日本語6 Japanese 6 C23	日本語6 Japanese 6 C23	日本語6 Japanese 6 C23	映像で学ぶ日本語2 Japanese through Films 2 C24
3	0-10-30								
10	5-11-35								
11	5-1-35								
5	13-5-1-15	メディア・リテラシー2 Media Literacy 2 C23							
6	1-5-15-15								

レベル (e e l)

月 Mon.		火 Tue.		水 Wed.		木 Thu.		金 Fri.	
1	0-30								応用日本語(話すB) Applied Japanese (Speaking B) C11
3	0-10-30								
10	5-11-35	応用日本語(読むA) Applied Japanese (Reading A) C11		多読で学ぶ日本語2 Extensive Reading 2 C23	多読で学ぶ日本語2 Extensive Reading 2 C23	応用日本語(聞くA) Applied Japanese (Listening A) A43	応用日本語(聞くA) Applied Japanese (Listening A) A43	多読で学ぶ日本語2 Extensive Reading 2 C24	多読で学ぶ日本語2 Extensive Reading 2 C24
11	5-1-35								
5	13-5-1-15	メディア・リテラシー2 Media Literacy 2 C23							
6	1-5-15-15								

Registration Forms

▼ Term (1 / 2 / 3 / 4)

	Monday		Tuesday		Wednesday		Thursday		Friday			
	Class Code	Classes	Special Registration	Class Code	Classes	Special Registration	Class Code	Classes	Special Registration	Class Code	Classes	Special Registration
1P & 2P 1P: 8:40-9:30 2P: 9:40-10:30			<input checked="" type="checkbox"/>			<input checked="" type="checkbox"/>						<input checked="" type="checkbox"/>
3P & 4P 3P: 10:40-11:35 4P: 11:40-12:35												
5P & 6P 5P: 13:25-14:15 6P: 14:25-15:15												
7P & 8P 7P: 15:35-16:20 8P: 16:30-17:20												
Others												
Intensive course												

Step2>> Wish to obtain "EPOK Certificate of Study Japan"? Yes No **Please check in either** **if yes , you must fulfill the following requirements: check your credit count.**

Step3>> Check your Credit Count (Term / Semester Total) **All students need to fill in the following table for credit counts regardless of EPOK Certificate.**

Course Category	Term-1or3	Term-2or4	Semester TOTAL Credits	Credit Required for the Certificate (Semester TOTAL)
	Japanese Language			0
EPOK Research Project			0	Mandatory for the Certificate (1-year student) If taking in the other Semester Check Here <input type="checkbox"/>
Others			0	2 Credits or above
TOTAL			0	15 Credits or above

➤ Registration: Due (JST)

NAME:

Student Number: 67N

Do not forget to write your Name and Student No.

I) Special Registration CHA GE

(Online registration via Academic Affairs system is NOT available
Need a special request for the registration to the EPOK Office)

ADD: Term- (1 2 3 4)

Class Code	Course title

DELETE: Term- (1 2 3 4)

Class Code	Course title

(Office Check)

II) My Course Schedule (Final)

▼ Term- (1 2 3 4)

Step1 > Course Schedule

	Monday		Tuesday		Wednesday		Thursday		Friday	
	Class Code	Class Code Special Registration	Classes	Class Code Special Registration	Classes	Class Code	Classes	Class Code	Classes	Class Code Special Registration
1P & 2P		✓		✓						✓
1P: 8:40-9:30										
2P: 9:40-10:30										
3P & 4P										
3P: 10:40-11:35										
4P: 11:40-12:35										
5P & 6P										
5P: 13:25-14:15										
6P: 14:25-15:15										
7P & 8P										
7P: 15:30-16:20										
8P: 16:30-										
Others										
Intensive course										

▼ Term (1 2 3 4)

Your Course Schedule

	Monday		Tuesday		Wednesday		Thursday		Friday	
	Class Code	Class Code Special Registration	Classes	Class Code Special Registration	Classes	Class Code	Classes	Class Code	Classes	Class Code Special Registration
1P & 2P		✓		✓						✓
1P: 8:40-9:30										
2P: 9:40-10:30										
3P & 4P										
3P: 10:40-11:35										
4P: 11:40-12:35										
5P & 6P										
5P: 13:25-14:15										
6P: 14:25-15:15										
7P & 8P										
7P: 15:30-16:20										
8P: 16:30-										
Others										
Intensive course										

Step2 > Wish to obtain EPOK Certificate of Study Japan

Please put ✓ in either

If yes, please refer to the following requirements when checking your credit count.

All students need to fill in blue parts of the following table regardless of EPOK Certificate

Step3 > Check your Credit Count (Term Semester Total)

Course Category	Term-1or3	Term-2or4	Semester TOTAL Credits	Credit Required for the Certificate (Semester TOTAL)
Japanese Language			04 Credits or above	04 Credits or above
EPOK Research Project			0	Mandatory for the Certificate If taking in the other Semester (1-year student) Check Here <input type="checkbox"/>
Others			02 Credits or above	02 Credits or above
TOTAL				015 Credits or above

Floor Map

Building for General Education 1F, (Wing A, Wing B, Wing C)



一般教育棟 2階 (A・B・C棟)

Building for General Education 2F, (Wing A, Wing B, Wing C)

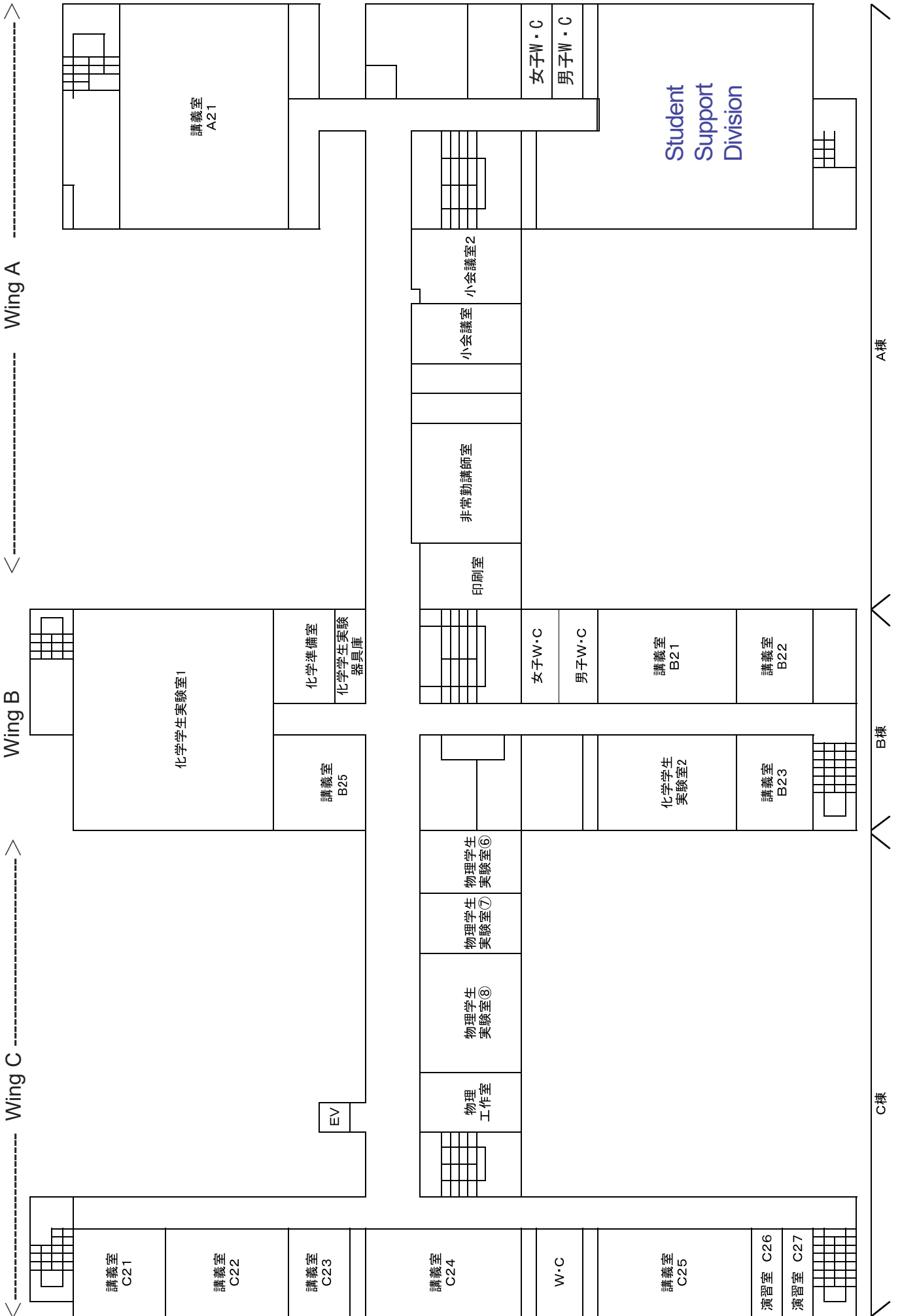

一般教育棟 3階 (A・B・C棟)

Building for General Education 3F, (Wing A, Wing B, Wing C)

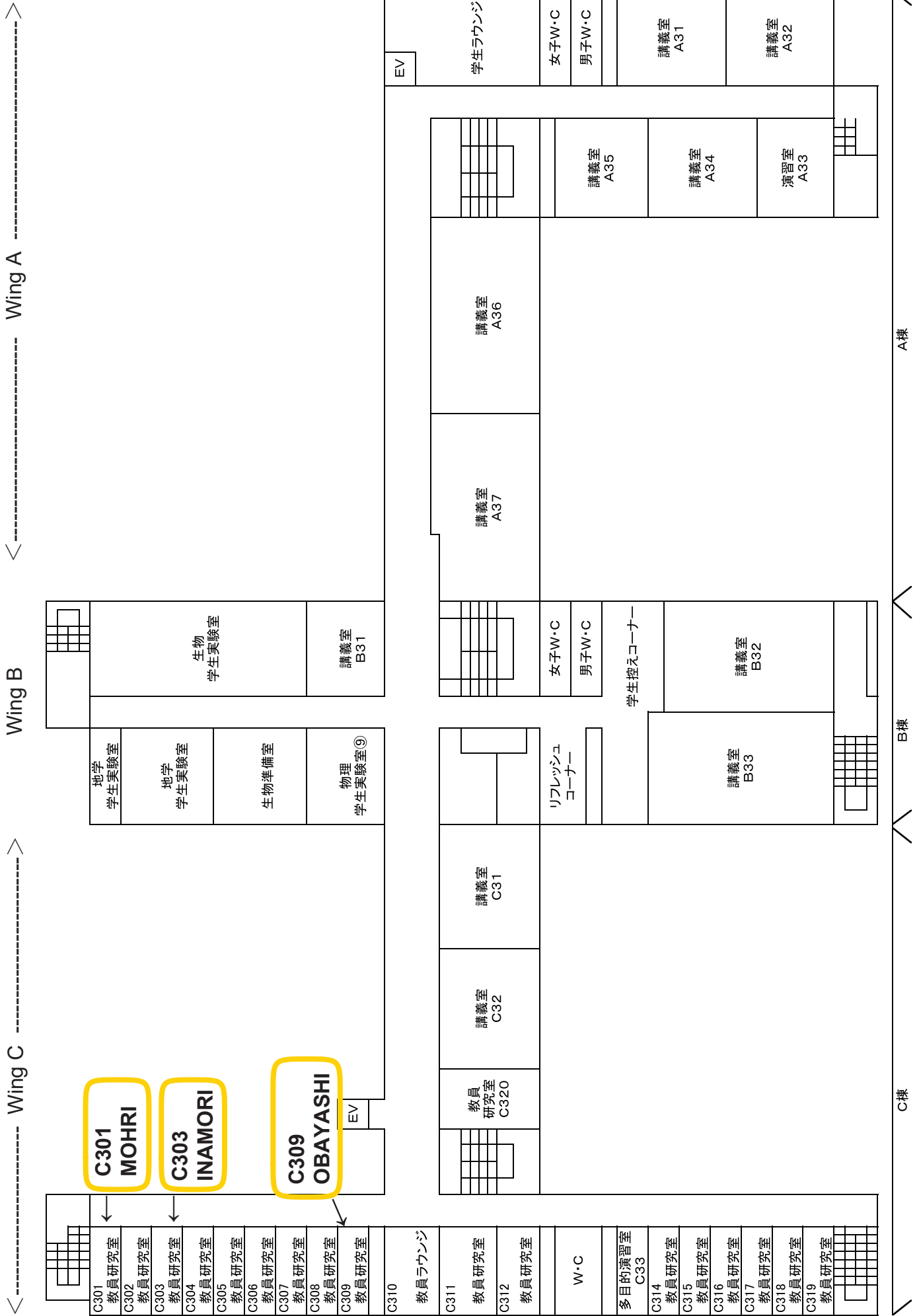

一般教育棟 4階(A棟, B棟, C棟)

Building for General Education 4F, (Wing A, Wing B, Wing C)

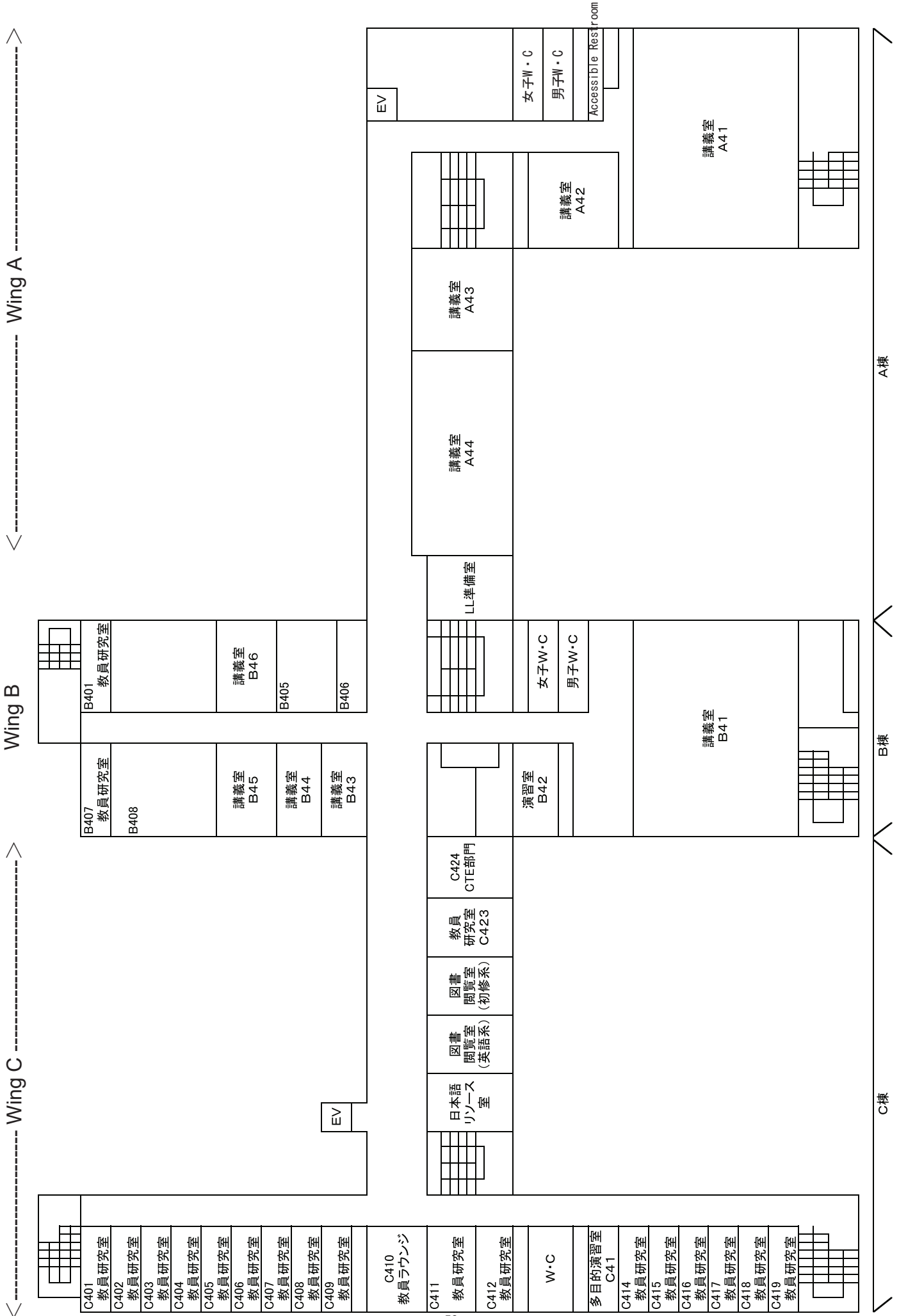

一般教育棟 1～2階 (D・E棟)

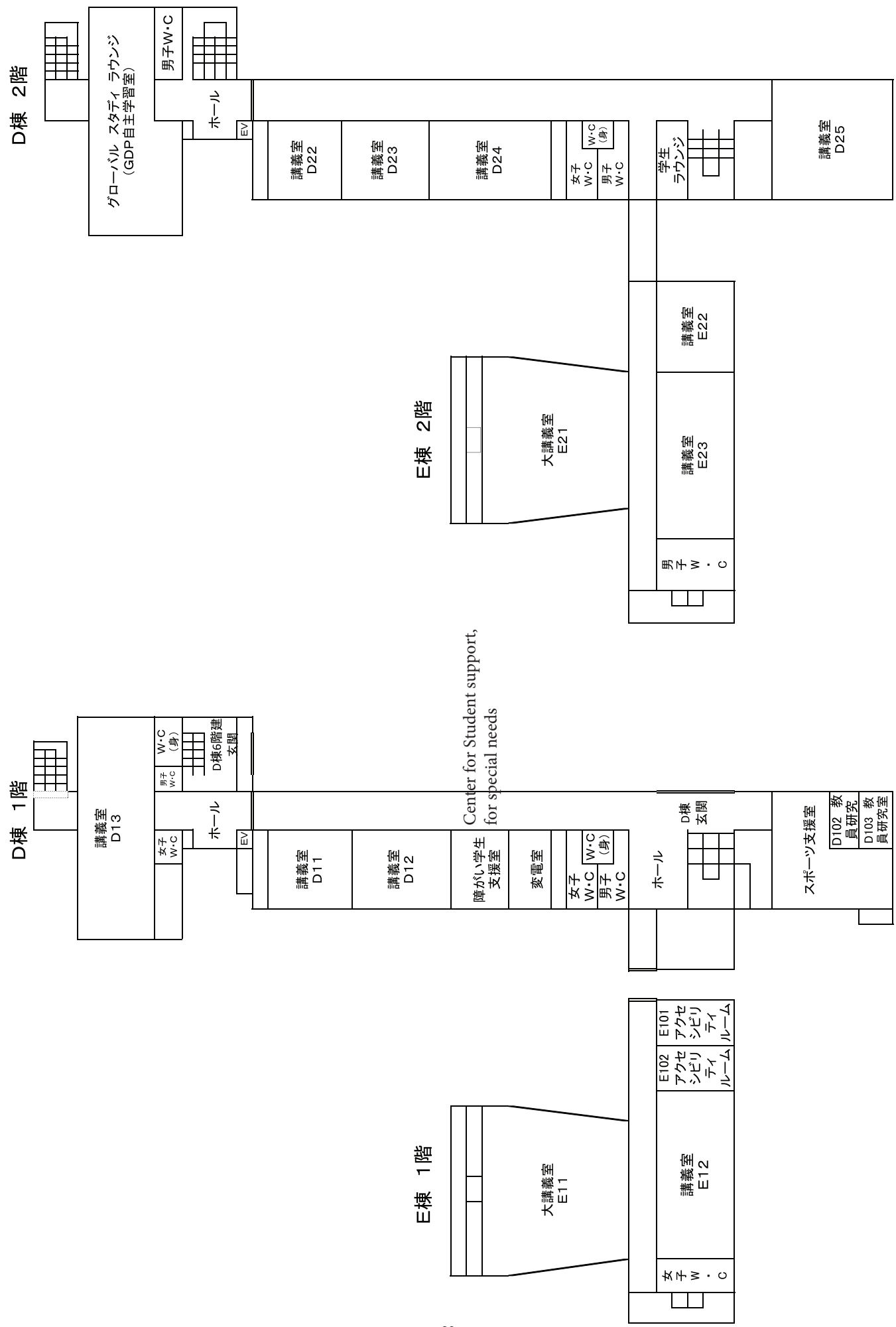

一般教育棟 3～4階 (D・E棟)

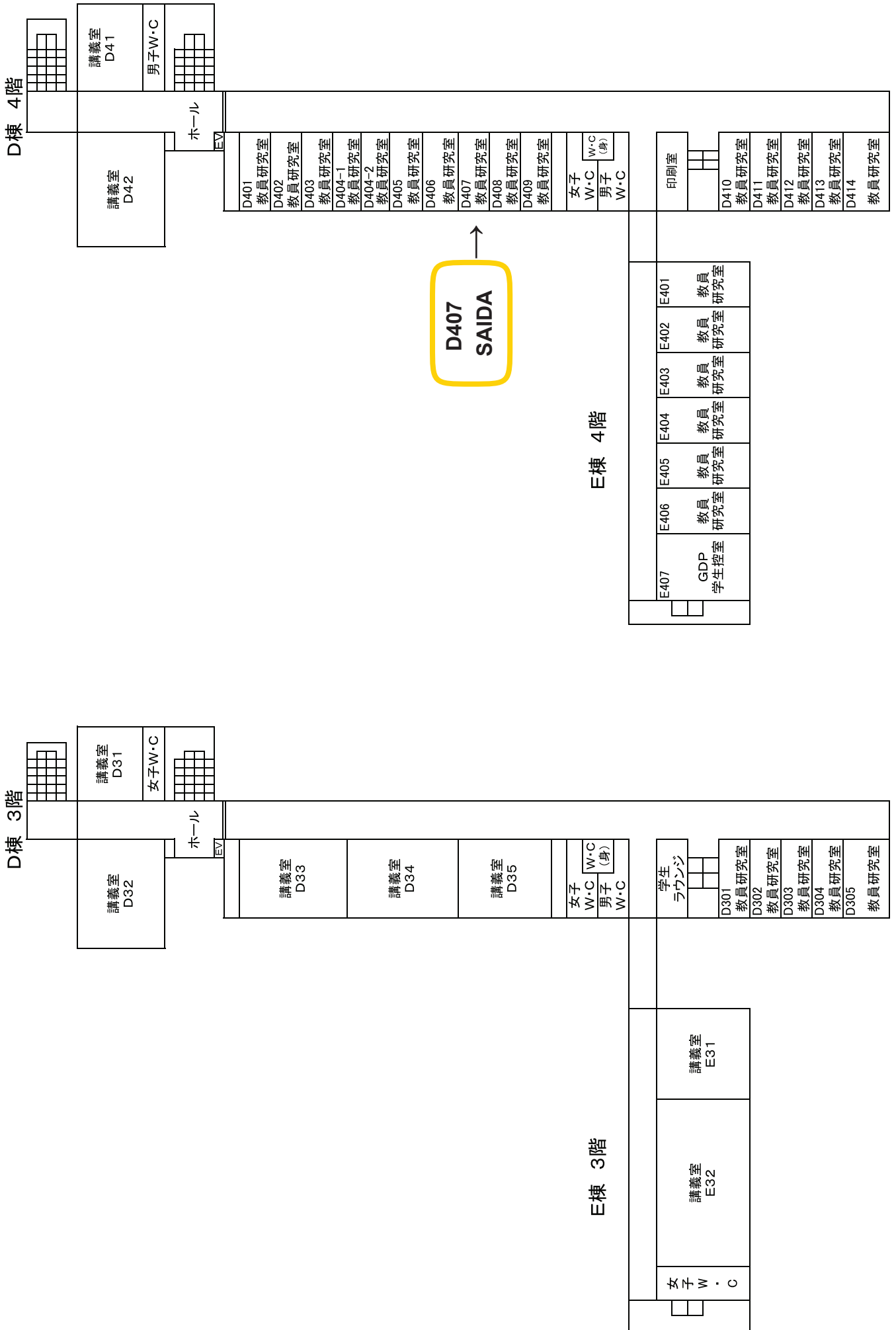

一般教育棟 5～6階 (D・E棟)

D棟 5階

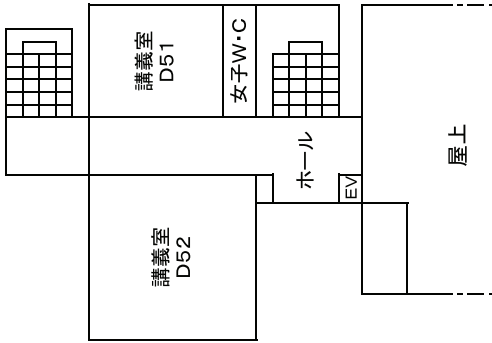

D棟 6階

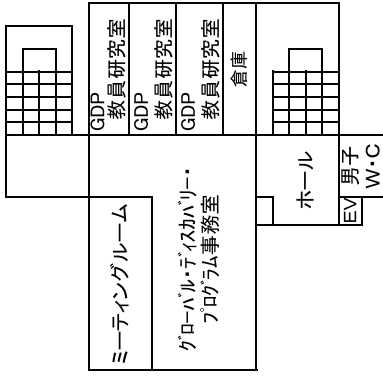

For further information please contact
Institute of Global Human Resource Development
EPOK Academic Director

EPOK Coordinator

*Saida KHALMIRZAEVA (Associate Professor)
pu6h2ipe@okayama-u.ac.jp

*Junko OBAYASHI (Associate Professor)
j.obayashi@okayama-u.ac.jp

*Takao I AMORI (Associate Professor)
takaoinamori@okayama-u.ac.jp

*Takami MOHRI (Associate Professor)
tmohri@okayama-u.ac.jp

EPOK Program Administrative Office
epok-inbound1@adm.okayama-u.ac.jp

**Institute of Global Human Resource
Development
Okayama University**

**1F, Wing C, Building for General Education,
2-1-1 Tsushima-naka Kita-ku, Okayama 700-8530**

TEL: +81 (0)86 251-7051

Email: epok-inbound1@adm.okayama-u.ac.jp

Website: <https://intl.okayama-u.ac.jp/en/inbound/programs/epok/>